





Dovedale Crescent, Belper, Derbyshire DE56 1HL
£450,000 - Freehold



PROPERTY DESCRIPTION

*****GUIDE PRICE £450,000 - £475,000 *****

****Stunning Family Home in the Heart of Belper****

Welcome to your dream family home! Nestled in a tranquil location in the picturesque town of Belper, this stunning extended property offers everything you need for modern family living. With four spacious bedrooms and an inviting open-plan living kitchen, this home is designed for both comfort and style.

As you step inside, you'll be greeted by a bright and airy atmosphere that flows seamlessly throughout. The heart of the home is undoubtedly the contemporary kitchen, featuring sleek Quartz worktops and a walk in larder that make cooking a delight. This space effortlessly connects to the generous living area, perfect for hosting family gatherings or simply relaxing after a long day.

For those with little ones or teenagers, the dedicated playroom provides an ideal retreat where creativity can flourish. Imagine watching your children enjoy their favourite activities while you unwind nearby — this versatile space truly caters to every family's needs.

Outside, you'll find a large driveway offering ample parking for multiple vehicles, ensuring convenience for busy mornings or entertaining guests. The quiet surroundings create a peaceful oasis where you can escape from the hustle and bustle of everyday life while still being within easy reach of local amenities.

With modern decor throughout, this property exudes warmth and sophistication — it's ready for you to move in and make it your own!

Don't miss out on this exceptional opportunity to secure a family-friendly haven in Belper. Schedule your viewing today and experience first-hand what makes this house truly special!

POINTS OF INTEREST

- Extended and Improved throughout
- 4 bed Detached home
- Dressing room & En-Suite to master
- Driveway
- Quality fitted kitchen
- Quiet location
- Open plan living kitchen

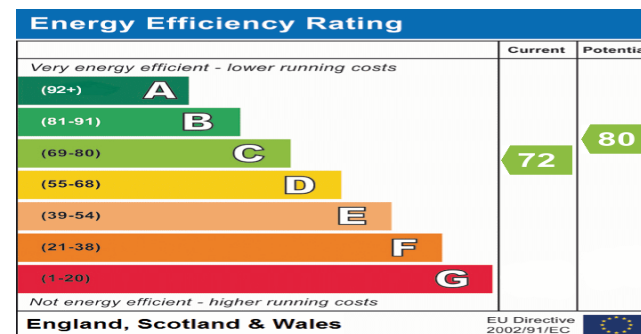

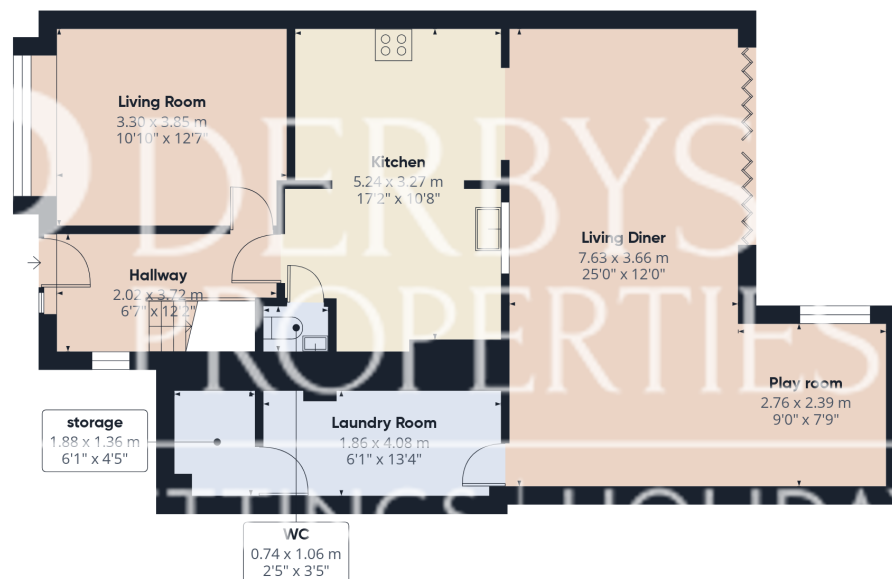

Ground Floor

Approximate total area⁽¹⁾

157.1 m²

1692 ft²

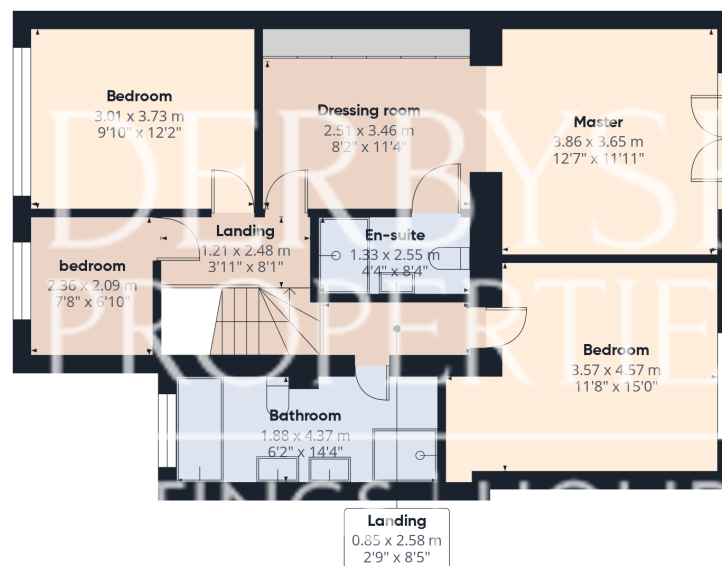

Floor 1

(1) Excluding balconies and terraces

While every attempt has been made to ensure accuracy, all measurements are approximate, not to scale. This floor plan is for illustrative purposes only.

Calculations are based on RICS IPMS 3C standard.

GIRAFFE360