



The Westbury, Holden Road, Woodside Park, N12

£550,000



The Westbury, Holden Road, Woodside Park, N12

Positioned on the second floor of a prestigious development, is this impressive two bedroom apartment benefiting from in excess of 800 Sq Ft (74 Sq M) of internal space including a stunning 28ft open plan kitchen/reception room area which offers access to a delightful balcony.

This flat further features a spacious principal bedroom with ample storage, a second bedroom with ample storage, a modern fully fitted kitchen with dining space and a large contemporary bathroom.

The Westbury is renowned for its impressive communal areas, lift access, and beautifully maintained gardens. Ideally located just 0.3 miles from Woodside Park Underground Station (Northern Line), this apartment makes an ideal first-time purchase, investment, or downsize option.

Please note that we have been advised of the following:

Lease – Circa 144 years remaining
Service charge - Circa 2,838.92
Ground rent - Circa £350 per annum

Features

- Modern Development
- Two Bedrooms
- Second Floor
- Large Kitchen
- Beautifully Presented
- Generously Proportioned
- Allocated Parking Space
- Contemporary Bathroom
- Large Kitchen Within Dining space
- Close To Woodside Park Station



The Westbury,
Holden Road,
Woodside Park, N12

Westbury, Holden Road, N12

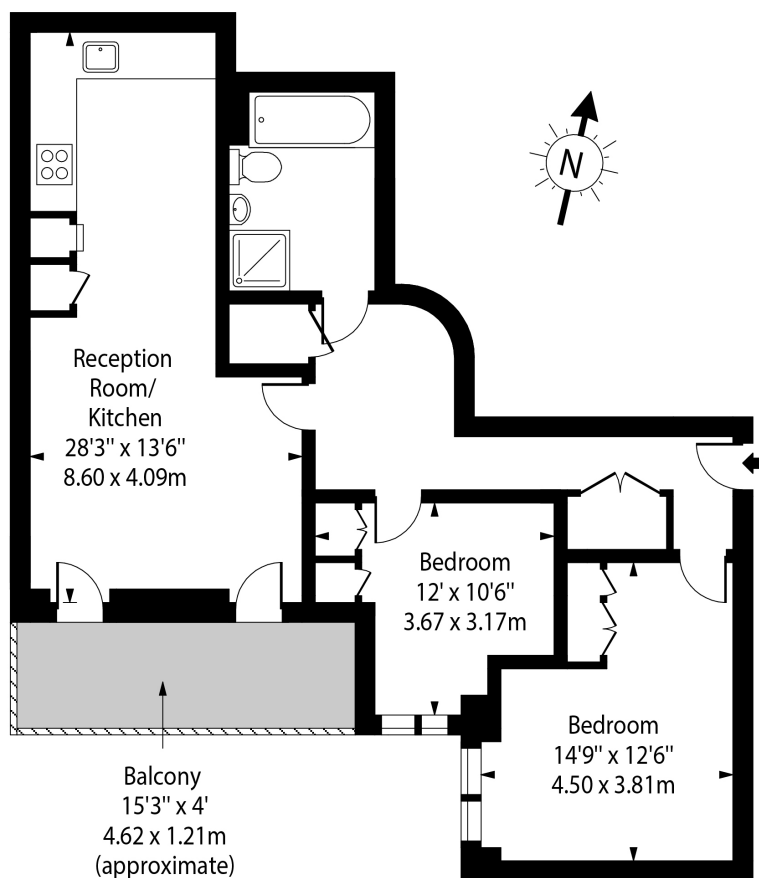

Second Floor

Approx Gross Internal Area 804 Sq Ft - 74.67 Sq M

For Illustration Purposes Only - Not To Scale Floor Plan by www.nogaphotostudio.com Ref: No.53365

This floor plan should be used as a general outline for guidance only. Any intending purchaser or lessee should satisfy themselves by inspection, searches, enquiries and full survey as to the correctness of each statement. Any areas, measurements or distances quoted are approximate and should not be used to value a property or be the basis of any sale or let.