



Two Bedroom Terraced House
Stopford Road, Gillingham, Kent, ME7 4NQ

Guide Price £210,000
Freehold

Stopford Road, Gillingham, Kent, ME7 4NQ

Guide Price £210,000

Freehold

Description

Guide Price £210,000-£230,000. This charming two-bedroom Victorian terrace is an opportunity not to be missed! Chain-free and beautifully maintained, this property is ready for you to move straight in and start enjoying its many features. As you step inside, you'll be greeted by a welcoming lounge, boasting natural décor and wooden flooring that seamlessly flows into the dining room. The dining area, bathed in natural light from the French doors, opens up to a South-East facing rear garden, creating a bright and airy atmosphere perfect for relaxing or entertaining. The garden itself is a real highlight, featuring a spacious patio for those lovely summer evenings, and a well-maintained lawn, ideal for family gatherings or a quiet retreat. The kitchen is thoughtfully designed with a variety of white fitted units and stylish wood effect work surfaces, complemented by a four-ring gas hob and electric oven, making it a joy to prepare meals in this space. Additionally, the property includes a versatile basement, perfect for storage or converting into an extra reception room to suit your needs. Upstairs, you'll find two generously sized double bedrooms, offering ample space and comfort. The modern family bathroom is spacious and well-appointed, featuring a shower over the bath.

This property truly has it all, style, space, and an unbeatable location. With its large garden, and move-in ready condition, this Victorian gem is perfect for anyone looking for a hassle-free move into a beautifully maintained home. Don't let this fantastic opportunity pass you by! Contact the Greyfox Sales team in Rainham today to book your viewing and take the first step toward making this charming property your new home.

Key Features

- Chain Free
- Perfect First Time Purchase or Potential Investment Property
- Two Generous Double Bedrooms
- Two Spacious Reception Rooms
- Versatile Basement
- Close To Medway Maritime Hospital & Gillingham Town Centre
- Great Access To Motorway Links & Public Transport
- South Easterly Facing Rear Garden measuring approx 88 x 13ft

Local Area

Gillingham is located within the Medway towns and offers railway links to central London and Ebbsfleet International and road connections to the A2/M2, M25 and M20. In addition to its town centre Gillingham offers a host of amenities including ice skating, country parks, an outdoor pool, a golf course, Medway Park Sports Centre and more.

BASEMENT
154 sq.ft. (14.3 sq.m.) approx.

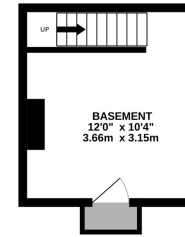

GROUND FLOOR
374 sq.ft. (34.7 sq.m.) approx.

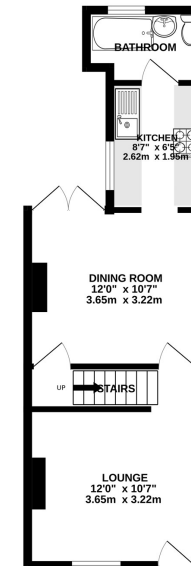

1ST FLOOR
279 sq.ft. (25.9 sq.m.) approx.

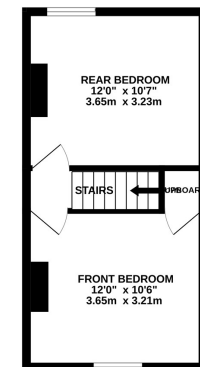

TOTAL FLOOR AREA : 807 sq.ft. (75.0 sq.m.) approx.

Whilst every attempt has been made to ensure the accuracy of the floorplan contained here, measurements of doors, windows, rooms and any other items are approximate and no responsibility is taken for any error, omission or mis-statement. This plan is for illustrative purposes only and should be used as such by any prospective purchaser. The services, systems and appliances shown have not been tested and no guarantee as to their operability or efficiency can be given.

Made with Metropix ©2023



Property Location

Stopford Road, Gillingham, Kent, ME7 4NQ

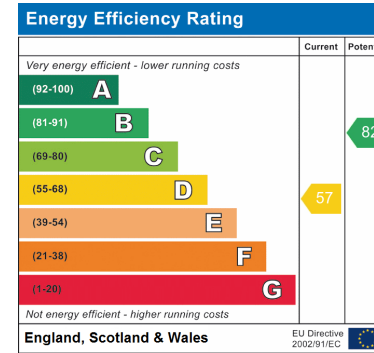
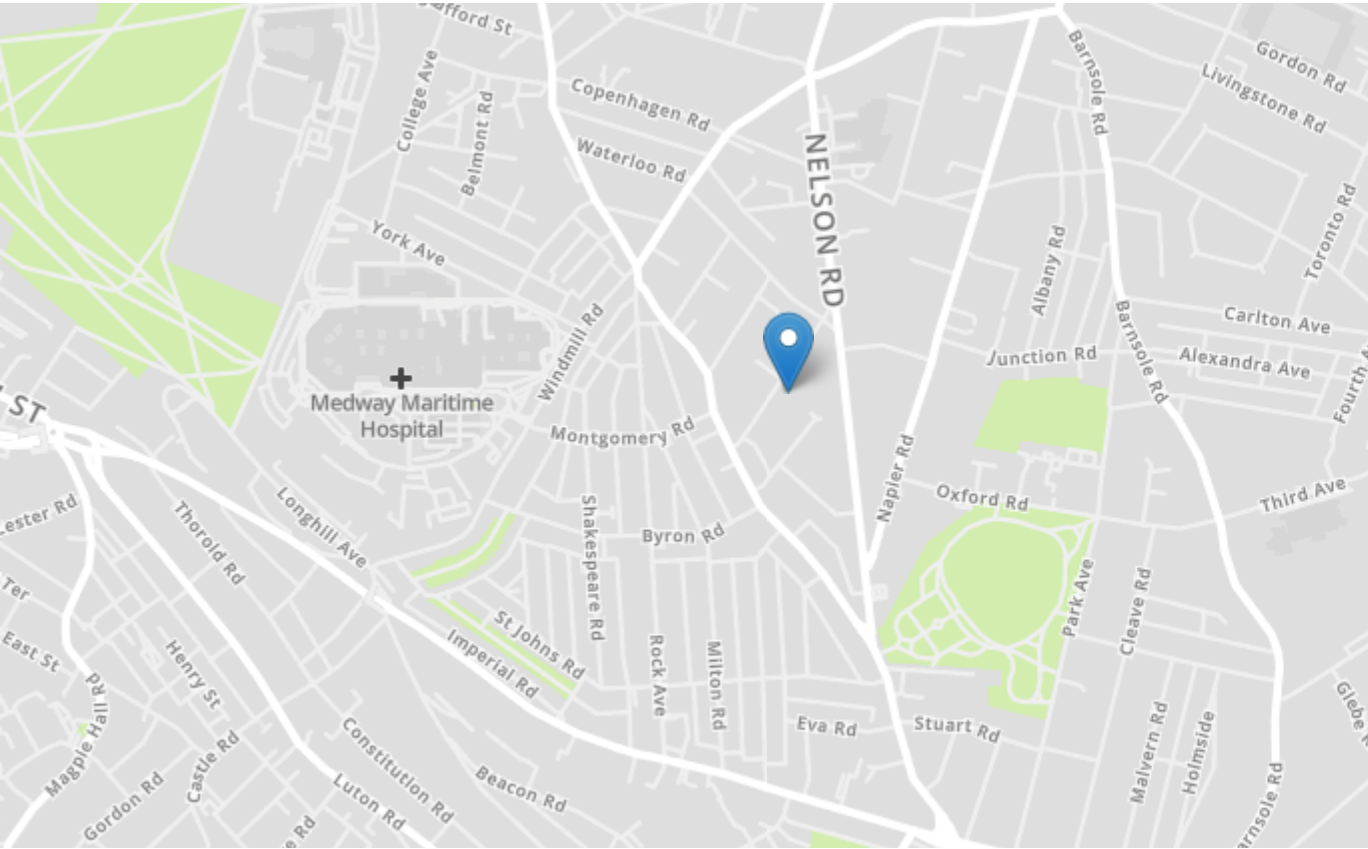

Tenure	Freehold
Lease Term	N/A
Ground Rent	N/A
Service Charge	N/A
Local Authority	Medway
Council Tax	Band B

Greyfox Walderslade

Unit 2, Thetford House
Walderslade Village Centre
Walderslade Road
Chatham
Kent
ME5 9LR
Tel: 01634 672227 Email:
walderslade@greyfox.co.uk

Greyfox Rainham

67C High Street
Rainham
Kent
ME8 7HS
Tel: 01634 377737 Email:
rainham@greyfox.co.uk

Agent Notes

These particulars are prepared as a general guide to a broad description of the property and should not be relied upon as a statement or representation of fact and do not constitute part of an offer or contract. The seller does not make or give nor do our employees or Greyfox have authority to make or give any representation or warranty to the property. We have not carried out a structural survey and the services, appliances and specific fittings have not been tested. All photographs, measurements, floorplans and distances referred to are given as a guide only and should not be relied upon for the purchase of carpets or any other fixtures or fittings. Lease details, service charges and ground rent (where applicable) and council tax are given as a guide only and should be checked and confirmed by you on inspection and your solicitor prior to exchange of contracts. If there are any points of particular importance to you we will be pleased to check the information for you and to confirm that the property remains available. This is particularly important should you be travelling some distance to view and where statements have been made by us to the effect that the information has not been verified. The copyright of all details, photographs and floorplans remain exclusive to Greyfox. For details of our privacy policy and referral fee arrangements with any of our selected partner companies please visit <https://www.greyfox.co.uk/legal/privacy> and <https://www.greyfox.co.uk/referral-fees>.