



Alford Court Flat 20, Harthill Close £130,000

Northwich CW9 8UY

www.westates.co.uk

01606 331784



A well presented and well-proportioned two bedroom first floor apartment.

- First Floor Apartment
- Large Lounge Dining Room
- Fitted Kitchen
- Two Bedrooms
- Upgraded Bathroom
- Allocated Parking Space

Description

An immaculately presented first floor apartment with electric night storage and electric wall heaters. PVCu double glazed windows. Secure intercom controlled entrance, entrance hall, large lounge dining room, fitted and equipped kitchen, two bedrooms, one with a freestanding wardrobe and an upgraded bathroom. Externally there are communal gardens and grounds along with one allocated parking space and several other communal visitor parking spaces.



Location

The property is situated on the popular Kingsmead development, itself located on the south side of Northwich. Local amenities are well catered for with a good selection of shops and other facilities available at the Kingsmead local centre, which is also home to the very popular Kingfisher Public House. Two railways serve the area with the West Coast Main Line service running through Hartford, enabling access to London within two hours. Trains to Manchester and Chester run from Greenbank or Northwich station. The nearby A556 easily facilitates access to the region's major road network with Manchester and Liverpool airports both within 20 miles. Above all, where Northwich really excels is its range of excellent schools. Kingsmead has its own very well regarded and Ofsted rated 'Outstanding' primary school and The County High School Leftwich, which is also rated Outstanding by Ofsted is within walking distance. Nearby Northwich caters for a more comprehensive range of amenities, including leading supermarkets with Waitrose, Sainsbury's and Tesco all represented.

Tenure

LEASEHOLD

EPC Rating:



First Floor

Approx. 54.5 sq. metres (586.3 sq. feet)

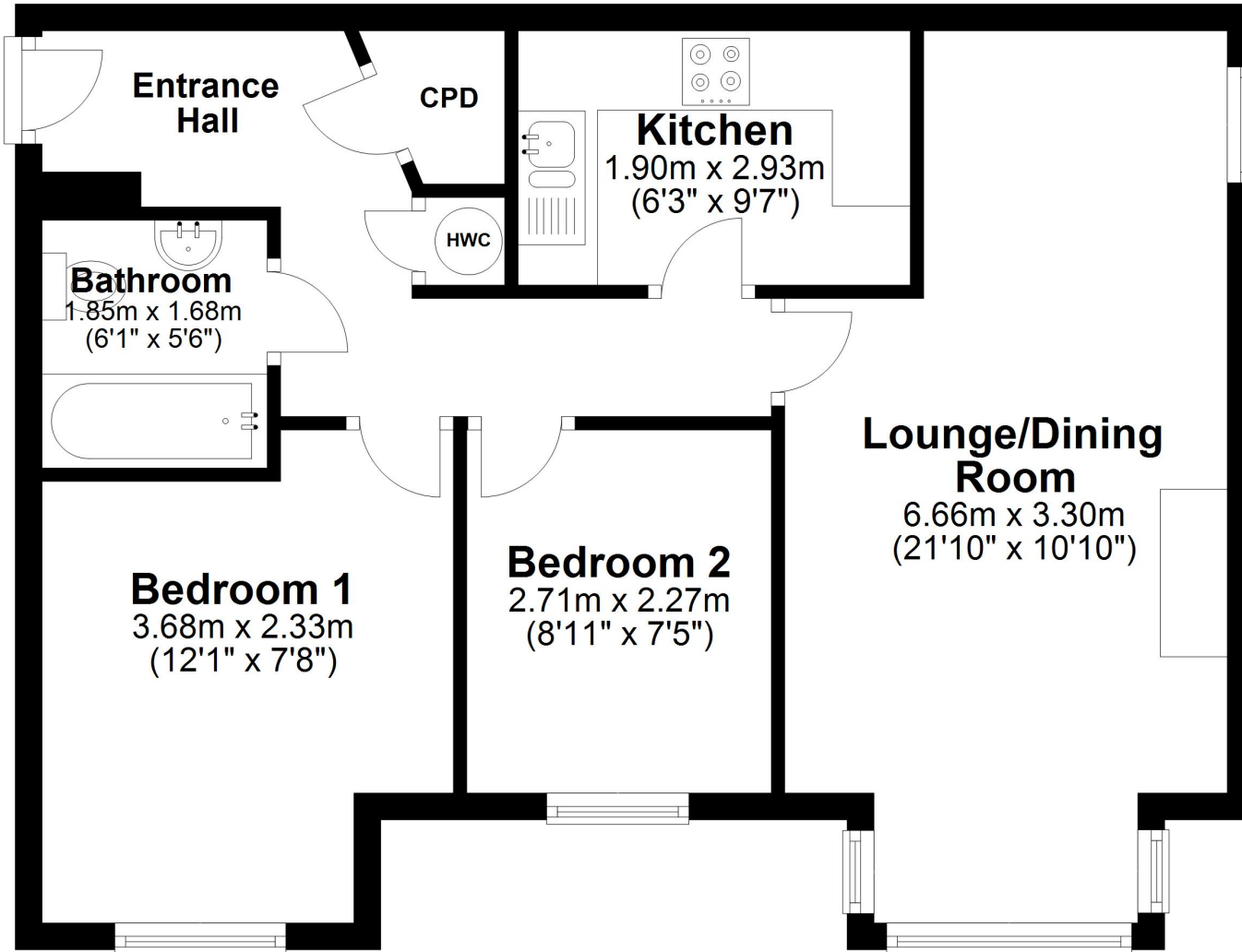

Total area: approx. 54.5 sq. metres (586.3 sq. feet)

