

FOR
SALE



12 Woodfield Close, Kingstone, Hereford HR2 9FB

£254,000 - Freehold

22, Broad Street, Hereford, HR4 9AP 01432 355455 hereford@flintandcook.co.uk

PROPERTY SUMMARY

Peacefully situated in this popular village location, a deceptively spacious 3 bedroom, 3 storey semi detached house offering ideal family accommodation. The property has the added benefit of gas central heating, double glazing, impressive open-plan living room/kitchen, 3 good sized bedrooms, garage and driveway and to fully appreciate this property we strongly recommend an internal inspection.

POINTS OF INTEREST

- *Popular village location*
- *Deceptively spacious 3 storey semi-detached house*
- *Impressive open-plan Living Room/Kitchen*
- *3 Good size bedrooms*
- *Garage & double width driveway*
- *Ideal family home*



ROOM DESCRIPTIONS

Canopy Porch

With partially double glazed entrance door through to the

Open-Plan Kitchen/Living Area

Kitchen Area with 1 1/2 bowl sink unit with mixer tap over, a range of wall and base cabinets, ample work surfaces/breakfast bar with tiled splash backs, double glazed window to the front aspect, recessed spotlighting, feature flooring, carpeted staircase to the first floor, radiator, central heating thermostat, free standing slimline dishwasher, free standing upright fridge/freezer, built in single oven and 4 ring gas hob with cooker hood over.

Living Area - with feature flooring, double radiator, useful store cupboard and double glazed sliding door to the

Conservatory

A brick and uPVC construction with tiled floor, wall mounted electric heaters, power and light points, window blinds, double doors to the rear garden and internal door to the garage.

Cloakroom

With low flush WC, wash hand basin with tiled splash back, double glazed window with blind, radiator and feature flooring.

First Floor Landing

With fitted carpet and doors to bedrooms and bathroom. A carpeted stair then leads up to

Bedroom 2

An L-shaped room with fitted carpet, radiator 2 double glazed windows to the front aspect enjoying a pleasant outlook.

Bedroom 3

With fitted carpet, radiator and a double glazed window to the rear.

Bathroom

With suite comprising a panelled bath with shower unit over, pedestal wash hand basin with shaver socket over, low flush WC, double glazed window with blind, ladder style radiator/towel rail, mirror fronted cabinet, recessed spotlighting and extractor fan.

Top Floor - Bedroom 1

A light and airy room with fitted carpet, 2 radiators, access hatch to loft storage space, double glazed windows to front aspect enjoying a pleasant outlook, 2 Velux roof lights to the rear with pull down blinds, 2 fitted wardrobes and a further large storage cupboard. The ample space in this room provides the potential for creating an ensuite bathroom if desired.

Outside

To the front of the property there is a small lawned garden with steps leading to the front entrance door. To the rear is a paved patio area leading onto the main garden which is laid to lawn and is bordered by flowers and shrubs and enclosed by high fencing and walling to maintain privacy. There is also a side gate leading to the large driveway providing ample off road parking and access to the

Garage

With up and over door, power and light points and ample storage.

Services

Mains water, electricity, drainage and gas are connected. Gas-fired central heating.

Outgoings

Council tax band C - £2,071 payable for 2024/2025

Water and drainage rates are payable.

Directions

Proceed south out of Hereford city on the A465 Abergavenny/Belmont Road, turn right taking the turn towards Clehonger and follow the signs for Kingstone. On entering the village of Kingstone take the first turning left proceeding through the village and Woodfield Close is on the right hand side.

Viewings

Strictly by appointment through the Agent, Flint & Cook, Hereford (01432) 355455.

Opening Hours

Monday - Friday 9.00 am - 5.30 pm

Saturday 9.00 am - 1.00 pm

Money Laundering Regulations

Prospective purchasers will be asked to produce identification, address verification and proof of funds at the time of making an offer.

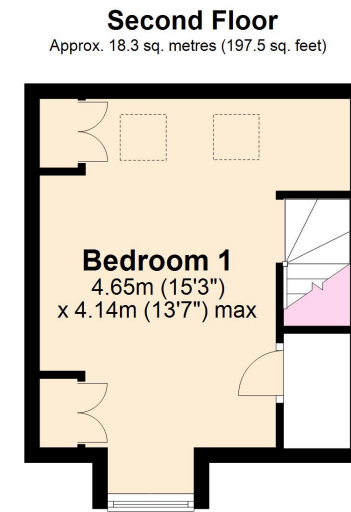
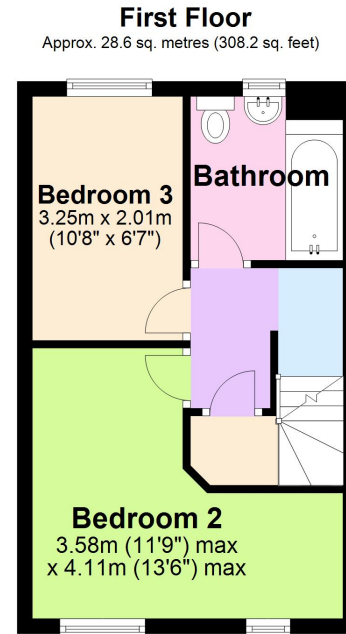
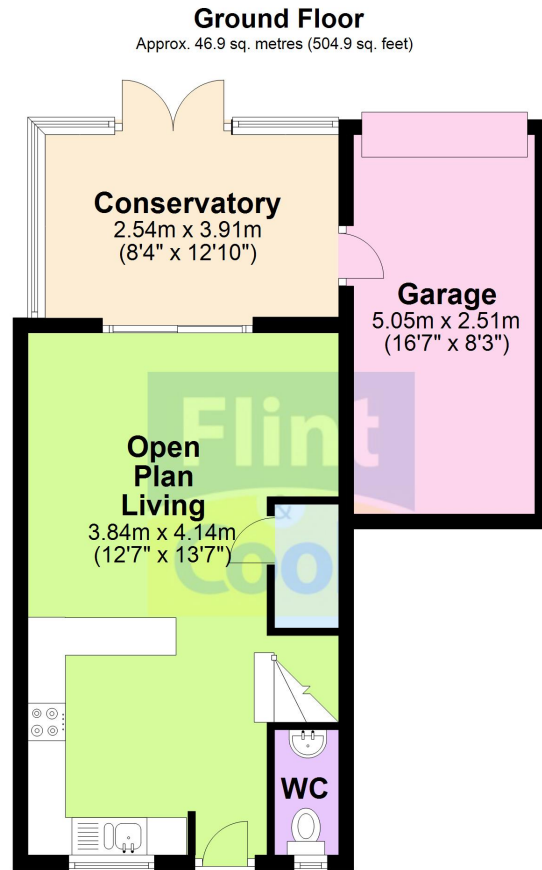

Total area: approx. 93.9 sq. metres (1010.5 sq. feet)

This plan is for illustrative purposes only
Plan produced using PlanUp.

These particulars are prepared for the guidance only of prospective purchasers. They are intended to give a fair and overall description of the property and do not constitute the whole or any part of an offer or contract. Any information contained herein (whether in text, plans or photographs) is given in good faith but should not be relied upon as being a statement or representation of fact. Any plans provided by the agents and/or with the sales particulars are intended for guidance purposes only; we cannot guarantee the accuracy and scale of any plans, and they do not form any part of the sales contract. Nothing in these particulars shall be deemed to be a statement that the property is in good condition or otherwise nor that any services or facilities are in good working order. Any movable contents, fixtures and fittings, (whether wired or not) referred to in these property particulars (including any shown in the photographs) are, unless the particulars say otherwise, excluded from the sale. In the event that the buyer proposes to purchase any movable contents or include them in any offer for the property, the buyer cannot in any respect imply any such inclusion from the property particulars. Any areas, measurements or distances referred to herein are approximate only and may be subject to amendment. It should not be assumed that the property has all necessary planning, building regulation or other consents and these matters must be verified by an intending purchaser. The information in these particulars is given without responsibility on the part of the agents or their clients and neither the agents nor their employees have any authority to make or give any representations or warranties whatever in relation to this property.

Flint & Cook Privacy Statement: We take your privacy very seriously. Your data will not be shared with any other parties without your express permission. Our Data protection Policy can be read in full on the Flint & Cook website, www.flintandcook.co.uk

Energy Efficiency Rating		
	Current	Potential
Very energy efficient - lower running costs		
(92+) A		89
(81-91) B		
(69-80) C	77	
(55-68) D		
(39-54) E		
(21-38) F		
(1-20) G		
Not energy efficient - higher running costs		
England, Scotland & Wales		
		EU Directive 2002/91/EC