

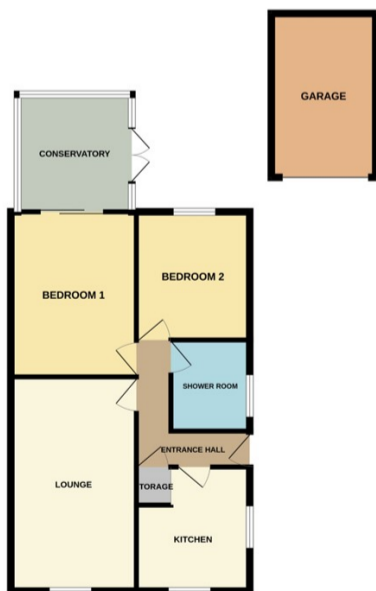

Bourne

£235,000



*****POPULAR LOCATION***** Rosedale are delighted to offer this detached bungalow within easy access to local shops and amenities. The property is being sold with no onward chain and is ready to move into. There is a UPVC conservatory, two bedrooms, lounge, kitchen, shower room and a well maintained rear garden. There is also a driveway leading to a single garage and off road parking. To fully appreciate this bungalow viewings are highly recommended. EPC Energy Rating D. Council Tax Band B.