

The logo for 'chill' is displayed in white lowercase letters on a dark blue background. The letter 'i' is stylized with a blue dot and a blue vertical line.

Guide Price
£550,000

Thorn Road, Worthing, BN11

Maisonette 1687 sq. ft 5 Bedrooms 2 Bathrooms

Freehold



A charming and spacious four/five double bedroom family home, full of character and warmth, ideally positioned on the corner of Thorn Road and Milton Street—just a short stroll from the beach. Offering deceptively generous living space and available with no onward chain.

- Just moments from the seafront
- Large corner plot house
- four / five bedrooms
- Being sold with no onward chain
- Period features throughout
- Close to Worthing town centre



Russell Chilvers

01273 569 233

Russell@chillhomes.co.uk

3/48 Rochester House,
Rochester Gardens,
Hove, BN3 3AW



Thorn Road

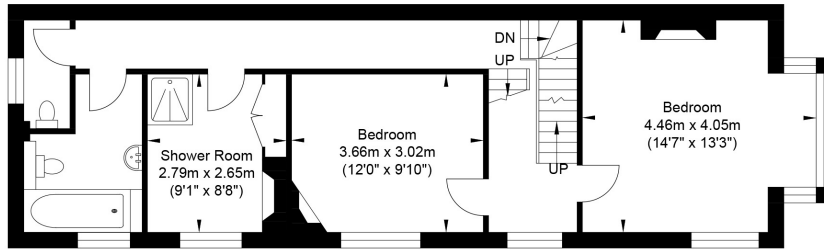

First Floor
Approximate Floor Area
640.56 sq ft
(59.51 sq m)

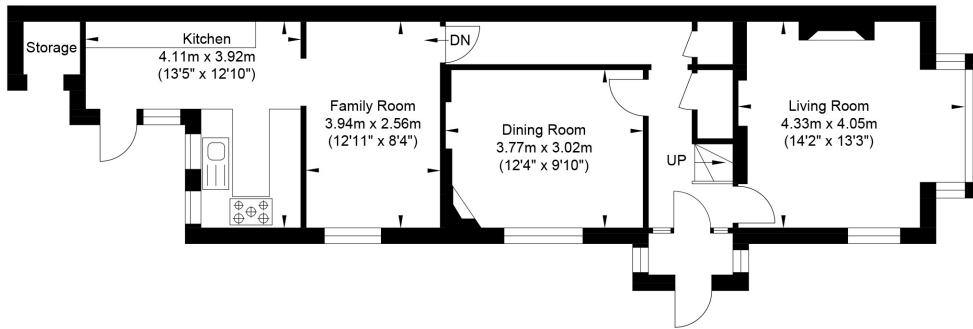

Ground Floor
Approximate Floor Area
670.05 sq ft
(62.25 sq m)

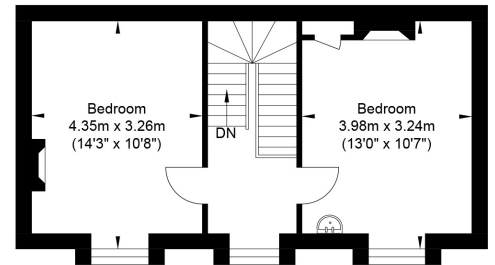

Second Floor
Approximate Floor Area
376.84 sq ft
(35.01 sq m)



Approximate Gross Internal Area = 156.77 sq m / 1687.45 sq ft
Illustration for identification purposed only, measurements are approximate, not to scale.



Russell Chilvers



01273 569 233



Russell@chillhomes.co.uk

3/48 Rochester House,
Rochester Gardens,
Hove, BN3 3AW

