



7 Coachmans Lodge, 24-26 Friern Park North Finchley, , N12 9DN

- Two Bedrooms
- Reception
- Kitchen
- Off-Street Parking
- Council Tax band E
- Service Charge £2217 p.a.
- Ground Rent £225 p.a.
- Chain Free
- Woodside Park Tube - 0.6miles
- Two Bathrooms (One en suite)



PROPERTY DESCRIPTION

A two bedroom, two bathroom (one en-suite) first floor apartment set within a contemporary purpose-built complex. The property is conveniently situated at the High Road end of Friern Park close to North Finchley's shopping and transport amenities, with Woodside Park (Northern Line) underground station just 0.6 miles away. Off-street parking is available at the rear and the property is offered chain free, with 124 years remaining on the lease.



ROOM DESCRIPTIONS



FLOORPLAN & EPC

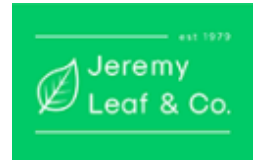

Approx Gross Internal Area
59 sq m / 636 sq ft

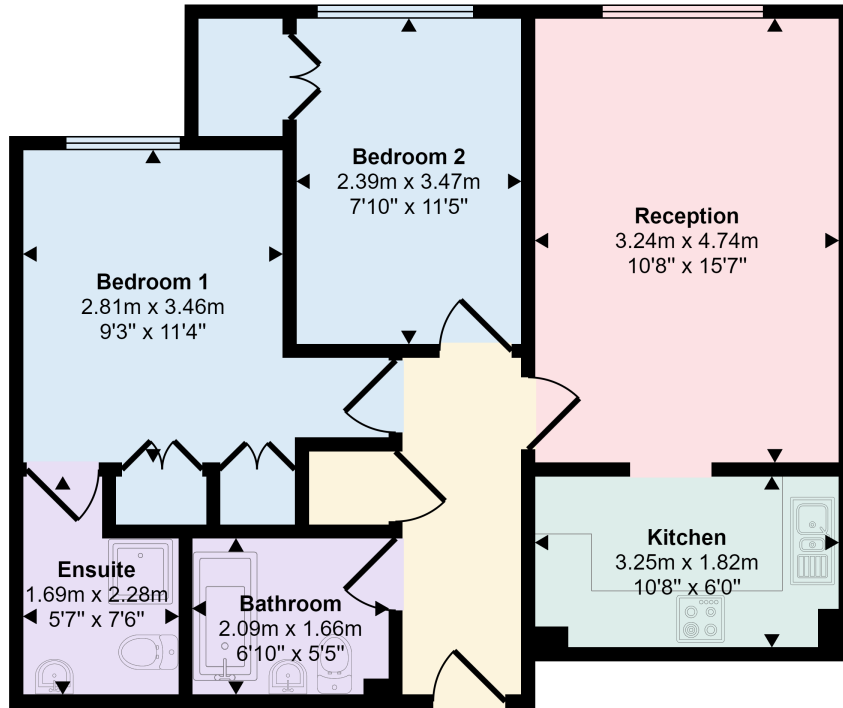

Floorplan

This floorplan is only for illustrative purposes and is not to scale. Measurements of rooms, doors, windows, and any items are approximate and no responsibility is taken for any error, omission or mis-statement. Icons of items such as bathroom suites are representations only and may not look like the real items. Made with Made Snappy 360.

Energy Efficiency Rating		Current	Potential
Very energy efficient - lower running costs			
(92+)	A		
(81-91)	B		
(69-80)	C	77	78
(55-68)	D		
(39-54)	E		
(21-38)	F		
(1-20)	G		
Not energy efficient - higher running costs			
England, Scotland & Wales		EU Directive 2002/91/EC	

North Finchley
863, High Road, London, N12 8PT
020 8446 4295
property@jeremyleaf.co.uk