

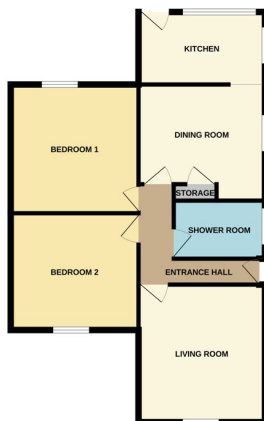

406a Fulbridge Road, Peterborough PE4 6SG

£210,000



\*\*\* SOLD WITH NO ONWARD CHAIN \*\*\* " Featuring a generous sized rear garden, this semi detached bungalow is ready for it's new owner. Benefiting from no onward chain, this home features a garage, driveway, entrance, 2 reception rooms, kitchen, 2 double bedrooms and a wet room. It's conveniently located close to Werrington, Gunthorpe and Walton, making it close by to a range of local amenities. EPC Energy Rating - E/Council Tax Band- B".



**ENTRANCE**

Door to side.

**LIVING**

13' 9" x 11' 9" (4.19m x 3.58m) (approx) UPVC double glazed window to front and radiator.

**DINING ROOM**

11' 9" x 10' 9" (max) (3.58m x 3.28m) (approx) Window to side.

**KITCHEN**

11' 7" x 6' 8" (3.53m x 2.03m) Fitted with a range of base and eye level units with work surfaces over, stainless steel sink unit, plumbing for a washing machine, space for a cooker, space for an undercounter fridge/ freezer and door to rear.

**BEDROOM 1**

11' 9" x 11' 9" (3.58m x 3.58m) (approx) Window to rear and radiator.

**BEDROOM 2**

11' 9" x 10' 8" (3.58m x 3.25m) (approx) Window to front.

**BATHROOM - WET ROOM**

Fitted with a three piece suite comprising low level W/C wash hand basin, shower and loft access. Window to side.

**OUTSIDE**

The front of the property has lawn and mature shrubs, gated access , driveway for off road parking. The rear of the property has fencing and is mainly laid to lawn.

**GARAGE**

A single garage.

**AGENT NOTES**

The floorplan is for illustrative purposes only. Fixtures and fittings do not represent the current state of the property. Not to scale and is meant as a guide only.

