



Jack Taggart & Co

RESIDENTIAL SALES

CURWEN PLACE, BN1 6UJ

£300,000

CURWEN PLACE, BN1 6UJ

OIEO £300,000

Large two double bedroom flat in Beechwood, situated in the prestigious Preston Park area. This sought after location is in the heart of Brighton and is surrounded by all local amenities and is a stone's throw away from Brighton's desirable seafront. Surrounding this area there are many shops, pubs, restaurants and cafes. Brighton and Preston Park train station are in walking distance which makes this location perfect for commuters. There are a range of exceptional nurseries and schools in the local area too.

Jack Taggart & Co are pleased to be offering this two bedroom apartment, which is within a purpose built, residential block. This apartment comprises a spacious open planned living/ dining room, a large window creating a bright and airy space, this room also features a double glazed door leading out to the east facing balcony, the perfect morning coffee spot with a beautiful tree lined view.

This property has a separate modern fitted kitchen offering partial integral appliances, plenty of storage and streamlined surface space. Both double bedrooms are of a great size, the master bedroom with views out to the balcony and both rooms with space for wardrobes and tv units. There is also a newly fitted family bathroom which features a shower over bath, sink and W/C. The property also offers communal gardens and comes with private off street parking as well as a garage.

This wonderful property is superb for a first time buyer or to buy as an investment opportunity, viewing is HIGHLY recommended. This property is being sold with NO CHAIN

Beechwood

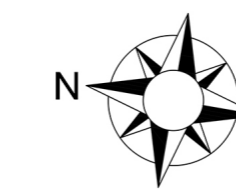
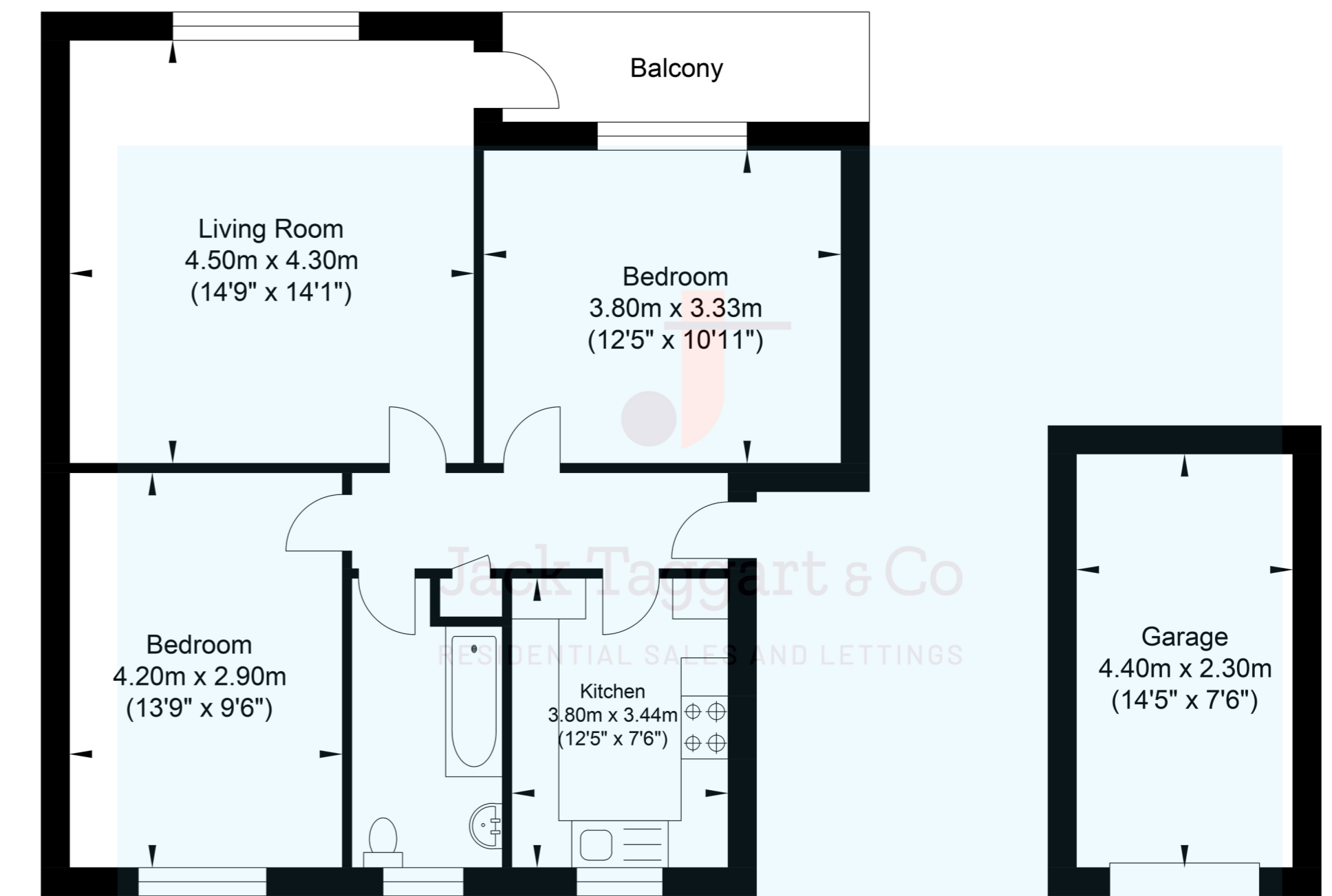

Approximate Floor Area
672.09 sq ft
(62.44 sq m)

Garage
Approximate Floor Area
108.93 sq ft
(10.12 sq m)

Approximate Gross Internal Area = 72.56 sq m / 781.02 sq ft
Illustration for identification purposes only, measurements are approximate, not to scale.

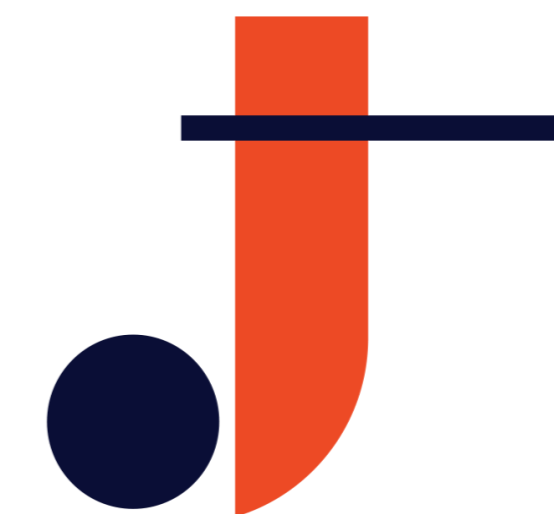

Jack Taggart & Co

RESIDENTIAL SALES

