



Wellesley Crescent, Potters Bar, Hertfordshire, EN6

£595,000

- CHAIN FREE
- TWO DOUBLE BEDROOMS
- SEPARATE KITCHEN
- POTENTIAL FOR REAR EXTENSION (STPP)
- DAME ALICE OWENS CATCHMENT
- OFF STREET PARKING
- LOUNGE / DINER
- GARAGE
- POTENTIAL FOR LOFT CONVERSION (STPP)

108, High Street, Potters Bar, EN6 5AT

01707 245 555

www.home-counties.com

Wellesley Crescent, Potters Bar, Hertfordshire, . EN62DQ

£595,000 Freehold

DAME ALICE OWENS SCHOOL CATCHMENT 2024. CHAIN FREE

This two bedroom semi detached bungalow would be ideal for those looking to buy a property within catchment and wishing to put their stamp on it. The home would benefit from either a small or major refurbishment with potential to extend to the side, rear and potential for conversion of the loft space (stpp)

The property has off street parking plus garage to the rear, kitchen and lounge to rear, two bedrooms to the front and family bathroom.

The private garden has patio to rear of the home, side access, lawn and patio area to the rear.

GROUND FLOOR
734 sq.ft. (68.2 sq.m.) approx.

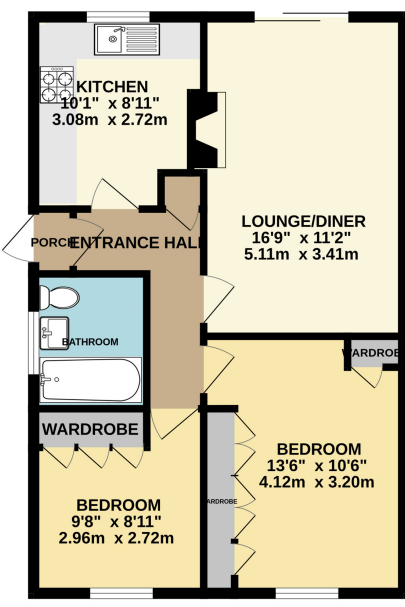
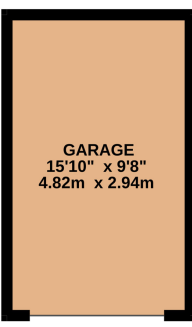

TOTAL FLOOR AREA : 734 sq.ft. (68.2 sq.m.) approx.

Whilst every attempt has been made to ensure the accuracy of the floorplan contained here, measurements of doors, windows, rooms and any other items are approximate and no responsibility is taken for any error, omission or mis-statement. This plan is for illustrative purposes only and should be used as such by any prospective purchaser. The services, systems and appliances shown have not been tested and no guarantee as to their operability or efficiency can be given.
Made with Metropix ©2024

