

FOR SALE

Sandlea Park, West Kirby, Wirral. CH48 0QF

Offers in Excess of £285,000



Perfect downsize! Tucked away on Sandlea Park in Sandlea House is this well-presented, two bedroom, ground floor flat. Offering a fantastic location in the centre of West Kirby, this property is ideal for a buyer looking to be close to local amenities and transport links as well as stunning walks and to be on single floor living. Boasting light and airy accommodation, this is definitely not one to be missed.





## Ground Floor

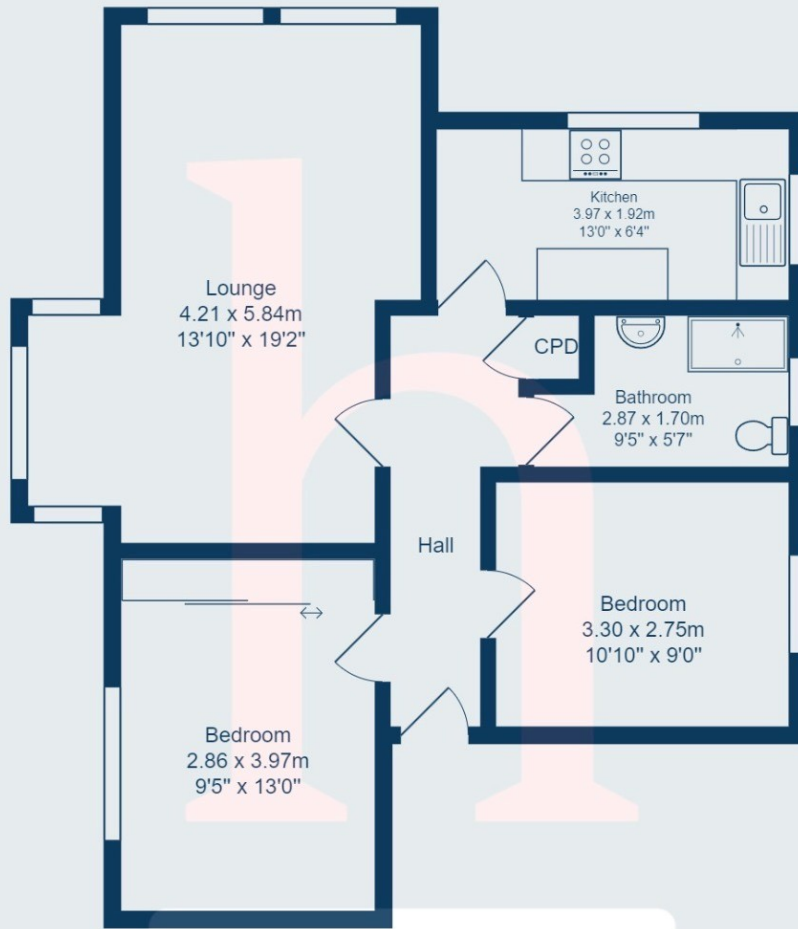

Total Area: 62.9 m<sup>2</sup> ... 677 ft<sup>2</sup>

All measurements are approximate and for display purposes only.