

FOR SALE

£575,000

Barmouth Avenue, Perivale, Greenford, Greater London. UB6



Peter Gamble & Co. offer to the market this well presented 3 BEDROOM SEMI-DETACHED house.

Situated on this quiet tree lined street in the heart of Perivales' Medway Village the property is well served by local outstanding primary schools, an abundance of local shops and the E5 and 297 bus routes just at the end of the road with Perivale tube station only 7 minutes walk from the property.

There are several local parks and open spaces nearby, including easy access into Ealing and the A40.

To the ground floor the property comprises, open plan living room which runs the full length of the house incorporating the fitted kitchen diner leading onto the West facing rear Garden benefitting from great





Approximate Gross Internal Area 922 sq ft - 85 sq m

Ground Floor Area 393 sq ft – 36 sq m

First Floor Area 413 sq ft – 38 sq m

Outbuilding Area 116 sq ft – 11 sq m



Outbuilding

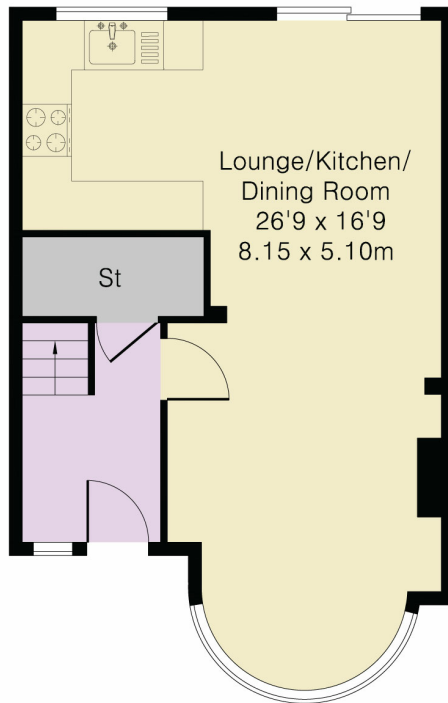

Ground Floor

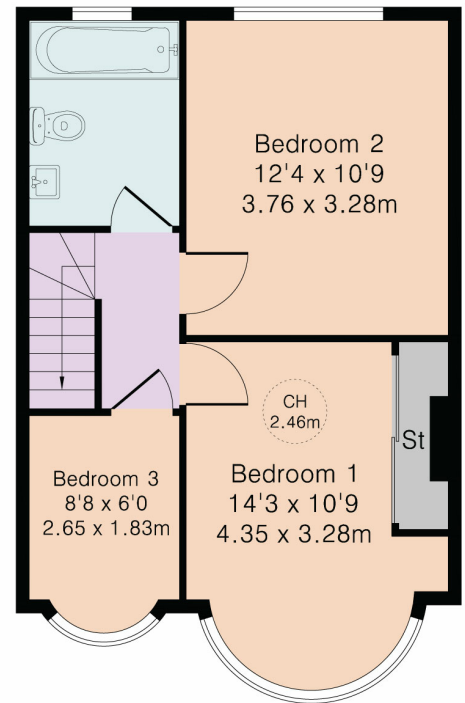

First Floor



Although Pink Plan Ltd ensures the highest level of accuracy, measurements of doors, windows and rooms are approximate and no responsibility is taken for error, omission or misstatement. These plans are for representation purposes only as defined by RICS code of measuring practise. No guarantee is given on total square footage of the property within this plan. The figure icon is for initial guidance only and should not be relied on as a basis of valuation.

