



14 Ryehill Grove, Leith Links, Edinburgh, EH6 8ET

Four Bedroom Double-Upper Villa

Up to date price and viewing info at [mov8realestate.com/property](https://www.mov8realestate.com/property)

espc rightmove  Zoopla
find your happy

Property Description

Very spacious, four bedroom, double-upper villa with original features, forming part of a row of impressive Victorian properties. Set on a quiet residential street, located in Leith Links, to the east of Edinburgh city centre.

Comprises: a ground floor entrance stairway, hall, living room, dining kitchen, four double bedrooms, a bathroom, en-suite and utility room. Features include double glazing, gas central heating, a fitted kitchen and TV and telephone points. Further features include period plasterwork, high ceilings and panelled doors, a paved rear garden, with ample unrestricted on-street parking to the front.

The ground floor entrance stairway leads up to the hall which serves each room on the first floor. Set to the front, the light and spacious living room features a bay window, sanded and varnished floorboards, decorative cornice and a living flame fire.

With a pantry cupboard and space for dining furniture, the dining kitchen is fitted with contemporary wall and base units with stone effect worktops and a stainless steel sink. Appliances include an integrated fridge, gas hob, double electric oven and extractor hood, while the adjoining utility room has space for further white goods.

Bedroom three (which may be used as a dining room) is set to the front, whilst bedroom two is to the rear, includes a plain cornice, and the bathroom is fitted with a three-piece suite, parquet flooring and an electric shower. The second-floor landing is spacious enough to be used as a study area, and the master bedroom features a walk-in wardrobe and en-suite bathroom.

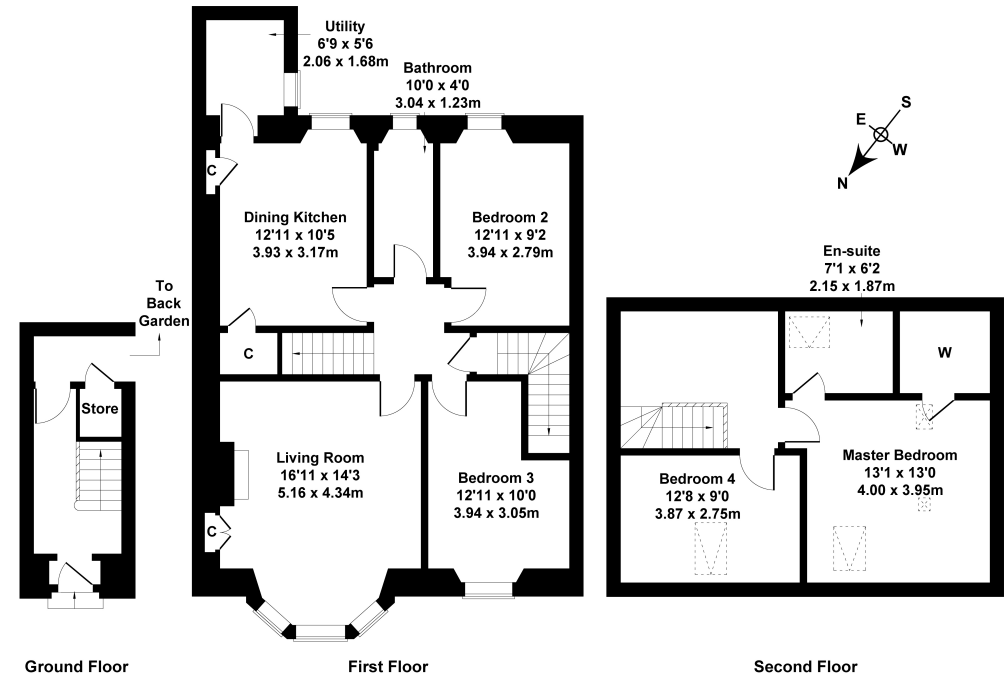

Area Description





The Leith Links district is most famous for its open parklands, one of Edinburgh's larger green spaces, with other leisure opportunities including Seafield Recreation Ground and Craigtinny Golf Course. The fashionable Shore district can be found around a mile away, with its fine selection of Michelin-starred restaurants, and the Ocean Terminal retail complex a little further beyond offers a

multi-screen cinema, gym, spa, and a wide choice of high-street retailers and restaurants. Leith Walk, Easter Road, and Great Junction Street all lie within around a mile's radius, offering a wealth of restaurants, cafés, bars, and supermarkets. There are frequent bus services in the area, as well as a number of primary schools, with secondary schooling at Leith Academy.





Our Services

-  Free pre-sale property valuations
-  Great value fixed estate agency fees
-  Extensive buyer matching database
-  Purchase and sale conveyancing

Contact Us

0345 646 0208

sales@mov8realestate.com

www.mov8.com

Head Office

6 Redheughs Rigg, Edinburgh, EH12 9DQ

Glasgow Office

77 Renfrew Street, Glasgow, G2 3BZ



Estate Agents and Solicitors



These particulars do not form part of any contract and the statements or plans contained herein are not warranted nor are they to scale. All descriptions, dimensions, areas, reference to condition and necessary permissions for use and occupation and other details are given in good faith, and are believed to be correct, but any prospective purchaser should not rely on them as statements or representations of fact, and any prospective purchaser must satisfy themselves by inspection or otherwise as to the correctness of each of them. The Seller shall not be bound to accept the highest or any offer nor to accept a full offer of the Fixed Price where this is applicable. Approximate measurements have been taken by sonic device and measurements are most often taken to the widest point of any room or space. Services and appliances have not been tested for efficiency or safety and no warranty is given as to their compliance with any Regulations. Offers should be made using the Combined Standard Clauses.