



Three Bedroom Terraced House
Trafalgar Street, Gillingham, Kent, ME7 4RL

£260,000
Freehold

Trafalgar Street, Gillingham, Kent, ME7 4RL

£260,000

Freehold

Description

Guide Price: £260,000 to £280,000 - Offered with no onward chain, this charming three-bedroom mid-terrace home is ideal for those looking to get onto the property ladder, downsize, or a possible Buy to Let investment. The property boasts generous living space, contemporary decor and with Gillingham High Street and its Train Station within a 1-mile radius the location is perfect. The accommodation offers an entrance porch, lounge with beautiful bay window flooding the room with natural light, a separate dining room/second reception room providing access to a cellar for additional storage. A newly fitted modern kitchen and bathroom with shower over bath, both finished to a high standard and a handy utility area which leads out to the garden. Upstairs three separate good size bedrooms, with the main benefitting from built in wardrobes. Externally a front garden and an easy to maintain south east facing garden measuring approximately 40 x 14 ft with patio area's, artificial lawn and established plant borders. This home is turn key ready and will be popular, so call the Greyfox sales team in Rainham to book your viewing today.

Key Features

- Chain Free
- Two Reception Rooms & Cellar
- Three Separate Generous Bedrooms
- Newly Fitted Kitchen & Bathroom
- Contemporary Decor Throughout
- Utility Area
- Close To Gillingham High Street & Train Station
- South East Facing Garden

Local Area

Gillingham is located within the Medway towns and offers railway links to central London and Ebbsfleet International and road connections to the A2/M2, M25 and M20. In addition to its town centre Gillingham offers a host of amenities including ice skating, country parks, an outdoor pool, a golf course, Medway Park Sports Centre and more.

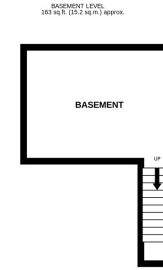

GROUND FLOOR
518 sq.ft. (47.7 sq.m.) approx.

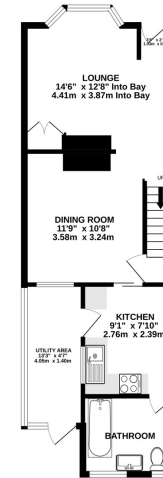

1ST FLOOR
376 sq.ft. (34.9 sq.m.) approx.

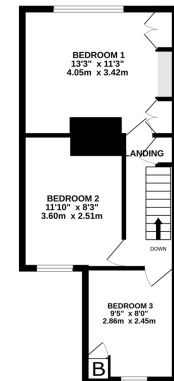

TOTAL FLOOR AREA : 1052 sq.ft. (97.7 sq.m.) approx.

Whilst every attempt has been made to ensure the accuracy of the floorplan contained here, measurements of doors, windows, rooms and any other items are approximate and no responsibility is taken for any error, omission or mis-statement. This plan is for illustrative purposes only and should be used as such by any prospective purchaser. The services, systems and appliances shown have not been tested and no guarantee as to their operability or efficiency can be given.

Made with Metropix ©2024



Property Location

Trafalgar Street, Gillingham, Kent, ME7 4RL

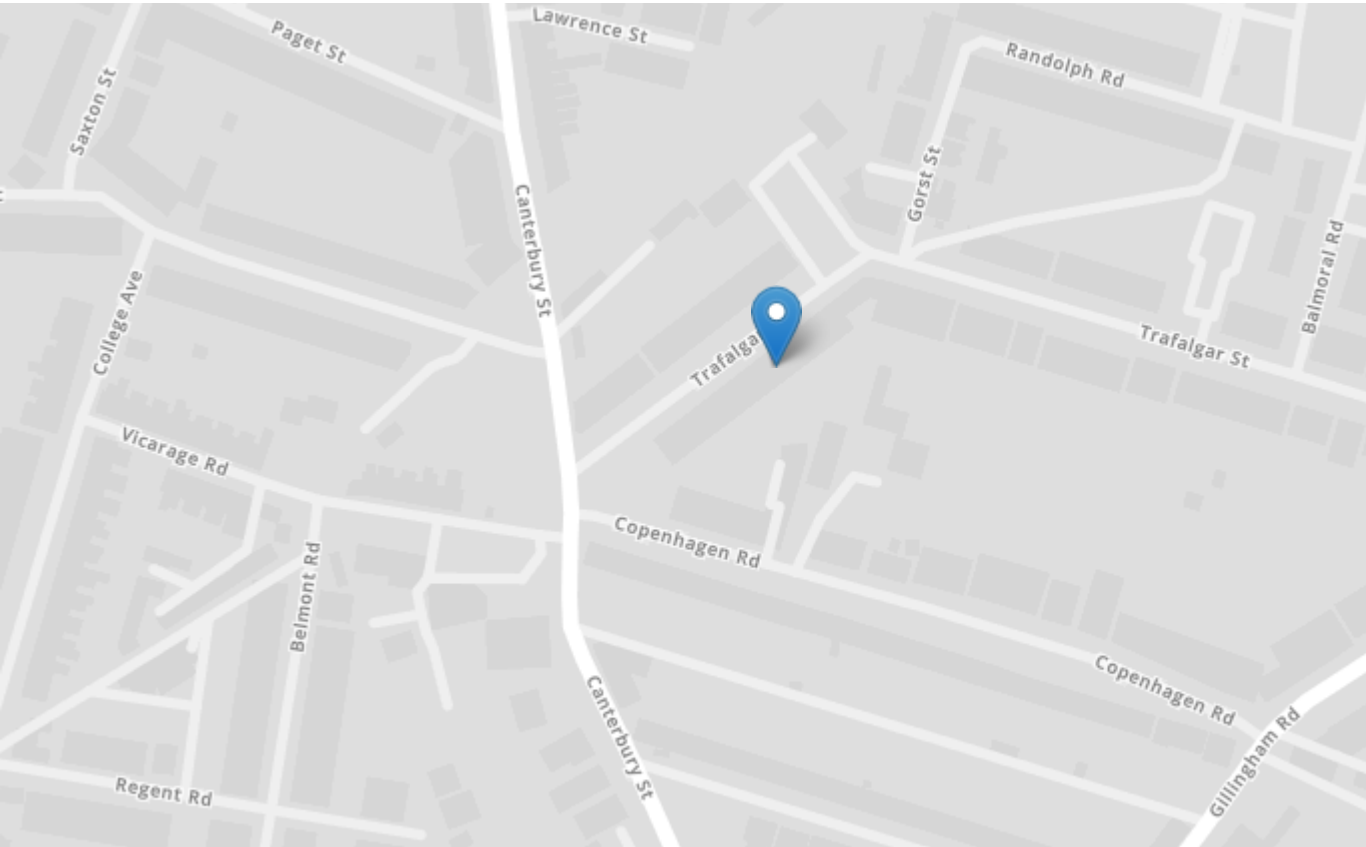

Energy Efficiency Rating		Current	Potential
Very energy efficient - lower running costs			
(92+)	A		
(81-91)	B		87
(69-80)	C		
(55-68)	D	67	
(39-54)	E		
(21-38)	F		
(1-20)	G		
Not energy efficient - higher running costs			
England, Scotland & Wales		EU Directive 2002/91/EC	

Tenure	Freehold
Lease Term	
Ground Rent	
Service Charge	
Local Authority	Medway
Council Tax	Band B

Greyfox Walderslade

Unit 2, Thetford House
Walderslade Village Centre
Walderslade Road
Chatham
Kent
ME5 9LR
Tel: 01634 672227 Email:
walderslade@greyfox.co.uk

Greyfox Rainham

67C High Street
Rainham
Kent
ME8 7HS
Tel: 01634 377737 Email:
rainham@greyfox.co.uk

Agent Notes

These particulars are prepared as a general guide to a broad description of the property and should not be relied upon as a statement or representation of fact and do not constitute part of an offer or contract. The seller does not make or give nor do our employees or Greyfox have authority to make or give any representation or warranty to the property. We have not carried out a structural survey and the services, appliances and specific fittings have not been tested. All photographs, measurements, floorplans and distances referred to are given as a guide only and should not be relied upon for the purchase of carpets or any other fixtures or fittings. Lease details, service charges and ground rent (where applicable) and council tax are given as a guide only and should be checked and confirmed by you on inspection and your solicitor prior to exchange of contracts. If there are any points of particular importance to you we will be pleased to check the information for you and to confirm that the property remains available. This is particularly important should you be travelling some distance to view and where statements have been made by us to the effect that the information has not been verified. The copyright of all details, photographs and floorplans remain exclusive to Greyfox. For details of our privacy policy and referral fee arrangements with any of our selected partner companies please visit <https://www.greyfox.co.uk/legal/privacy> and <https://www.greyfox.co.uk/referral-fees>.