

FOR SALE

£835,000 Freehold



14 Limes Avenue, London, N12 8QN

- Four Bedrooms
- Two Receptions
- Bathroom & sep wc

- Council Tax Band - E
- 0.5 miles to Woodside Park Tube Station
- Chain Free



PROPERTY DESCRIPTION

This four bedroom family house is set over two floors and retains many period features throughout. In need of complete modernisation, the property offers plenty of scope for refurbishment and extension (STPP) and is conveniently located for North Finchley's shopping and transport amenities, with Woodside Park tube station (Northern Line) 0.5 miles away. Chain Free. Viewing highly recommended.



ROOM DESCRIPTIONS



FLOORPLAN & EPC



Approx Gross Internal Area
126 sq m / 1357 sq ft

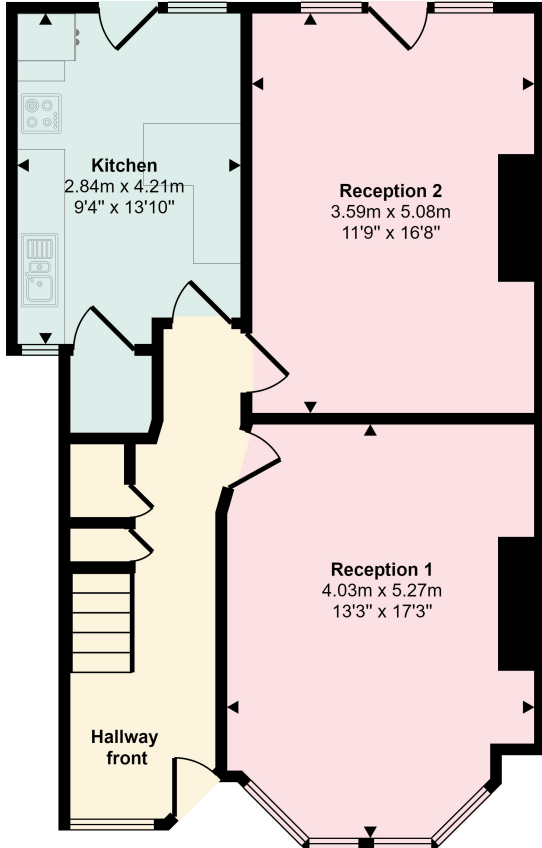

Ground Floor
Approx 63 sq m / 680 sq ft

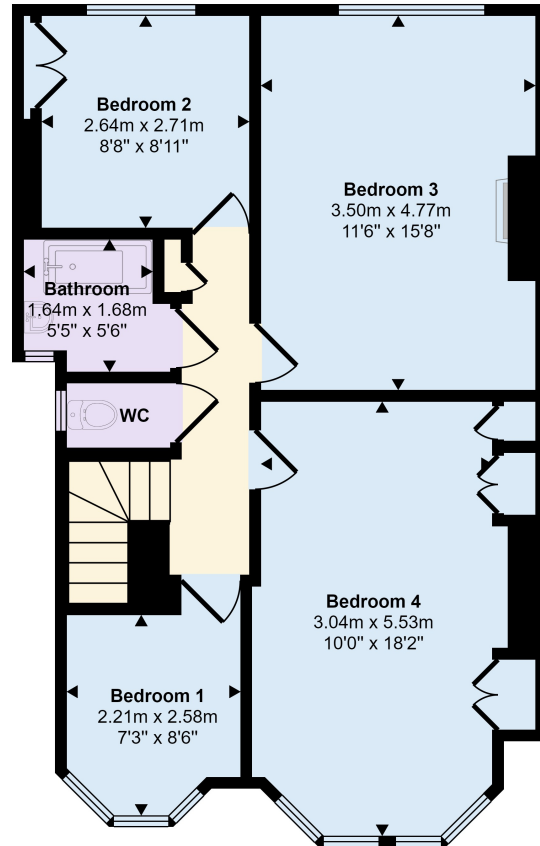

First Floor
Approx 63 sq m / 677 sq ft

This floorplan is only for illustrative purposes and is not to scale. Measurements of rooms, doors, windows, and any items are approximate and no responsibility is taken for any error, omission or mis-statement. Icons of items such as bathroom suites are representations only and may not look like the real items. Made with Made Snappy 360.

Energy Efficiency Rating		Current	Potential
Very energy efficient - lower running costs			
(92+)	A		
(81-91)	B		86
(69-80)	C		
(55-68)	D	68	
(39-54)	E		
(21-38)	F		
(1-20)	G		
Not energy efficient - higher running costs			
England, Scotland & Wales		EU Directive 2002/91/EC	

North Finchley
863, High Road, London, N12 8PT
020 8446 4295
property@jeremyleaf.co.uk