



Parchmore Road, Thornton Heath, Surrey, CR7 8HD

£1,200 pcm Freehold

- Licensed House in Multiple Occupation (HMO)
- Fully and extensively refurbished
- EPC rating C
- End terrace building
- Intercom entry system & CCTV
- Available immediately
- Communal kitchen & garden
- Free Wi-fi available
- Presented unfurnished
- En-suite bedroom to let / bill inclusive in rent

Southbridge Place, Surrey, CR0 4HA

Tel: 0330 043 0002

Email: save@truuli.co.uk Web: www.truuli.co.uk

Parchmore Road, Thornton Heath, Surrey, CR7 8HD

£1,200 pcm Freehold

A recently renovated room with all bills included in the rent is now ready for immediate occupancy. The apartment is within an end-terraced house on Parchmore Road.

Located in Thornton Heath, the room is on the 1st floor with an en-suite bathroom, perfect for professionals or long-term tenants. Providing privacy and comfort for up to two occupants. These living spaces offer an ideal setup for tenants looking for convenience and independence within a well-maintained building.

Parchmore Road

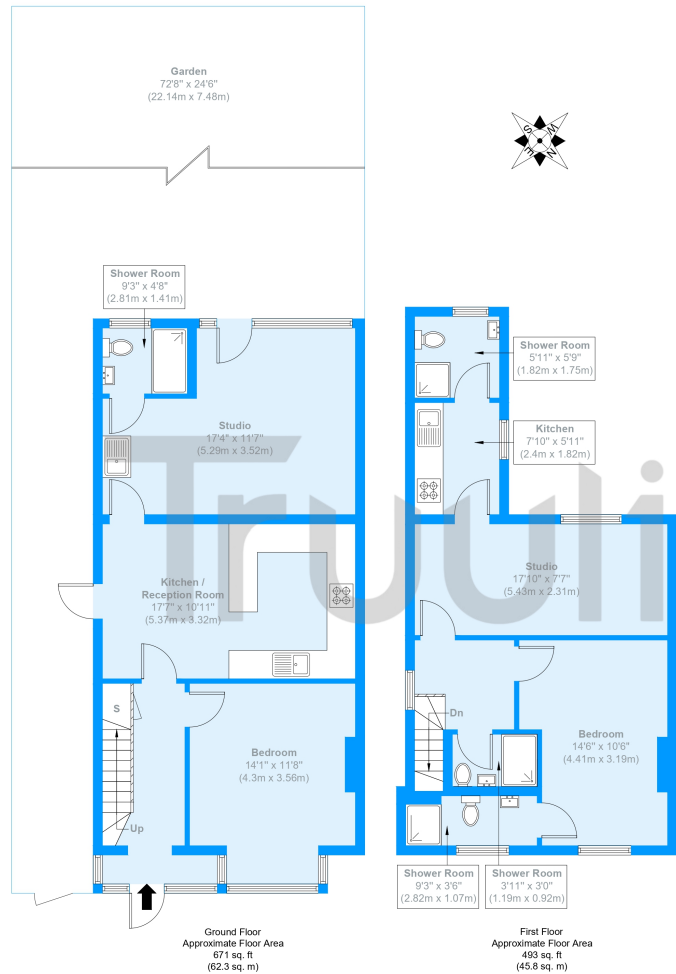

Approximate Gross Internal Area = 108.1 sq m / 1164 sq ft

The Floor plan is not to scale and measurements and areas shown are approximate and therefore should be used for illustrative purposes only. The plan has been prepared in accordance with the RICS code of Measuring Practice and whilst we have confidence in the information produced it must not be relied on. Maximum lengths and widths are represented on the floor plan. If there is any aspect of particular importance, you should carry out or commission your own inspection of the property.
Copyright © BleuPlan

Energy Efficiency Rating		
	Current	Potential
Very energy efficient - lower running costs		
(92+)	70	86
A		
(81-91)		
B		
(69-80)		
C		
(55-68)		
D		
(39-54)		
E		
(21-38)		
F		
(1-20)		
G		
Not energy efficient - higher running costs		
England, Scotland & Wales		
EU Directive 2002/91/EC		