



- Three Bedroom Terraced House
- Garage & Driveway
- Two Generous Reception Rooms
- Cloakroom
- Garden Overlooking Playing Fields
- Kitchen With Fitted Appliances
- Extended
- UPVC Windows & Gas Central Heating

26 Mayne Crest, Chelmsford, Essex. CM1 6UB.

Guide Price £400,000 - £450,000

Occupying an excellent position in the popular Springfield district of Chelmsford is this three-bedroom terraced house which offers excellent-sized accommodation throughout. New to the market, we feel this well-established home lends itself well to both first time buyers and buy to let investors alike. The internal accommodation comprises an entrance hall, a well-appointed lounge, a spacious dining/family room, a kitchen with a good range of fitted appliances, a ground floor cloakroom, three DOUBLE bedrooms, and a family bathroom. Outside, there is a low-maintenance rear garden overlooking playing fields, an integral garage, and a driveway that provides off-road parking for two vehicles.



Property Details.

Entrance Hall

Lounge



21' 2" x 11' 5" (6.45m x 3.48m)

Cloakroom



Dining Area



11' 10" x 11' 6" (3.61m x 3.51m)

Family Area

10' 6" x 6' 11" (3.20m x 2.11m)

Kitchen



17' 4" x 8' 0" (5.28m x 2.44m)

First Floor Landing

Bedroom One



10' 11" x 10' 3" (3.33m x 3.12m)

Property Details.



Bedroom Two

Family Bathroom



11' 2" x 9' 1" (3.40m x 2.77m)

Rear Garden



Bedroom Three



9' 5" x 8' 1" (2.87m x 2.46m)



Garage & Off Road Parking

Property Details.

Floorplans

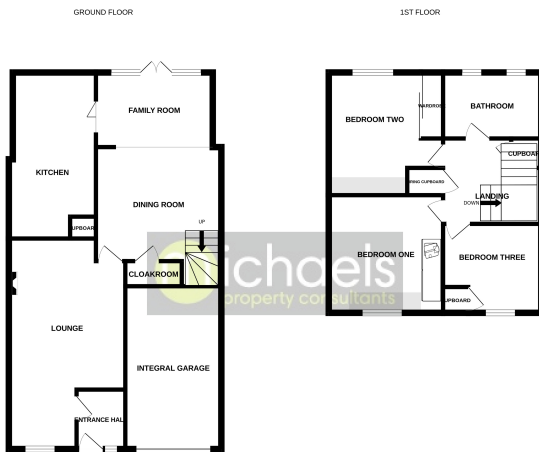

We have endeavored to ensure the accuracy of the floorplans contained here, measurements of space, square footage and lot areas for the approximate use of reference only. It is the responsibility of the purchaser to verify the accuracy of the floorplans, measurements and lot areas for the property. The services, systems and appliances shown here are based on visual inspection and are not guaranteed. We do not warrant the accuracy of the floorplans, measurements and lot areas.

Location

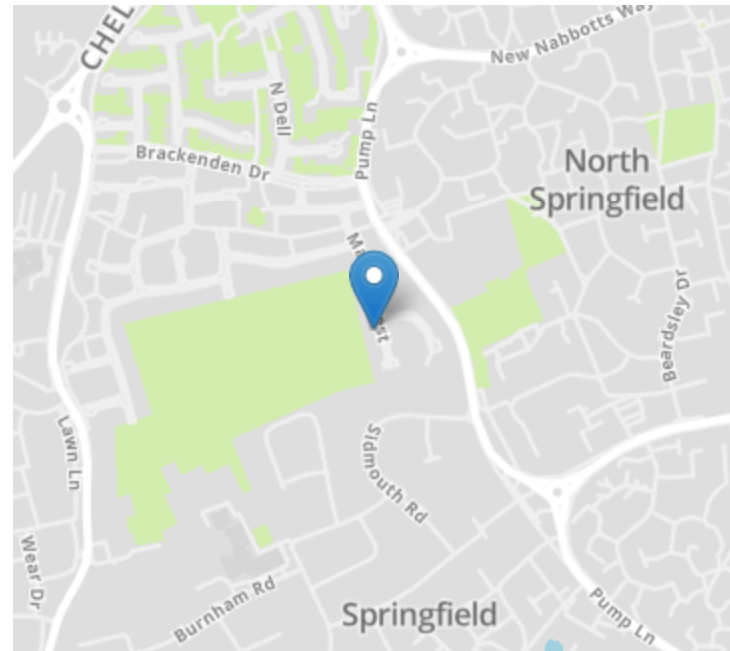

Energy Ratings

We have not carried out a structural survey and the services, appliances and specific fittings have not been tested. All photographs, measurements, floor plans and distances referred to are given as a guide only and should not be relied upon for the purchase of carpets or any other fixtures or fittings. Gardens, roof terraces, balconies and communal gardens as well as tenure and lease details cannot have their accuracy guaranteed for intending purchasers. Lease details, service ground rent (where applicable) are given as a guide only and should be checked and confirmed by your solicitor prior to exchange of contracts.