

Victoria Road, W3

Approximate Gross Internal Area = 43.3 sq m / 467 sq ft

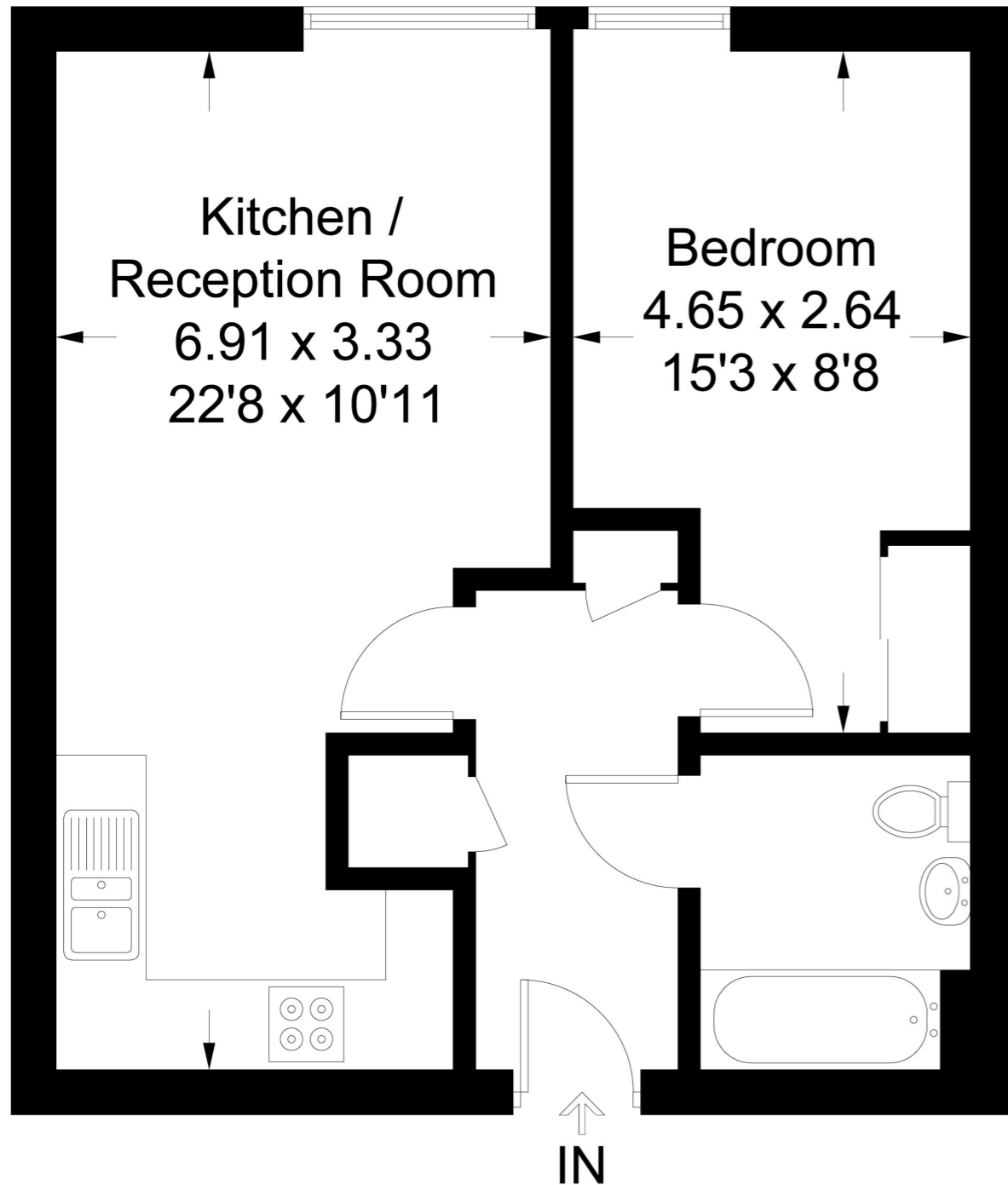

Sixth Floor

Measured in accordance with RICS Code of Measuring Practice. To be used for identification and guidance purposes only. Whilst every care is taken in the preparation of this plan, please check all dimensions, shapes and compass bearings before making any decisions reliant upon them. www.london58.com © 2021 hello@london58.com



1 BEDROOM FLAT

Victoria Road, W3
£320,000

This smart sixth floor apartment with lift access is in the popular Victoria Road development, moments from North Acton Central line station.

With communal gardens and modern interior it's perfect for first time buyers and investors alike.

FEATURES

- Passed EWS1 Fire Safety Check
- Purpose Built Apartment
- Contemporary Interior
- Lift Access
- Communal Gardens
- Moments from HS2, Crossrail and the Central Line



1 BEDROOM FLAT

103 Trentham Court

Inside you'll find spacious open plan living and dining areas with the well designed kitchen arranged neatly along three walls.

The easterly facing windows gets the best of the morning sun. You'll find plenty of storage in the hallway which leads to the bedroom which is a generous double with built in wardrobes. The family bathroom is next door and has a white suite including shower over the bath. The building has recently passed all EWS1 fire safety tests and with no onward chain it's ready to move straight in.

