



Day & Co
ESTATE AGENTS

28 Cavendish Street

Keighley

BD21 3RG



19 High Street, Steeton,
Keighley, West Yorkshire, BD20
6NT

£265,000

T: 01535 664609

W: www.dayandcoestateagents.co.uk

E: keighley@dayandcoestateagents.co.uk

- EPC Rating Is C
 - Three Bedrooms & Master En-Suite
 - Enclosed Rear Artificial Lawn & Patio With Outbuilding
- Spacious Extended End Terrace Cottage
 - 30ft Long Dining Kitchen/Lounge With Multi-Fuel Burning Stove
 - Popular Village Of Steeton/NO CHAIN

SUMMARY

****A SPACIOUS EXTENDED 3 BEDROOM (MASTER EN-SUITE) END TERRACE COTTAGE, EVER POPULAR VILLAGE LOCATION OF STEETON WITH EXCELLENT ACCESS TO THE PRIMARY SCHOOL & AIREDALE GENERAL HOSPITAL!!****
Having a 30ft long dining kitchen, Lounge with multi-fuel burning stove, Enclosed rear artificial lawn & patio with outbuilding - OFFERED FOR SALE WITH NO ONWARD CHAIN!! EPC rating is C.

FULL DESCRIPTION

Viewing is essential to fully appreciate this spacious extended three bedroom (master en-suite) end terrace cottage situated in the popular village location of Steeton with excellent access to the primary school and Airedale General Hospital. The accommodation comprises of a good size lounge having a multi-fuel burning stove in character fireplace, double glazed windows to the front and rear, two radiators, staircase to first floor. The dining kitchen is a real feature of this property measuring approximately 30ft7 in length, having a range of modern base and wall mounted units, integrated double oven, five ring gas hob, washing machine, double glazed windows to the front and rear, door leading to the rear garden. To the first floor there are three double bedrooms, the master having an en-suite shower room. The spacious shower room has shower cubicle, WC, wash hand basin, chrome heated towel rail. Externally the property has an enclosed rear artificial lawn with patio and outbuilding. Offered for sale with no onward chain, EPC rating is C.

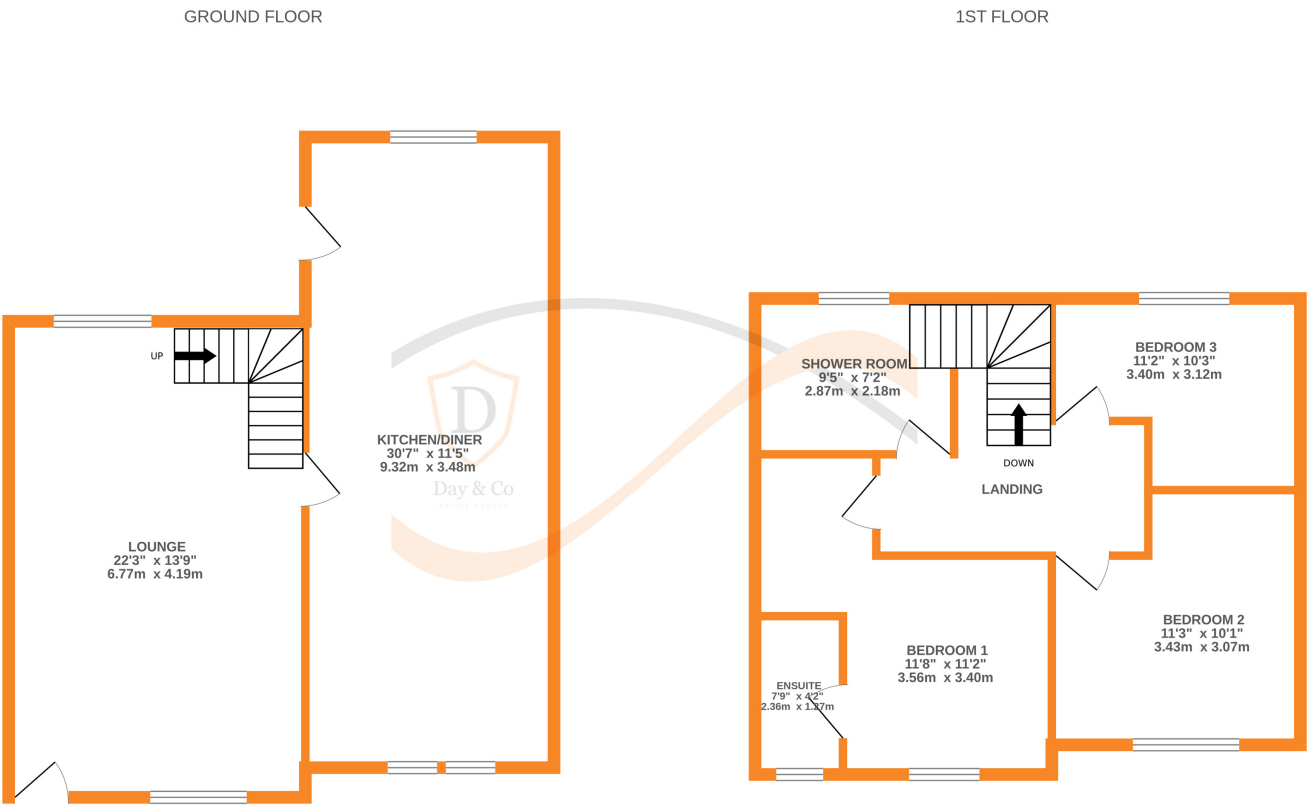

Whilst every attempt has been made to ensure the accuracy of the floorplan contained here, measurements of doors, windows, rooms and any other items are approximate and no responsibility is taken for any error, omission or mis-statement. This plan is for illustrative purposes only and should be used as such by any prospective purchaser. The services, systems and appliances shown have not been tested and no guarantee as to their operability or efficiency can be given.
Made with Metropix ©2025