



£350,000 Freehold

Building Plot
Crib House Lane
Clewer, Wedmore BS28 4JG





Building Plot

Crib House Lane

Clewer, Wedmore BS28 4JG



0.5 acres

£350,000 Freehold

Description

With absolutely breath-taking panoramic views, this unique building plot, in a wonderful, elevated position overlooking surrounding countryside, offers an opportunity to build a 3-bedroom home with double garage within extensive gardens.

- Building plot for a detached dwelling with planning permission granted January 2023
- Permission granted for a 3-bedroom chalet bungalow with separate double garage, driveway, parking and turning areas.
- Freehold plot of just over 0.5 acres/0.224 hectares with access from Crib House Lane
- Purchaser must be registered on Somerset Council's Self Build Register and have connections to the Parish of Wedmore. Please call for more information regarding eligibility.

Planning

Planning consent was granted by Sedgemoor District Council on 10th January 2023 planning reference number 50/22/00108 – "Erection of 1 dwelling with detached garage, demolition of an outbuilding and widening of vehicular access."

Services

There are no services on the plot, and we advise purchasers to make their own enquiries and satisfy

themselves as to the availability and capacity of any services.

Location

Clewer is a small hamlet situated between the villages of Cheddar and Wedmore and holds a real sense of community with many local events with the neighbouring hamlets of Crickham and Cocklake.

Wedmore is a thriving village set on a high ridge above the Somerset Levels with a rich history and architectural heritage. Established in Saxon times, the modern-day Wedmore is an exciting social and commercial rural centre with a wide range of retail and leisure facilities including a selection of boutique shops. Day to day amenities include a newsagents/general store, chemist, a butcher shop, delicatessen, post office, fishmongers, grocers, a range of eateries, 3 public houses. A lively and friendly community, Wedmore hosts over 70 organisations with a diversity of cultural and sporting activities including opera, theatre, parkland golf course, floodlit all weather tennis courts, indoor and outdoor bowling greens and both cricket and football pitches.

Directions

From Clewer, ascend Long Lane and turn right into Crib House Lane at the top of the hill. The plot is a little way along on the right-hand side and marked by a Cooper and Tanner For Sale board.

Local Information Clewer

Local Council: Somerset

Council Tax Band: TBC

Services: Buyer to make their own enquiries

Tenure: Freehold



Motorway Links

- M5



Train Links

- Highbridge
- Weston-super-Mare



Nearest Schools

- Wedmore First School
- Hugh Sexey Middle School
- Kings of Wessex Academy

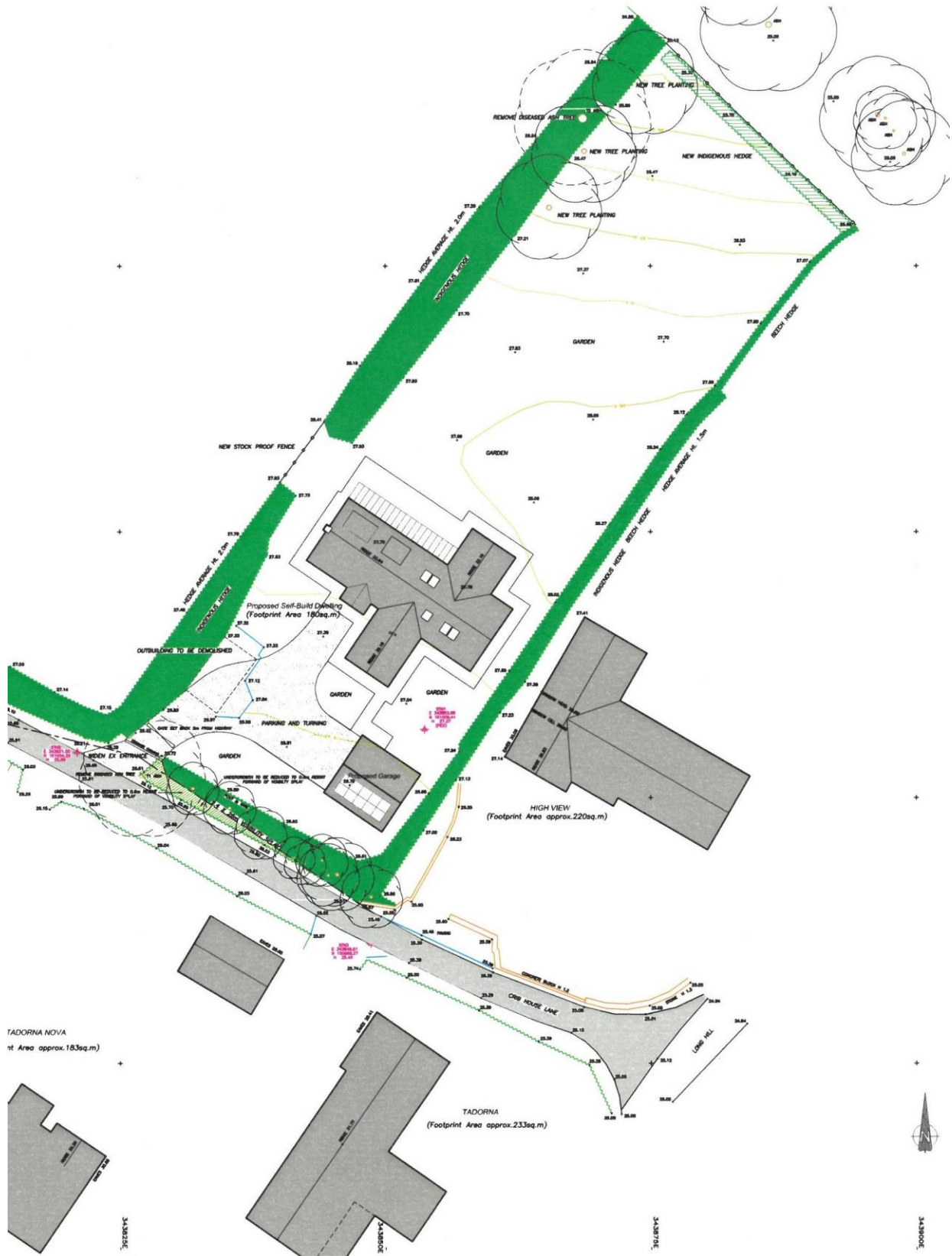

WEDMORE OFFICE

telephone 01934 713296

Providence House, The Borough, Wedmore, Somerset BS28 4EG

wedmore@cooperandtanner.co.uk



Important Notice: These particulars are set out as a general outline only for the guidance of intended purchasers and do not constitute, nor constitute part of, an offer or contract. All descriptions, dimensions, reference to condition and necessary permissions for use and occupation, warranties and other details are given without responsibility and any intending purchasers should not rely on them as statements or representations of fact but must satisfy themselves by inspection or otherwise as to the correctness of each of them.

