

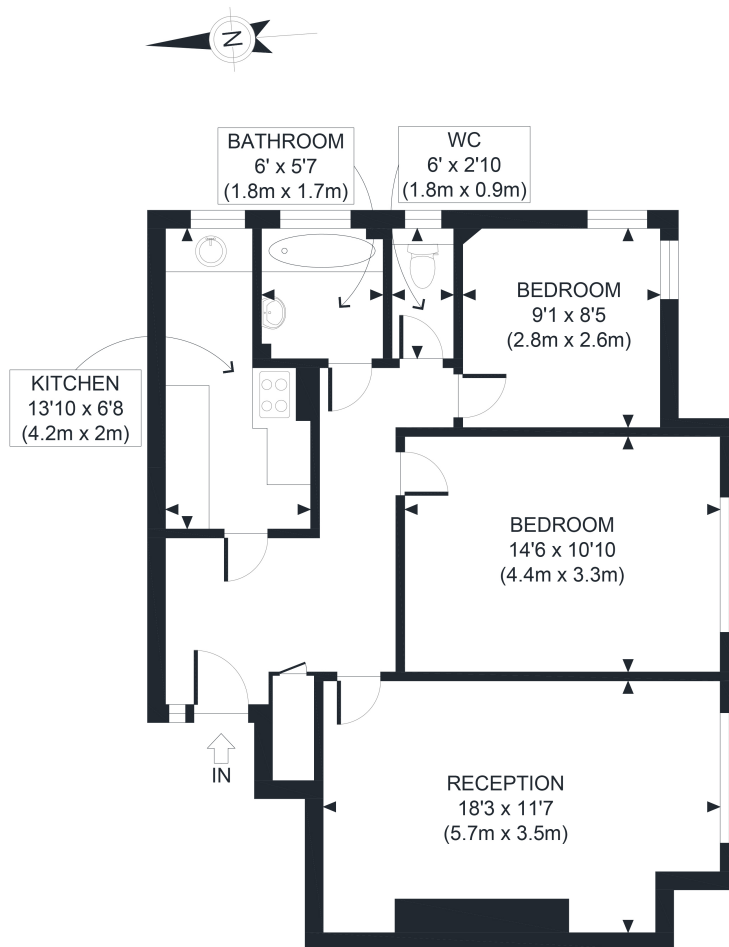

Acol Court, Acol Road, London, NW6

£2,250 pcm

- Two Double Bedroom Apartment
- Fully Fitted Kitchen
- Unfurnished
- Direct Lift Entry
- Third Floor



THIRD FLOOR
GROSS INTERNAL
FLOOR AREA 724 SQ FT

APPROX. GROSS INTERNAL FLOOR AREA 724 SQ FT / 67 SQM

Ref:

Copyright **photoplan**

Disclaimer: Floor plan measurements are approximate and are for illustrative purposes only. While we do not doubt the floor plan accuracy and completeness, you or your advisors should conduct a careful, independent investigation of the property in respect of monetary valuation

