



**Walsworth Road**  
HITCHIN,  
Hertfordshire, SG4 9SY  
Guide Price £275,000

COUNTRY PROPERTIES  
PART OF HUNTERS



Offered to the market with no onward chain is this superb two bedroom second floor apartment located within easy access to Hitchin train station and Town centre. The accommodation offers a generous layouts with a spacious living room, separate kitchen, main double bedroom with an en-suite shower room, second bedroom and bathroom. Sanders Place benefits from secure underground parking.

We have been advised by the vendor that the remaining lease on the property is 108 years, the Service Charge is £1,320 per annum with a ground rent of £150 per annum.

Hitchin is a charming medieval market town and has many fine Tudor and Georgian buildings, particularly around the market square. Near to the market square stands the large medieval parish church of St Mary. The town provides good shopping as well as a swimming pool, football team, two theatres, a wide variety of restaurants and pubs and highly regarded girls and boys schools. There is also a mainline railway station providing direct access to Kings Cross and Cambridge.

- Chain free
- Attractive modern apartment
- Two bedrooms
- Open plan kitchen/living area
- En-Suite to Master Bedroom
- Electric security gates
- Underground parking
- 0.2 mile, 4 min walk to Hitchin train station (as per Google maps)
- 0.7 mile, 14 mins walk to Hitchin town centre (as per Google maps)









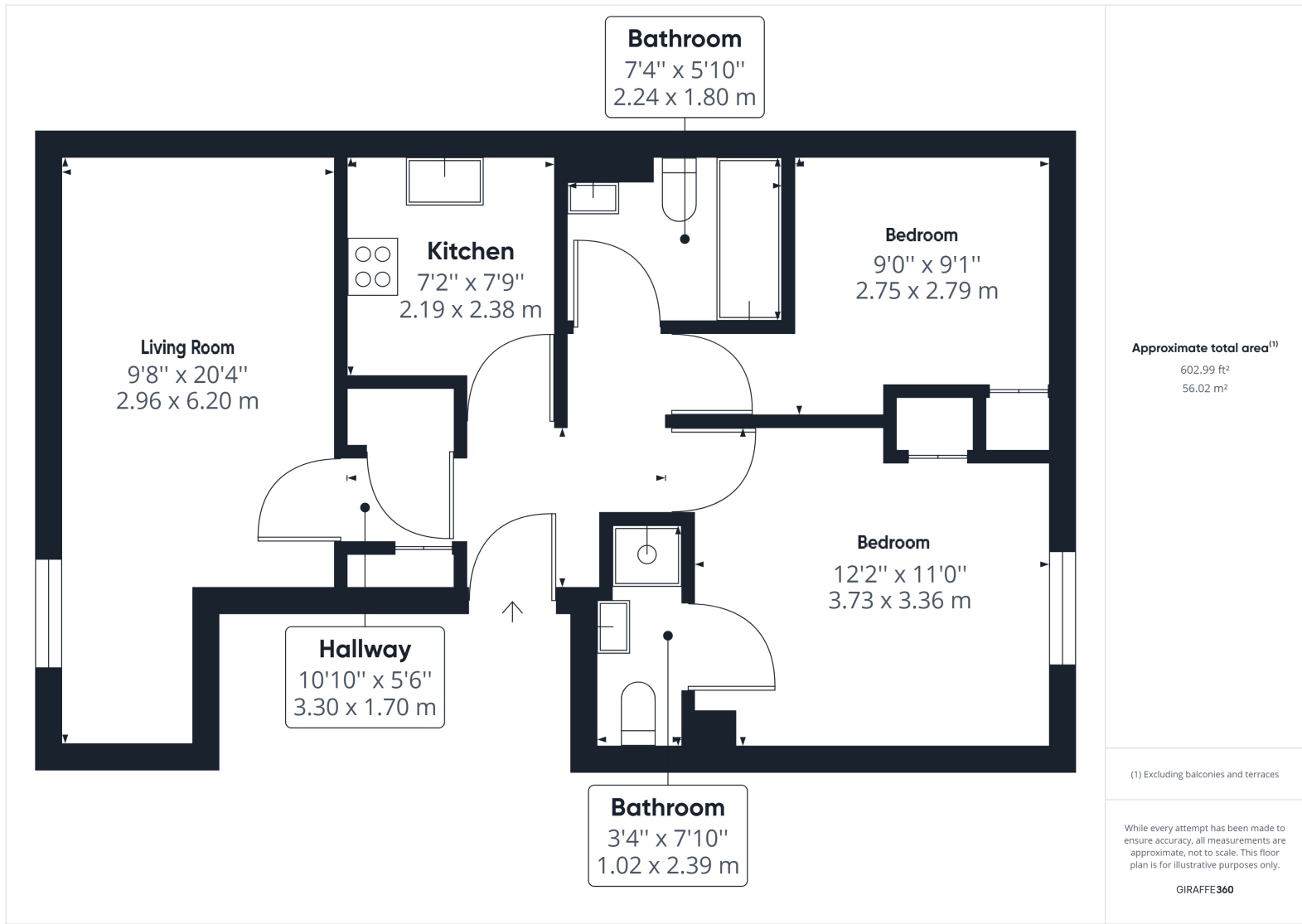

All measurements are approximate and quoted in metric with imperial equivalents and for general guidance only and whilst every attempt has been made to ensure accuracy, they must not be relied on. The fixtures, fittings and appliances referred to have not been tested and therefore no guarantee can be given and that they are in working order. Internal photographs are reproduced for general information and it must not be inferred that any item shown is included with the property. For a free valuation, contact the numbers listed on the brochure.

Viewing by appointment only

Country Properties | 6, Brand Street | SG5 1HX

T: 01462 452951 | E: hitchin@country-properties.co.uk

www.country-properties.co.uk

