





- Quaint Detached Cottage
- Two Reception Rooms
- Modern Fitted Kitchen
- Two Bedrooms
- First Floor Bathroom
- Private Garden
- Outhouse/Utility Room

### Description

A quaint, detached cottage located in the heart of the village. The property is presented to a high standard and features gas central heating and PVCu double glazed windows and comprises: Two reception rooms and modern kitchen on the ground floor and two bedrooms and bathroom on the first floor. Externally there is a private rear garden and there is an outhouse, which is currently used as a utility room with plumbing for washing machine etc. The property is immediately available, restrictions apply.



**Location**  
**Tenure**

**EPC Rating: D**

**Important Notes**  
Type Here



## Ground Floor

Approx. 34.5 sq. metres (370.9 sq. feet)

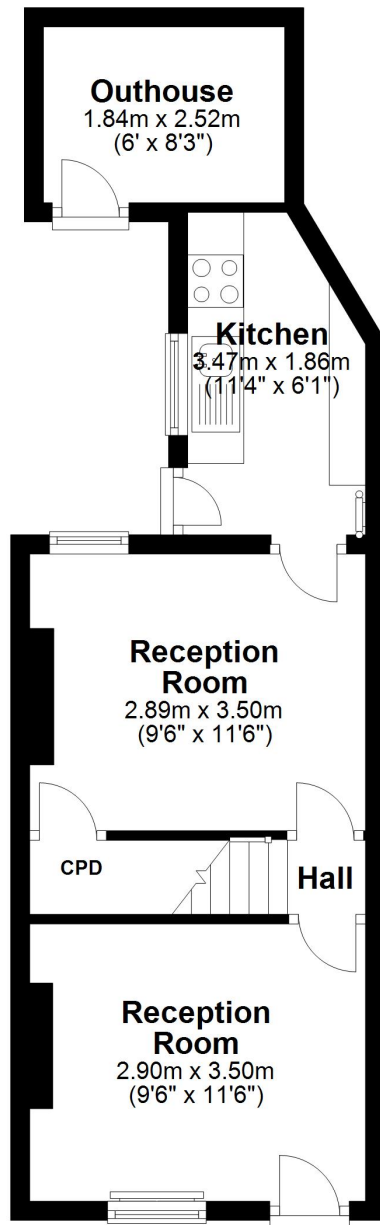

## First Floor

Approx. 23.7 sq. metres (254.9 sq. feet)

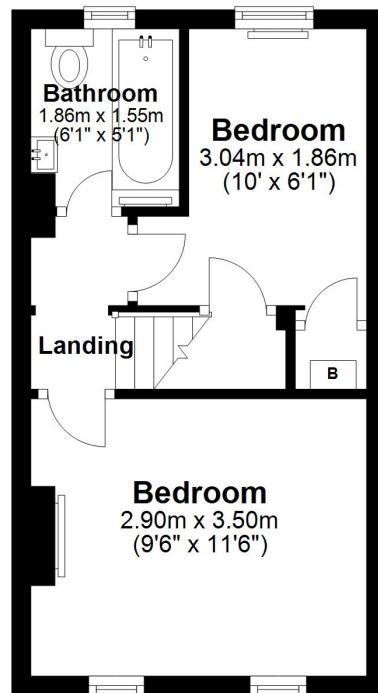

Total area: approx. 58.1 sq. metres (625.9 sq. feet)

