

Truuli



1 Parish Mews, Parish Lane, London, SE20

£300,000 Share of Freehold

- Share of freehold (900 + years remaining)
- Gated development
- Private front door
- Neutral décor throughout
- Bright and airy throughout
- Unique split level one bedroom
- Communal garden
- Allocated off street parking
- Close proximity to both Penge East & West railway & underground stations
- Close proximity to the HSBC sports ground, Cator Park & Alexandra sports & recreation grounds

2, Lansdowne Road, Croydon, London, CR9 2ER

Tel: 0330 043 0002

Email: save@truuli.co.uk Web: www.truuli.co.uk

1 Parish Mews, Parish Lane, London, SE20

£300,000 Share of Freehold

Guide price £300,000 - £325,000 Situated in this quiet and gated community, just off Parish Lane, is this unique split-level double-bedroom Victorian property which is located within close proximity to the green open expanses of Cator Park & Alexandra sports & recreation grounds.

The property is ideally positioned for quick access to both Penge East & West railway and underground stations making access to London Bridge & Victoria a very short commute for any perspective buyer who may work in Central London or the City.

Ground Floor
250 sq.ft. (23.2 sq.m.) approx.

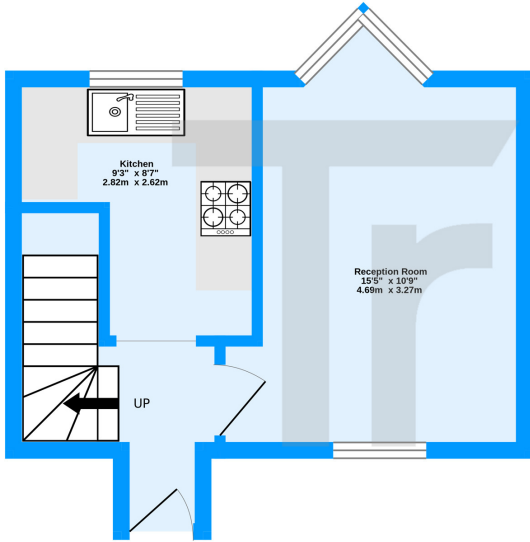

1st Floor
244 sq.ft. (22.7 sq.m.) approx.

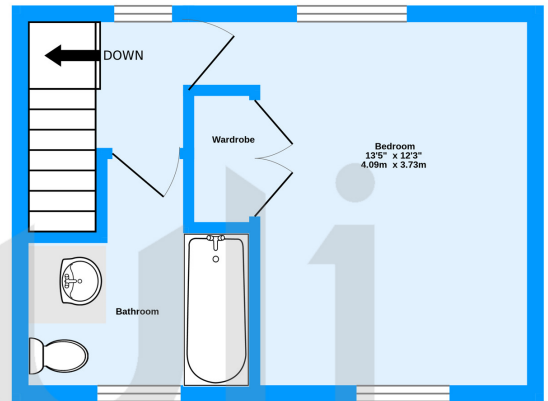

Parish Mews, Parish Lane, Penge, SE20

TOTAL FLOOR AREA : 494 sq.ft. (45.9 sq.m.) approx.

Measurements are approximate. Not to scale. Illustrative purposes only
Made with Metropix ©2023

