





Ripley Road, Heage, Belper, Derbyshire DE56 2HU
£550,000 - Freehold



PROPERTY DESCRIPTION

Derbyshire properties are delighted to introduce for sale this substantial four bedroom executive detached family home located in the popular village of Heage. We believe the property will ideally suit families and extended families and recommended an early internal inspection to avoid disappointment.

The property briefly comprises of:- reception hall, guest cloakroom/WC, large dining room, extended lounge, conservatory, playroom/study, kitchen and utility room. To the first floor a gallery landing provides access to:- huge master suite, dressing room (5th bedroom), en-suite, three additional bedrooms and family bathroom. Externally the property is positioned on a sizable plot with large frontage offering parking for numerous vehicles and providing access to an integral garage. The property also benefits from Solar panels with a feed in tariff. The superb rear garden benefits from a full width terrace, lawn and open countryside views to the rear.

POINTS OF INTEREST

- Executive Detached Family Home
- Huge Master Bedroom Suite
- Substantial Plot Overlooking Open Countryside
- Driveway & Double Garage
- Ideal For Families & Extended Families
- Guest Cloakroom/WC
- Spacious Rooms Throughout
- Landscaped Gardens
- COUNCIL TAX BAND F
- 4 Bedroom

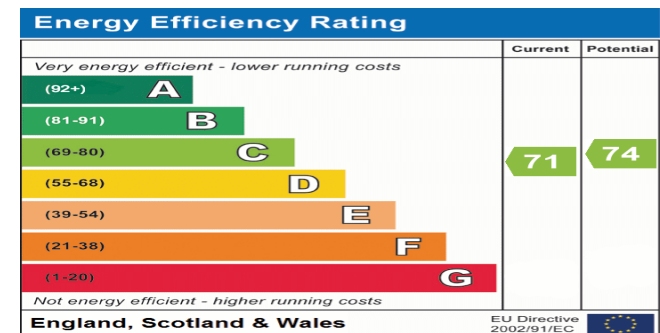

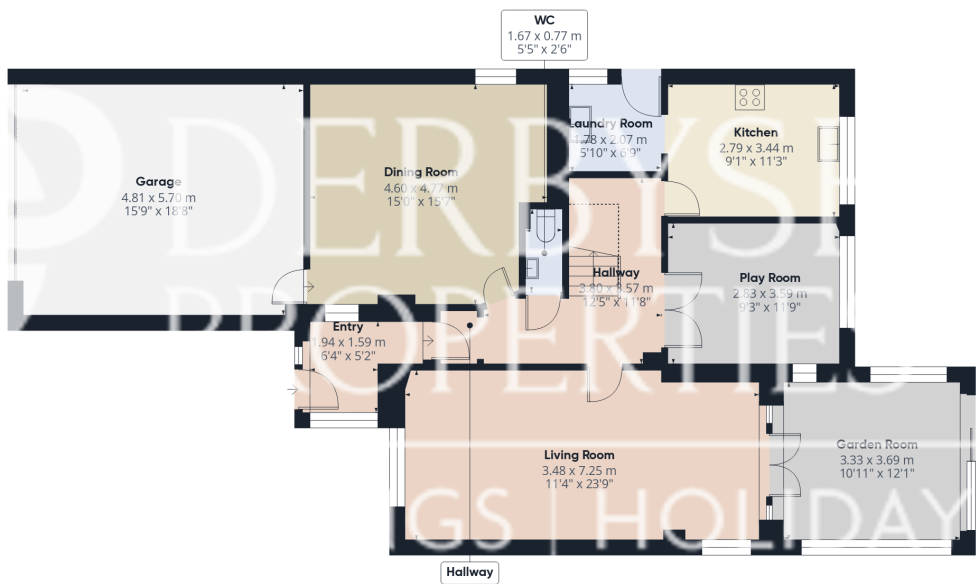

Ground Floor

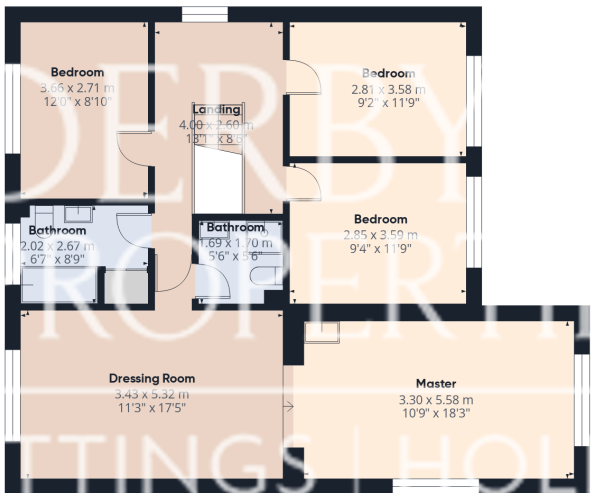

Floor 1

Approximate total area⁽¹⁾

210.1 m²
2263 ft²

Reduced headroom

1.5 m²
16 ft²

(1) Excluding balconies and terraces

Reduced headroom

..... Below 1.5 m/5 ft

While every attempt has been made to ensure accuracy, all measurements are approximate, not to scale. This floor plan is for illustrative purposes only.

Calculations are based on RICS IPMS 3C standard.

GIRAFFE360