



Northwick Road



Northwick Road Worcester

£200,000

Positioned within a desirable and picturesque location is this two bedrooms flat. The flat provides good access to the A449 as well as M5 motorway and comprises vestibule, hallway, sitting room, kitchen, two double bedrooms and bathroom. The property further benefits from garage and parking with pleasant communal gardens and must be viewed to appreciate the size, location and outlook of the property.

We've Noticed

- **Two bedroom apartment**
- **Desirable location**
- **Ideal First Time Buy or Investment Purchase**
- **Parking and garage**



Entrance

Through communal entrance door to subject flat with into vestibule with further door into hallway with doors into leading to sitting room, kitchen, bedrooms, shower room and storage.

Sitting Room

With radiator, large window and double glazed sliding doors with Juliet balcony overlooking rear communal gardens and greenery.

Kitchen

With matching wall and base units with work surfaces over, sink and drainer with mixer tap over, radiator, built-in oven and hob with cooker hood, integrated fridge/freezer as well as dishwasher and double glazed window.

Bedroom 1

With double glazed window, built-in storage and radiator.

Bedroom 2

With double glazed window and radiator.

Shower Room

With double glazed window, heated towel rail, WC, wash hand basin and bath with shower screen and shower over.

Outside

The property is approached via a drive with parking and garages for the flats. Outside are also communal garden spaces.

Leasehold Information

Length of lease =

Service charge =

Ground rent =



Apartment

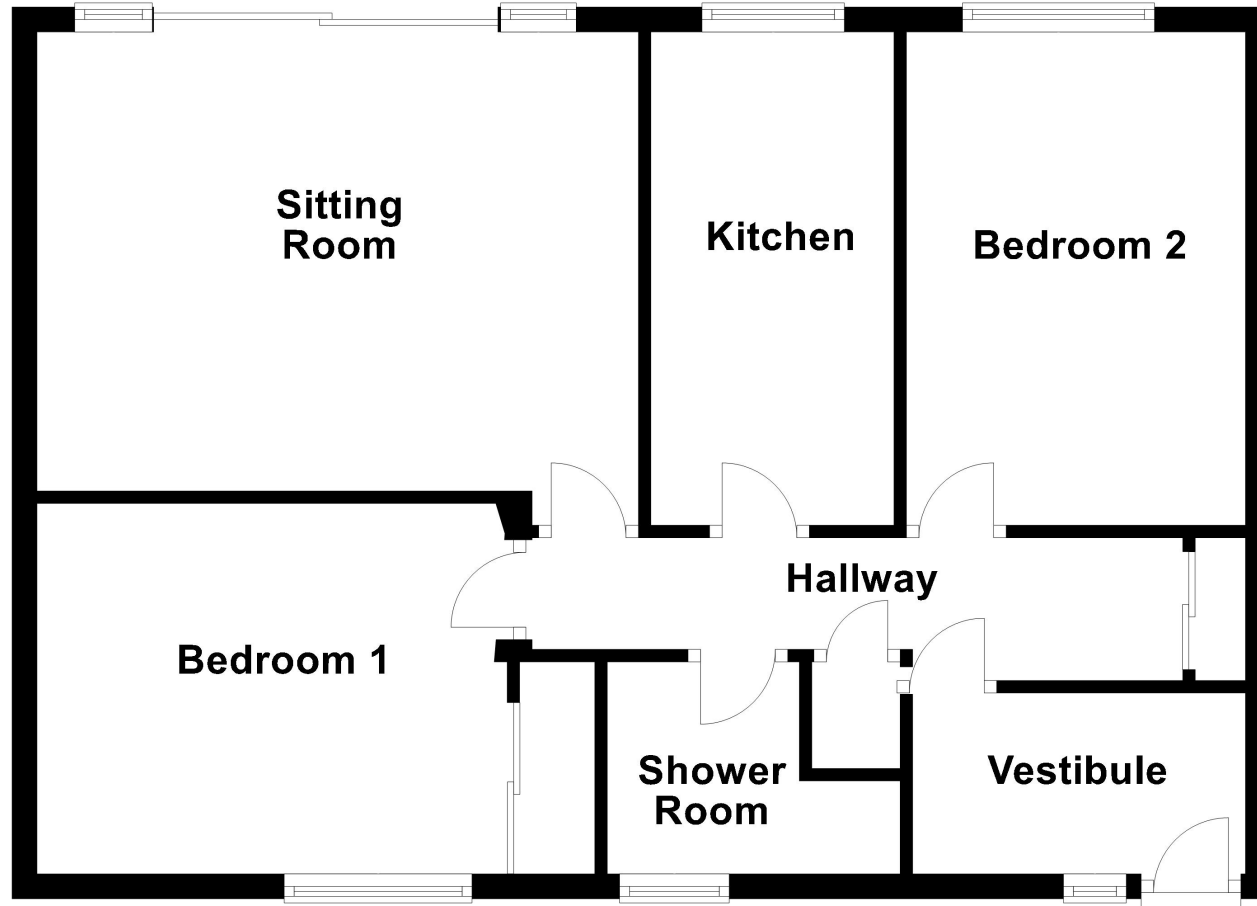

Energy Efficiency Rating		Current	Potential
Very energy efficient - lower running costs			
(92+)	A		
(81-91)	B		
(69-80)	C		
(55-68)	D		
(39-54)	E		
(21-38)	F		
(1-20)	G		
Not energy efficient - higher running costs			
		69	79
England, Scotland & Wales		EU Directive 2002/91/EC	

46 Foregate Street, Worcester WR1 1EE

Tel: 01905 723545 info@hillsestateagents.co.uk

www.hillsestateagents.co.uk

These particulars, whilst believed to be accurate are set out as a general outline only for guidance and do not constitute any part of an offer or contract. Intending purchasers should not rely on them as statements or representation of fact, but must satisfy themselves by inspection or otherwise as to their accuracy. We have not carried out a detailed survey nor tested the services, appliances and specific fittings. Room sizes should not be relied upon for carpets and furnishings. The measurements given are approximate. No person in this firm's employment has the authority to make or give any representation or warranty in respect of the property.

