

## Hollies Road, W5

Approximate Floor Area = 84.4 sq m / 908 sq ft

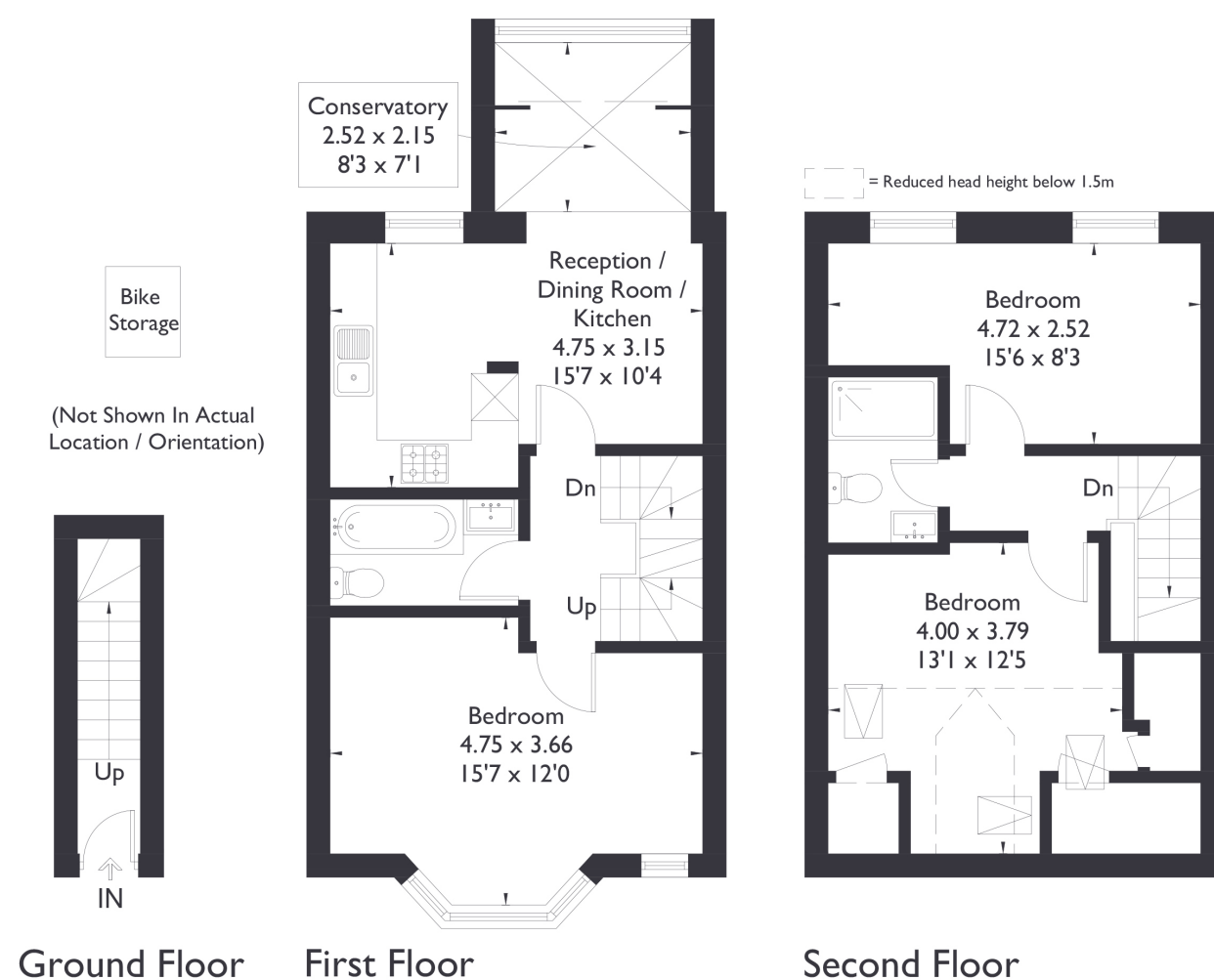

### 2 BEDROOM FLAT

## Hollies Road, W5

£600,000

Welcome to this newly renovated two bedroom, two bathroom first-floor flat in the heart of Ealing.

The property features three generously sized double bedrooms, two well-appointed bathrooms, and a bright open-plan kitchen and living area that flows seamlessly into a spacious conservatory — perfect for both everyday living and entertaining.

### FEATURES

- Two Bedrooms
- Two Bathrooms
- Open Plan Kitchen/Diner
- Little Ealing & Ealing Fields School Catchment
- Northfields Station
- Northfield Amenities
- EPC Rating B





## 2 BEDROOM FLAT

# Hollies Road, W5

Move-in ready, this flat offers both comfort and style in a fantastic location.

Just a 10-minute walk from Northfields Station and five minutes from a variety of local amenities, it also falls within the highly regarded Ealing Fields and Little Ealing school catchments.

EPC Rating B.

