

35 Holmcroft Court

Shepton Mallet, BA4 5FA

COOPER
AND
TANNER



£145,000

1 1 1 EPC C

Description

Description

Located in the popular Holmcroft Court retirement complex for the over 60's this spacious second floor apartment enjoys the use of the communal gardens, the laundry room, the well equipped hobbies/crafts room as well as the Resident's Lounge. Accessed by a lift the property comprises a spacious entrance hall with built in cupboards and doors leading off to the principal rooms - sitting/dining room with glazed door through to the fitted kitchen. The master bedroom has fitted mirror front wardrobes; the wet room with fitted vanity unit. There is underfloor heating throughout the property. AGENT'S NOTES: 125 year lease from June 2012. Monthly service charge £160. Half-yearly

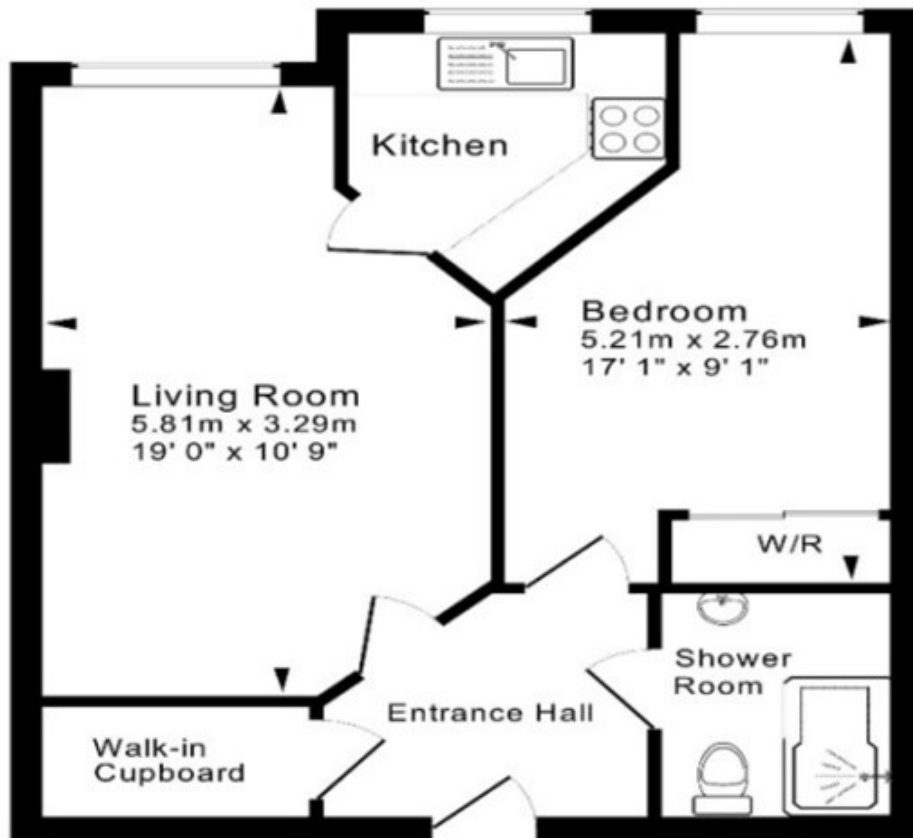

Features

- Deceptively spacious second floor apartment
- In the popular Holmcroft Court development
- with communal gardens, hobbies room, laundry and residents lounge
- Double bedroom
- Fitted kitchen with integrated appliances
- Sitting/dining room
- Modern wet room
- Underfloor heating throughout
- Parking permit available
- Internal viewing is recommended to appreciate this property

Local Information

- Council Tax Band B
- Tenure
- EPC Rating C

SHEPTON MALLET OFFICE
 Telephone 01749 372200
 32, High Street, Shepton Mallet, Somerset BA4 5AS
sheptonmallet@cooperandtanner.co.uk



Important Notice: These particulars are set out as a general outline only for the guidance of intended purchasers and do not constitute, nor constitute part of, an offer or contract. All descriptions, dimensions, reference to condition and necessary permissions for use and occupation, warranties and other details are given without responsibility and any intending purchasers should not rely on the m as statements or representations of fact but must satisfy themselves by inspection or otherwise as to the correctness of each of them.



