

Northcroft Road, W13

Approximate Gross Internal Area = 106.9 sq m / 1151 sq ft
(Including Reduced Headroom)

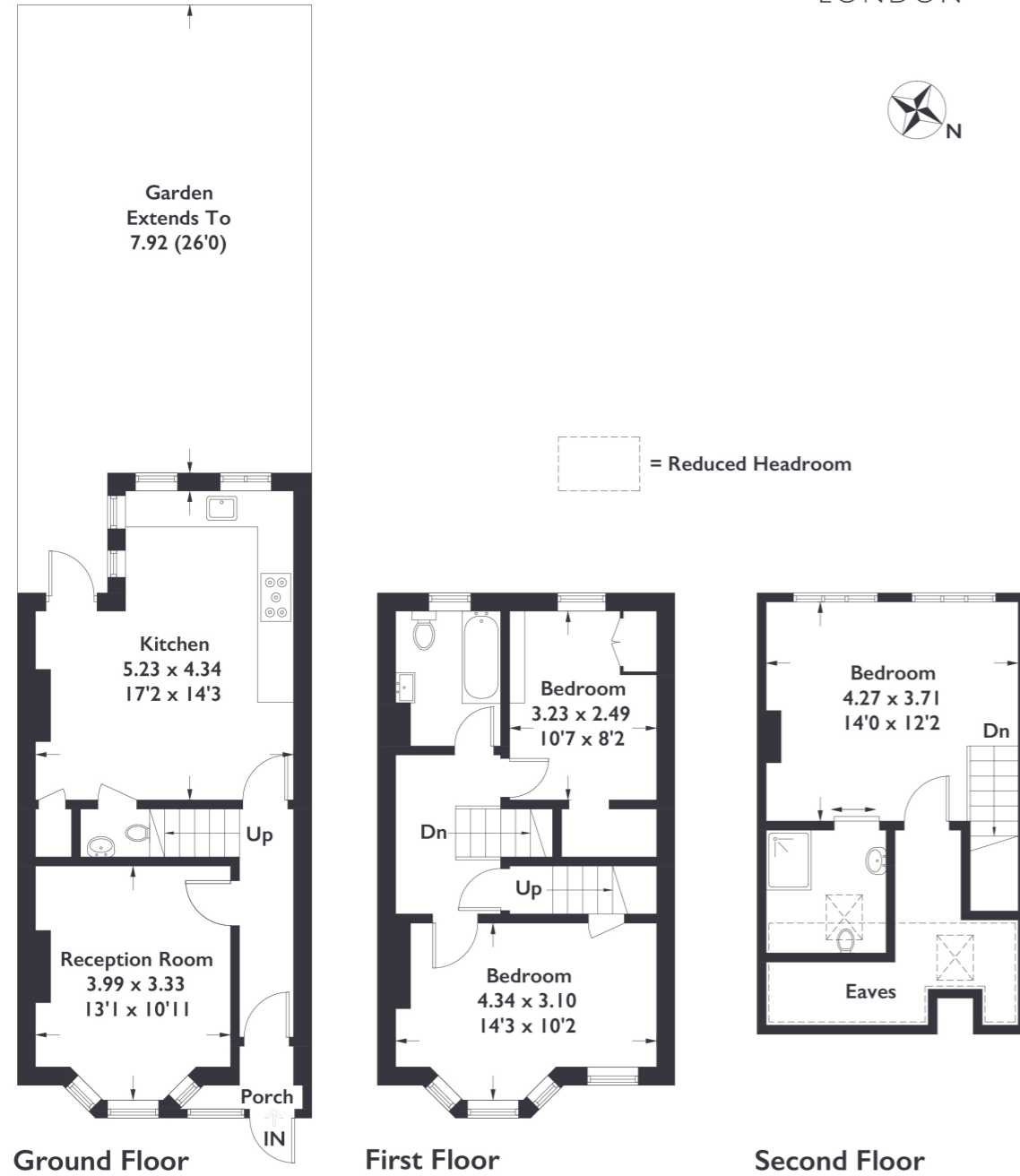

Measured in accordance with RICS Code of Measuring Practice. To be used for identification and guidance purposes only.



3 BEDROOM HOUSE

Northcroft Road, W13
£895,000

Welcome to this three bedroom terraced house, ideally situated in a prime location, offering a perfect blend of modern living and convenience. The open plan kitchen and dining area seamlessly extend to a charming garden, providing a delightful space for indoor-outdoor living. Additionally, a separate reception room offers versatility in lifestyle and entertaining.

FEATURES

- Freehold
- Three Bedrooms
- Two Bathrooms/Downstairs W/C
- Open Plan Kitchen/Dining
- Close To Local Amenities
- Northfields Station
- EPC Rating C



3 BEDROOM HOUSE

Northcroft Road, W13

With two bathrooms and a downstairs W/C, this residence ensures practicality for daily living. The house spans three floors, featuring a loft extension adorned with skylights, creating a bright and airy atmosphere throughout.

Nestled in a lovely locale, the property enjoys proximity to Northfields' local amenities, making daily life a breeze. Northfields station is just a ten minute walk away, providing easy access to transportation.

Notably, the house falls within the catchment area of Fielding Primary School, adding an educational advantage to its list of appealing features. This three bedroom terraced house embodies the epitome of comfortable and well connected living in a sought after location.

EPC rating C.

