



Asking Price
£525,000

CHURCH FARM COTTAGE, SIXPENNY HANDLEY, WILTSHIRE SP5 5ND

Freehold



- ◆ POPULAR VILLAGE LOCATION
- ◆ FULL UPDATING REQUIRED
- ◆ FOUR DOUBLE BEDROOMS
- ◆ SCOPE TO EXTEND (STPP)
- ◆ GENEROUS GARDEN AND GROUNDS
- ◆ DETACHED SINGLE GARAGE
- ◆ NO FORWARD CHAIN
- ◆ SOLE AGENTS

A rare opportunity to acquire a generous, four bedroom family home within the centre of this popular village, boasting tremendous potential and offers scope for extension (STPP).

Room Description

Church Farm Cottage sits within the heart of the village and offers very traditional accommodation which has already been extended, but there is tremendous scope for this to be explored further (STPP) and the home requires modernising throughout. The accommodation currently comprises of two formal reception rooms, kitchen and shower room to the ground floor, with two double bedrooms and family bathroom to the first floor and two further double bedrooms to the second floor. Furthermore, there is an attached barn style structure to the southerly elevation, which could be easily developed and incorporated into the existing home, and the cottage benefits from an original cellar which is ideal for cold and dry storage. There has been the addition of a conservatory to the principle reception room which also features a charming inglenook style fire place and the home benefits from oil fired heating.





Location

Sixpenny Handley is a thriving village located in north east Dorset situated on the Cranborne Chase, ten miles (16 km) from the town of Blandford Forum. The village has a store and butchers shop, workshop garage and doctor's surgery. The village recreation field area includes a car park, sports pavilion, cricket pitch, football field, tennis court, bowling green, skate park and play park. The parish church of St Mary dates from the 14th century and is central to the village. Sixpenny Handley also has a first school which takes children for reception and years one to four.

Gardens and Grounds

The front garden has primarily been laid to hard standing and boasts generous parking for several vehicles. In turn, this space gives access to the detached single garage with up-and-over style door. The rear garden wraps around three elevations of the home and is primarily laid to lawn and mature shrubs and borders.



Size: 2242 sq ft (208.3 sq m)

Heating: Oil fired heating

Glazing: Mixed glazed

Parking: Driveway & detached single garage

Garden: South East

Main Services: Electric, water, drains, telephone

Local Authority: Dorset Council

Council Tax Band: F





GROUND FLOOR
1229 sq.ft. (114.1 sq.m.) approx.

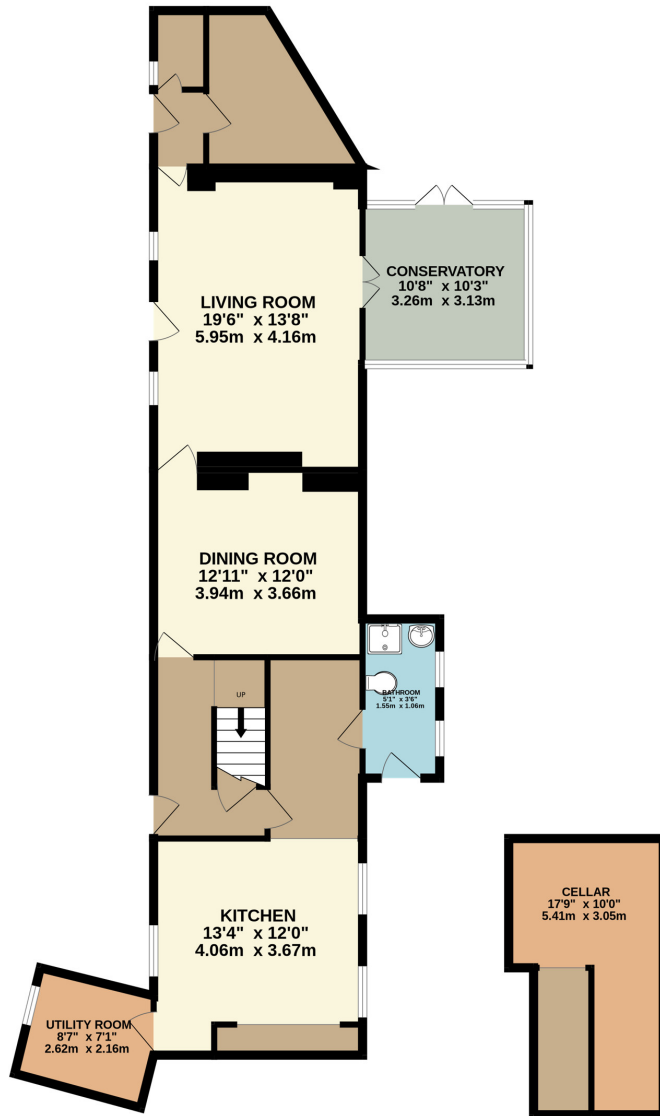

1ST FLOOR
507 sq.ft. (47.1 sq.m.) approx.

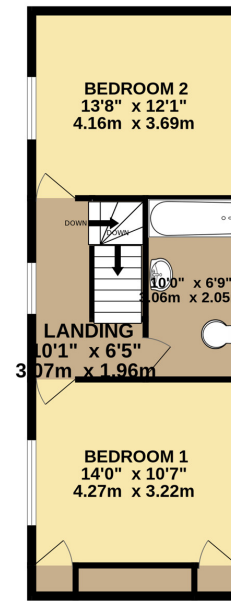

2ND FLOOR
507 sq.ft. (47.1 sq.m.) approx.

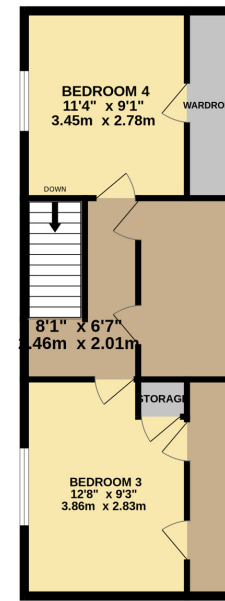

TOTAL FLOOR AREA : 2242 sq.ft. (208.3 sq.m.) approx.
Measurements are approximate. Not to scale. Illustrative purposes only
Made with Metropix ©2023

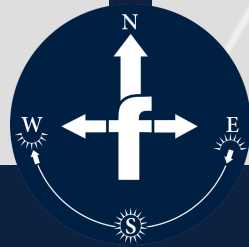
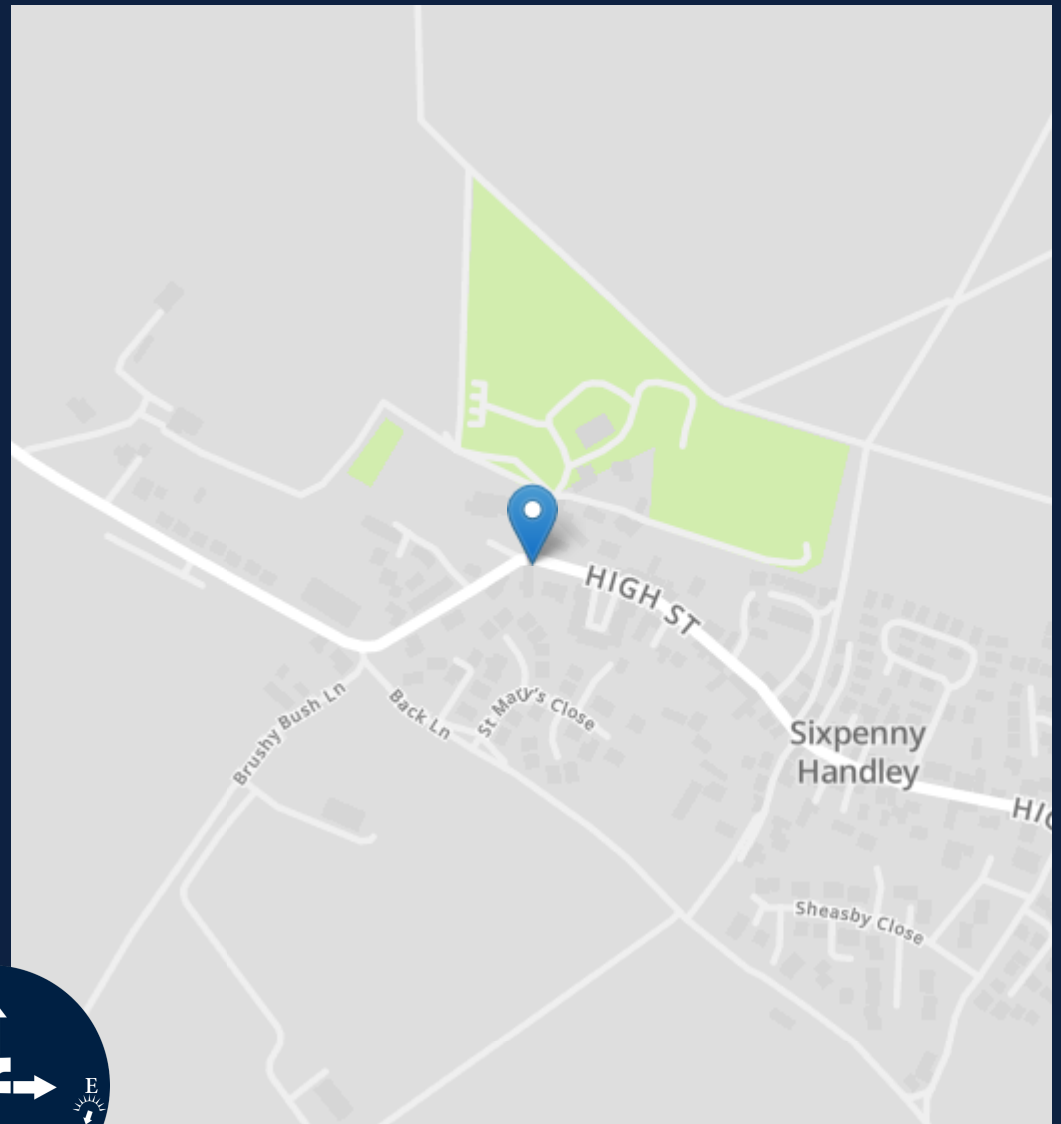
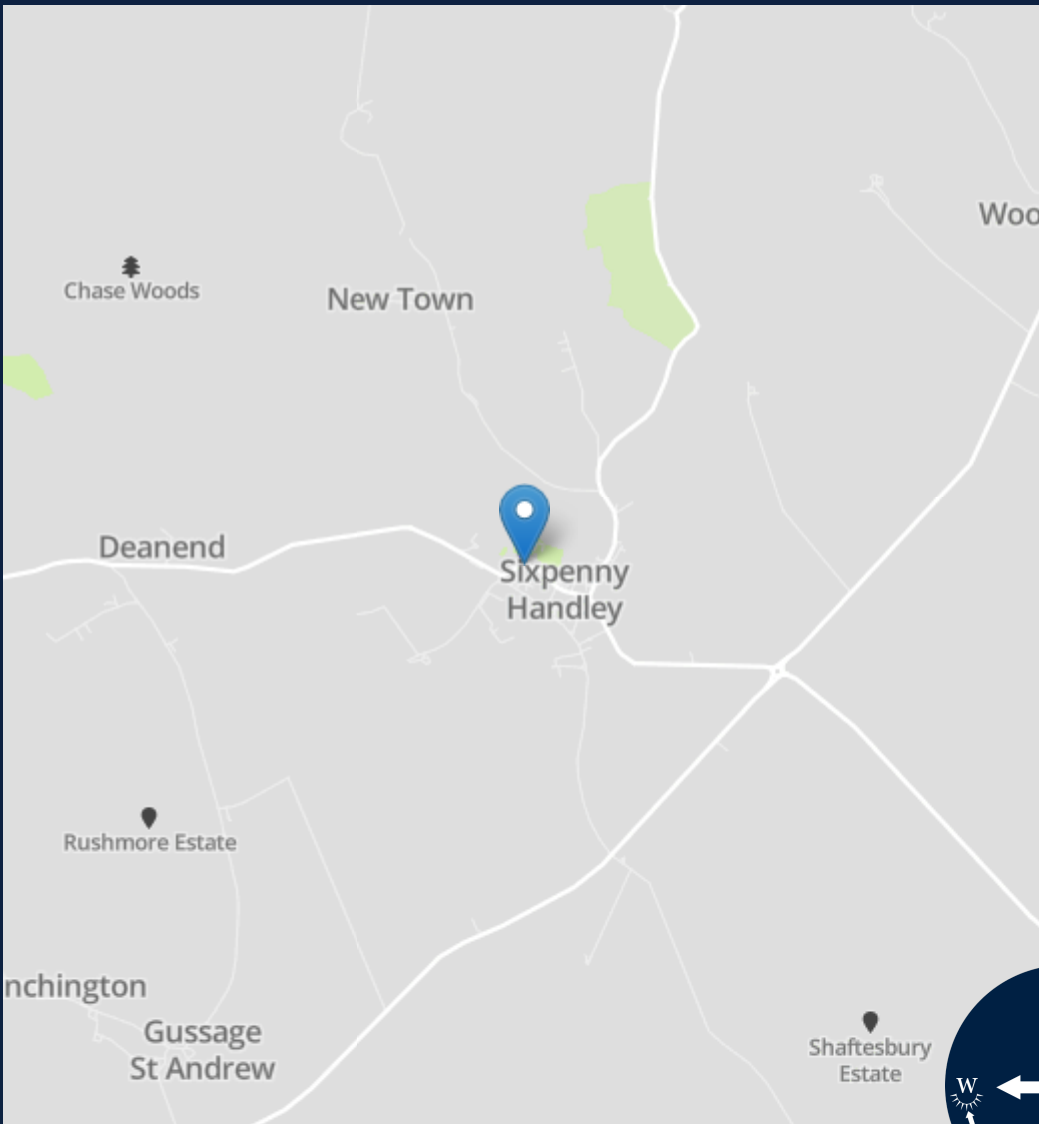

Energy Efficiency Rating		Current	Potential
Very energy efficient - lower running costs			
(92-100)	A		
(81-91)	B		
(69-80)	C		
(55-68)	D		
(39-54)	E		54
(21-38)	F		
(1-20)	G		
Not energy efficient - higher running costs			
England, Scotland & Wales		EU Directive 2002/91/EC	



Important notice: Fisks Estate Agents, their clients and any joint agents give notice that 1: They are not authorised to make or give any representations or warranties in relation to the property either here or elsewhere, either on their own behalf or on behalf of their client or otherwise. They assume no responsibility for any statement that may be made in these particulars. These particulars do not form part of any offer or contract and must not be relied upon as statements or representations of fact. 2: Any areas, measurements or distances are approximate. The text, photographs and plans are for guidance only and are not necessarily comprehensive. It should not be assumed that the property has all necessary planning, building regulation or other consents and Fisks Estate Agents have not tested any services, equipment or facilities. Purchasers must satisfy themselves by inspection or otherwise.

fisks

ESTATE AGENTS CHARTERED SURVEYORS

12 East Street, Wimborne,

Dorset, BH21 1DS

www.fisksestateagents.co.uk

01202 880000