

27 Nearne Way

Folkestone
CT20 3XB

£400,000 FREEHOLD

FOR SALE WITH BURNAP + ABEL... Welcome to this stunning 4-bedroom semi-detached home located on Nearne Way in the desirable seaside town of Folkestone. As you step inside, you are greeted by a spacious lounge/diner perfect for entertaining guests or relaxing with family. The kitchen/breakfast room is a culinary enthusiast's dream with modern appliances and ample storage space. The ground floor also features a convenient WC. Upstairs, you will find four well-appointed bedrooms, including an en-suite in the master bedroom. The family bathroom offers both style and functionality for everyday living. The west-facing rear garden is ideal for enjoying summer evenings with loved ones and offers privacy and tranquility. This property also boasts two off-road parking spaces, making parking a breeze. With NHBC guarantee for peace of mind, this home truly has it all. Don't miss your chance to make Nearne Way your new address – schedule a showing today!



Entrance Hall

Lounge/Dining Room

13' 11" x 12' 7" (4.24m x 3.84m)

W.C

Kitchen

12' 4" x 8' 10" (3.76m x 2.69m)

First Floor Landing

Bedroom One

13' 11" x 12' 8" (4.24m x 3.86m)

Family Bathroom

7' 1" x 6' 2" (2.16m x 1.88m)

Bedroom Two

9' 5" x 7' 1" (2.87m x 2.16m)

Second Floor Landing

Master Bedroom

13' 11" x 12' 8" (4.24m x 3.86m)

En-Suite

Bedroom Three

14' 0" x 7' 9" (4.27m x 2.36m)

Rear Garden

2 x Allocated Parking Bays

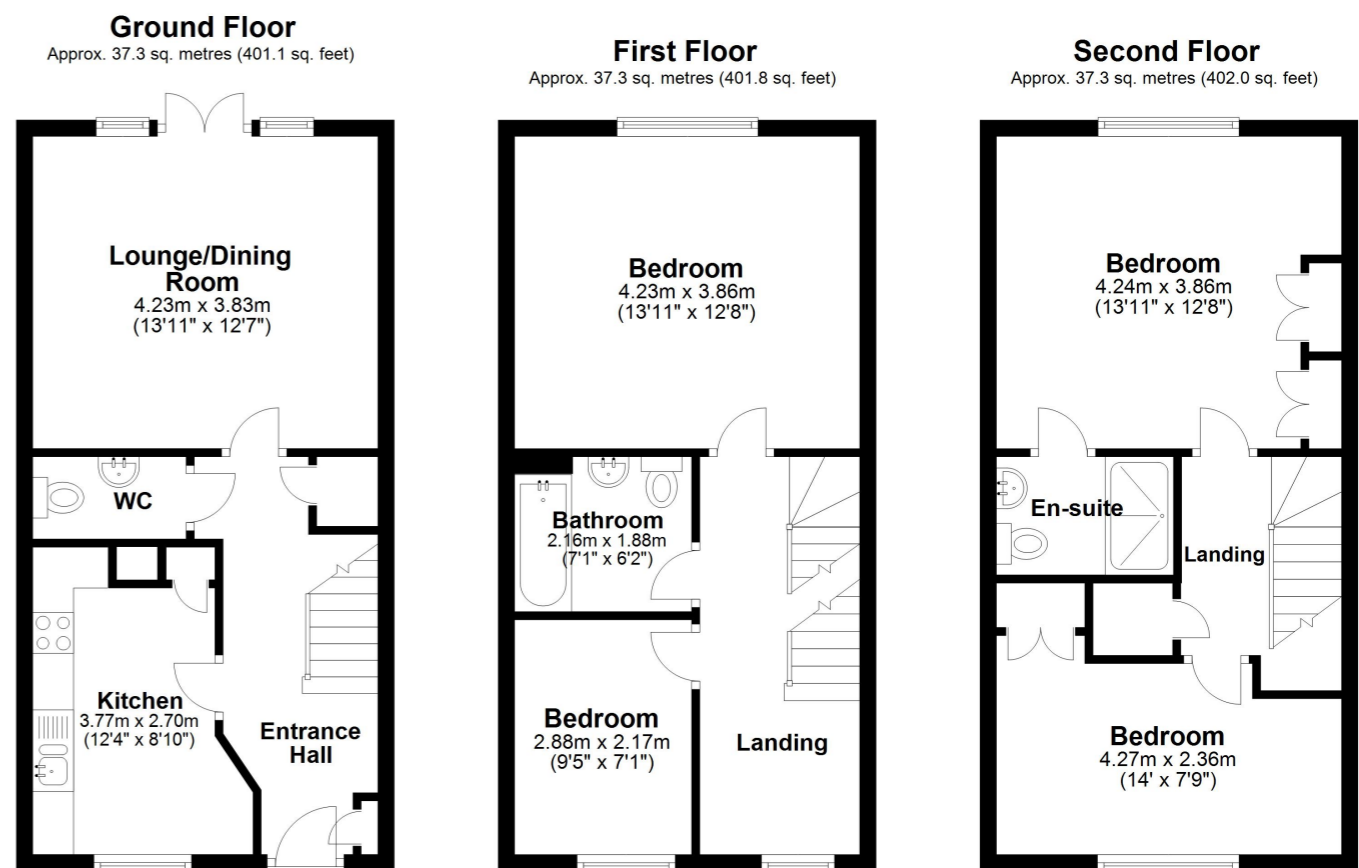

Whilst every attempt has been made to ensure the accuracy of the floor plan contained here, measurements of doors, windows, rooms and any other items are approximate and no responsibility is taken for any error, omission or mis-statement. This plan is for illustrative purposes only and should be used as such by any prospective purchaser.
Plan produced using PlanUp.

