

Truuli



Damson House, Hemlock Close, London, SW16

£300,000 Leasehold

- Internal storage cupboards
- En suite shower room to primary bedroom
- Large and inviting kitchen reception room
- Allocated parking space
- Close proximity to all local transport and amenities
- Three mainline stations within easy access
- Guide price £300,000 - £325,000

2, Lansdowne Road, Croydon, Surrey, CR9 2ER

Tel: 0330 043 0002

Email: save@truuli.co.uk Web: www.truuli.co.uk

Damson House, Hemlock Close, London, SW16

£300,000 Leasehold

*** Guide price £300,000 - £325,000 *** A lovely, larger-than-average two double bedroom ground floor modern apartment for sale, situated on a popular residential development within close proximity to the amenities of Streatham Common and Norbury.

Ground Floor

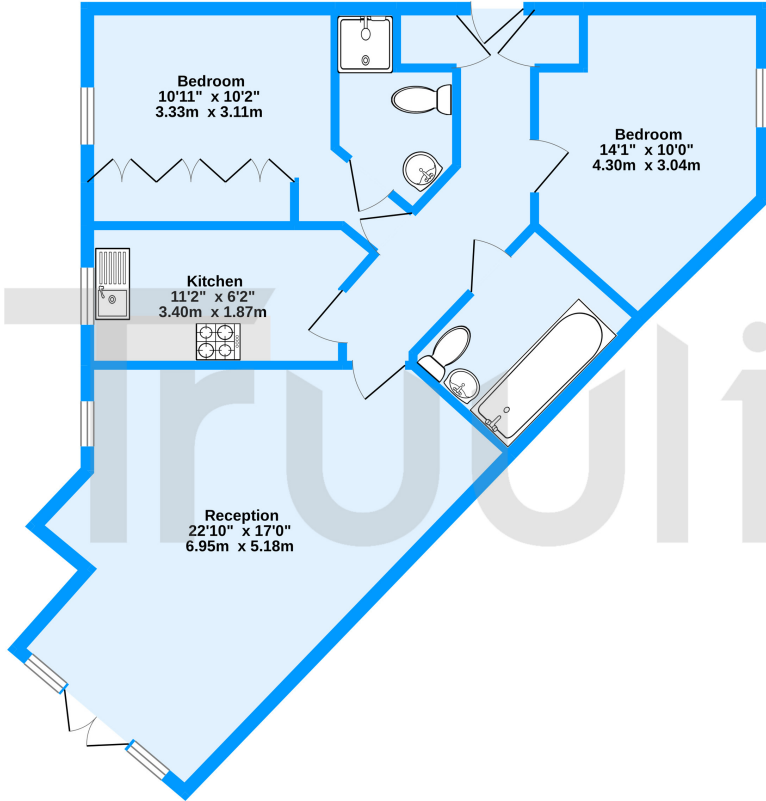

Damson House, Hemlock Close, SW16
TOTAL FLOOR AREA: 818sq.ft. (76.0 sq.m) approx.
Measurements are approximate. Not to scale. Illustrative purposes only
Made with Metropix ©2022

