

Henslow Road, Ipswich

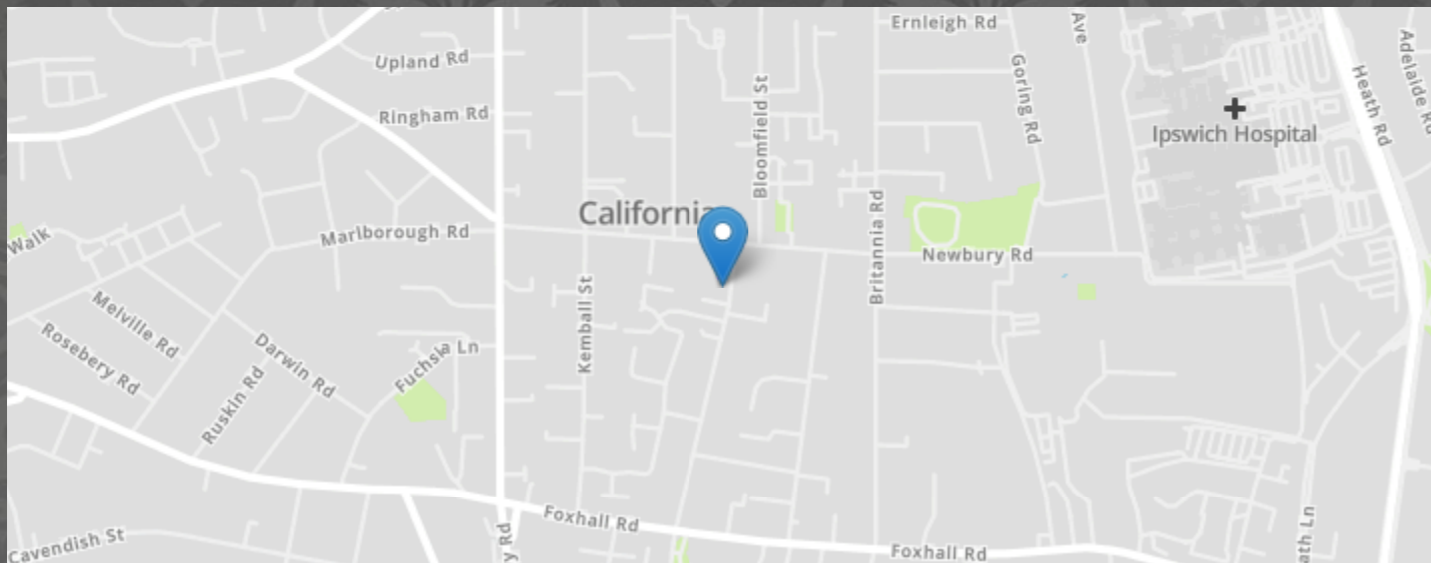

- OFF ROAD PARKING
- DOUBLE GLAZING
- NEW CARPETS
- EAST IPSWICH
- WELL PRESENTED

- GARDEN
- TWO BEDROOMS
- CLOSE TO AMENITIES
- CLOSE TO SCHOOLS
- ELECTRIC RADIATOR

MARKS & MANN



Henslow Road, Ipswich

We are pleased to be marketing this exceptionally well kept and well presented two bedroom home for sale. The property is positioned in an ideal location close to schools and amenities.

Internally the property benefits from, to the ground floor: Dining room, living room and kitchen. To the first floor: Landing, bedroom one, bedroom two and the bathroom. Externally the property benefits from, off road parking to the front aspect and a well presented garden to the rear.

Call now to register your interest and arrange a private first hand viewing.

£210,000 Offers in Excess of

MARKS & MANN

99-101 Penshurst Rd, Ipswich, Suffolk, IP3 8QB.

01473 396 296

contactipswich@marksandmann.co.uk

Website www.marksandmann.co.uk

Henslow Road, Ipswich

Ground Floor

Front Garden

Hard standing providing off road parking.

Entrance Door

Double glazed door.

Dining Room

10' 6" x 11' 6" (3.21m x 3.50m)
Double glazed window to front. Feature fireplace. Electric radiator.

Lounge

10' 6" x 11' 7" (3.20m x 3.52m)
Window to rear. Electric radiator. Stairs leading to first floor.

Kitchen Area 1

8' 10" x 6' 11" (2.70m x 2.10m)
Double glazed door to side aspect. Double glazed window to side aspect.
Space for fridge and freezer. Storage cupboard under stairs. Arch leading to

Kitchen Area 2

Double glazed window to rear aspect. Single drainer sink unit with mixer tap.
Tiled splashback. Fitted oven. Fitted gas hob. Extractor hood.

Side Lobby

Double glazed door to rear aspect.

First Floor

Landing

Loft access.

Bedroom One

10' 5" x 11' 7" (3.18m x 3.52m) (to back of wardrobes)
Two double glazed windows to front. Electric radiator. Built in wardrobes.

Bedroom Two

10' 8" x 8' 8" (3.24m x 2.64m)
Double glazed window to rear aspect. Electric radiator.

Bathroom

Double glazed window to rear aspect. Panel bath with shower over. Low level WC. Hand wash basin. Heated towel rail.

Location

Ipswich is a town with lots to offer including restaurants, cinema, plenty of activities, Ipswich football stadium and the town centre which offers a wealth of amenities.

Directions

Using a SatNav, please use IP4 5EG as a point of destination.

Important information

Tenure - Freehold
Services - we understand that mains electricity, water and drainage are connected to the property.
Council Tax Band - A
EPC rating: TBC

Disclaimer

In accordance with Consumer Protection from Unfair Trading Regulations, Marks and Mann Estate Agents have prepared these sales particulars as a general guide only. Reasonable endeavours have been made to ensure that the information given in these particulars is materially correct but any intending purchaser should satisfy themselves by inspection, searches, enquiries and survey as to the correctness of each statement. No statement in these particulars is to be relied upon as a statement or representation of fact. Any areas, measurements or distances are only approximate.
New build properties - the developer may reserve the right to make any alterations up until exchange of contracts.

Money Laundering Regulations

Intending purchasers will be asked to produce identification documentation at a later stage and we would ask for your co-operation in order that there will be no delay in agreeing the sale.

Council Tax Band

At the time of writing the council tax band for this property is band A.

Henslow Road, Ipswich

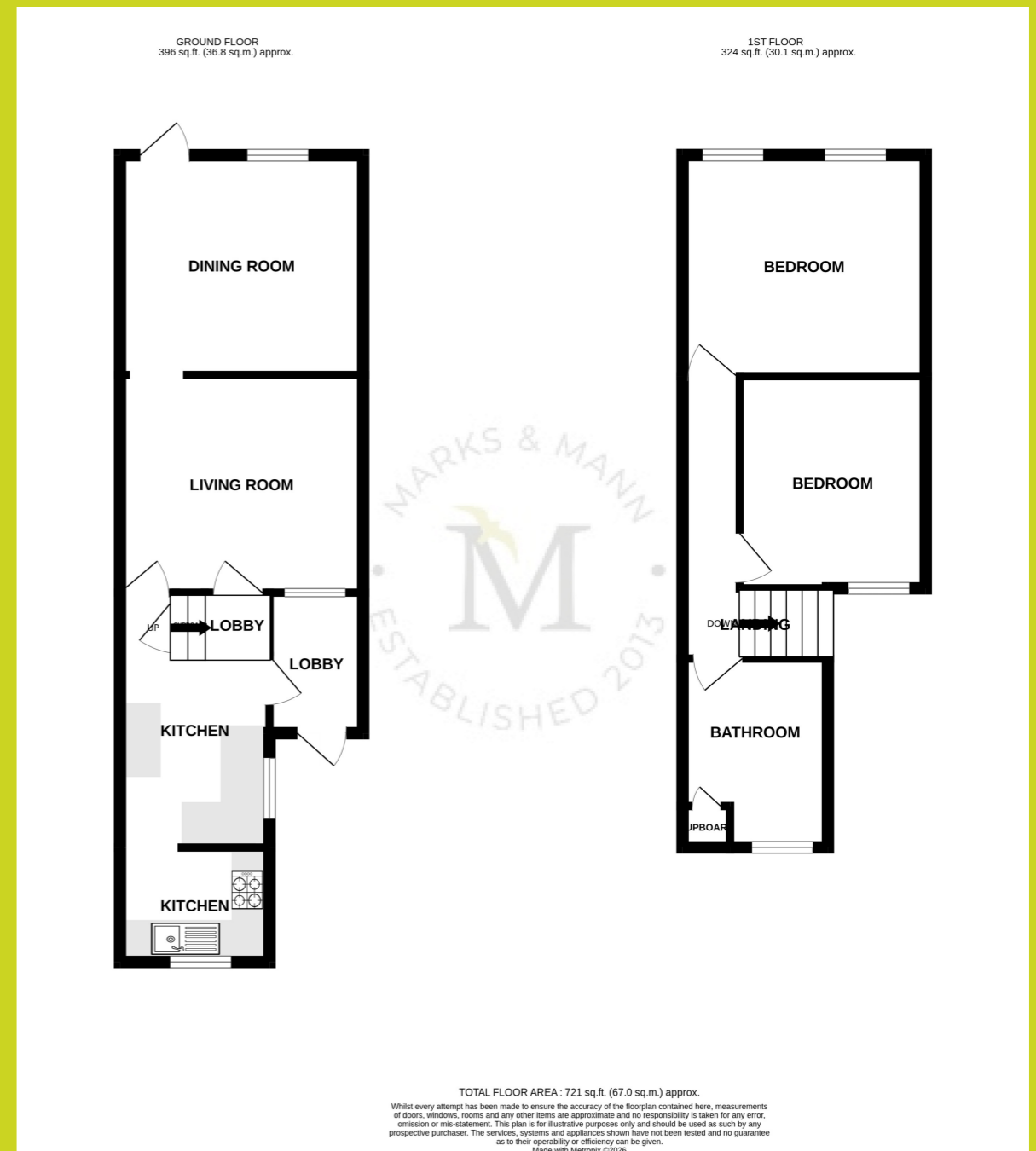

The above floor plans are not to scale and are shown for indication purposes only.

