



Three Bedroom Semi-Detached House
Windsor Road, Gillingham, Kent, ME7 4PS

Offers in Excess of £325,000
Freehold

Windsor Road, Gillingham, Kent, ME7 4PS

Offers in Excess of £325,000

Freehold

Description

This fantastic three bedroom semi detached home in central Gillingham, could be a great first time purchase or your next step on the property ladder and with the bonus of off street parking it will be popular! Externally there is a gated front garden with hedging and established shrubs, internally you are welcomed into hallway with handy downstairs W.C, a generous lounge which leads to the kitchen/dinner with French doors opening onto a great size garden, which is ideal for entertaining, provides rear access and is next to the car port. The first floor comprises of a family bathroom with shower over bath, three well-proportioned bedrooms, with bedrooms 1 & 2 being doubles and offering ample space for storage. Well maintained and with a neutral decor throughout, internal viewing is highly recommended, so call Greyfox Sales & Lettings in Rainham to book your viewing slot now!

Key Features

- Great First Time Purchase
- Three Good Size Bedrooms
- Semi Detached House
- Close to Gillingham Train Station & Local Amenities
- Downstairs W.C
- Upstairs Bathroom
- Car Port
- Garden measuring approx. 29.3ft x 19ft

Local Area

Gillingham is located within the Medway towns and offers railway links to central London and Ebbsfleet International and road connections to the A2/M2, M25 and M20. In addition to its town centre Gillingham offers a host of amenities including ice skating, country parks, an outdoor pool, a golf course, Medway Park Sports Centre and more.

GROUND FLOOR
385 sq.ft. (35.8 sq.m.) approx.

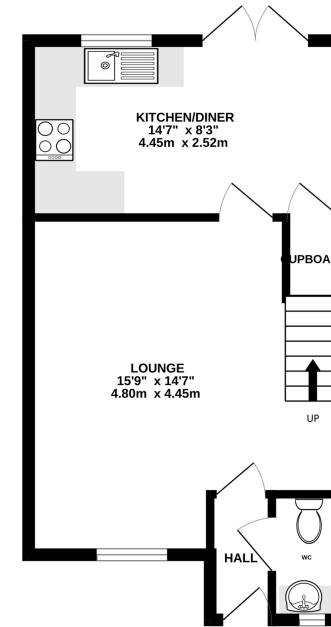

1ST FLOOR
360 sq.ft. (33.4 sq.m.) approx.

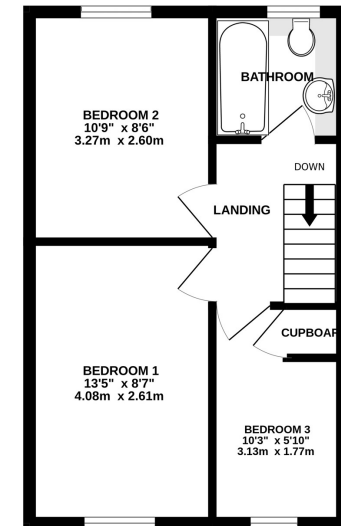

TOTAL FLOOR AREA : 745 sq.ft. (69.2 sq.m.) approx.

Whilst every attempt has been made to ensure the accuracy of the floorplan contained here, measurements of doors, windows, rooms and any other items are approximate and no responsibility is taken for any error, omission or mis-statement. This plan is for illustrative purposes only and should be used as such by any prospective purchaser. The services, systems and appliances shown have not been tested and no guarantee as to their operability or efficiency can be given.
Made with Metropix ©2023



Property Location

Windsor Road, Gillingham, Kent, ME7 4PS

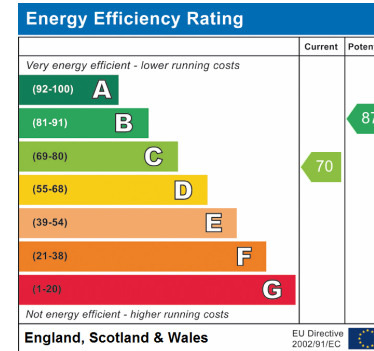
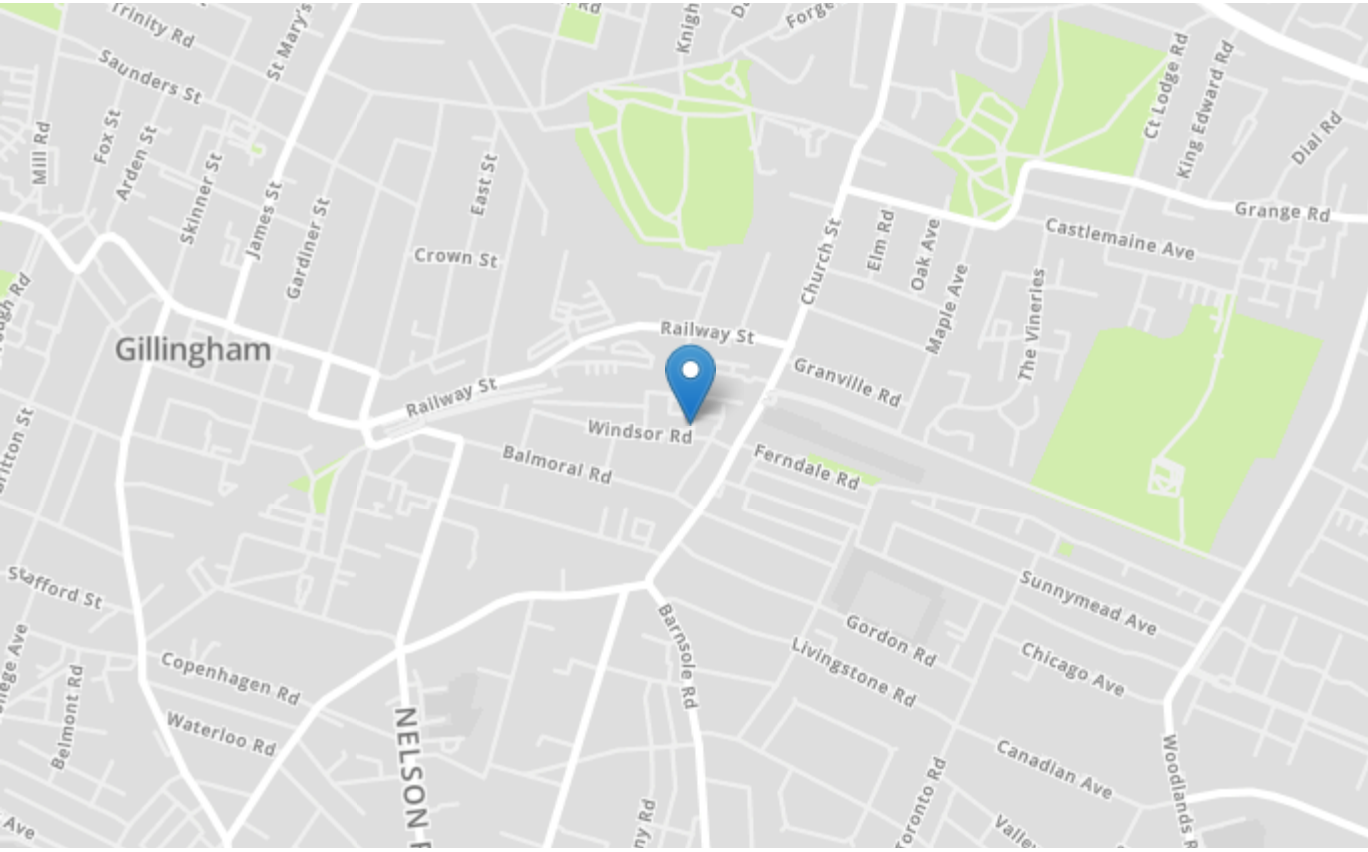

Tenure	Freehold
Lease Term	N/A
Ground Rent	N/A
Service Charge	N/A
Local Authority	Medway
Council Tax	Band C

Greyfox Walderslade

Unit 2, Thetford House
Walderslade Village Centre
Walderslade Road
Chatham
Kent
ME5 9LR
Tel: 01634 672227 Email:
walderslade@greyfox.co.uk

Greyfox Rainham

67C High Street
Rainham
Kent
ME8 7HS
Tel: 01634 377737 Email:
rainham@greyfox.co.uk

Agent Notes

These particulars are prepared as a general guide to a broad description of the property and should not be relied upon as a statement or representation of fact and do not constitute part of an offer or contract. The seller does not make or give nor do our employees or Greyfox have authority to make or give any representation or warranty to the property. We have not carried out a structural survey and the services, appliances and specific fittings have not been tested. All photographs, measurements, floorplans and distances referred to are given as a guide only and should not be relied upon for the purchase of carpets or any other fixtures or fittings. Lease details, service charges and ground rent (where applicable) and council tax are given as a guide only and should be checked and confirmed by you on inspection and your solicitor prior to exchange of contracts. If there are any points of particular importance to you we will be pleased to check the information for you and to confirm that the property remains available. This is particularly important should you be travelling some distance to view and where statements have been made by us to the effect that the information has not been verified. The copyright of all details, photographs and floorplans remain exclusive to Greyfox. For details of our privacy policy and referral fee arrangements with any of our selected partner companies please visit <https://www.greyfox.co.uk/legal/privacy> and <https://www.greyfox.co.uk/referral-fees>.