

Coronation Street, Barnstaple
£675 pcm

John
Smale & Co.

Chartered Surveyors | Residential & Commercial Consultants



- Two Double Bed Terraced House
- 2 Reception Rooms
- Rear Courtyard
- No Pets, No Smokers, Employed Only

- Popular Location
- Modern Bathroom
- Rent - £675pcm Deposit £775

A two bedroom terraced house located in a short walking distance to Barnstaple Town high street. Accommodation comprises of 2 double bedrooms, large modern bathroom with bath and shower, 2 reception rooms, modern fitted kitchen and private rear courtyard. This is in a ideal location and benefits from gas central heating and double glazing throughout. Permit parking. Employed only. no smokers, Available now. Rent £675 Deposit £775. Fees apply.

Ground Floor

Lounge

4.11m x 3.29m (13' 6" x 10' 10")

Reception Room 2

4.65m x 3.51m (15' 3" x 11' 6")

Kitchen

3.59m x 2.55m (11' 9" x 8' 4")

1st Floor

Bathroom

3.13m x 2.48m (10' 3" x 8' 2")

Bedroom

4.44m x 3.34m (14' 7" x 10' 11")

Bedroom 2

4.68m x 2.62m (15' 4" x 8' 7")

Services

Council Tax B

Gas, Electric, Water mains

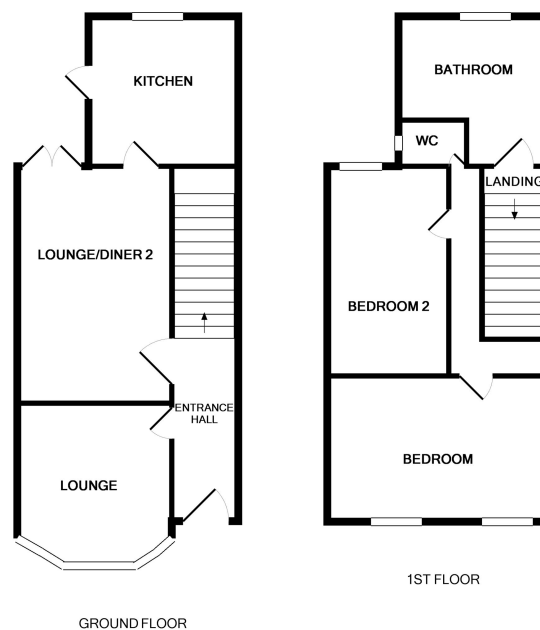

Made with Metropix ©2017

At John Smale & Co we don't just sell houses! ...

Contact us now for information on all of our other services including Residential and Commercial Lettings, Property Management, Commercial Property Sales, Probate Valuations, Independent Financial Advice, Energy Performance Certificates, Auctions and New Homes.

These particulars have been prepared for guidance only. We have not carried out a detailed survey, not tested the services, appliances or specific fittings. Floor plans are not drawn to scale unless stated, measurements and distances are approximate only. Do not rely on them for carpets and furnishings. Photographs are not necessarily current and you should not assume that contents shown are included in the sale.