



13/5, Wardlaw Place, Edinburgh, EH11 1UD

Light & Well-Presented, One-Bedroom, First Floor Flat

Up to date price and viewing info at mov8realestate.com/property

espc rightmove[®] find your happy Zoopla

Property Description

Light and well-presented, one-bedroom, first-floor flat, forming part of a traditional stone-built tenement. Conveniently located in the popular Gorgie area, west of Edinburgh city centre. Comprises an entrance hall, a living/dining room and kitchen, a double bedroom, and a separate WC and shower.

With light neutral decor throughout, features include a stylish fitted kitchen, tall ceilings, double glazing and gas central heating.

Further features include good storage provision, including a large bedroom wardrobe, and a secure entry system.

Externally, there is a shared garden to the rear, and zoned parking to the front and the surrounding streets.

A welcoming entrance hall affords access throughout the property, including a convenient storage cupboard. A bright open-plan living/dining room and kitchen features carpeted flooring for the lounge/dining area, and wood effect for the kitchen area. To the rear of the room, a stylish kitchen is fitted with modern units, marble-effect worktops, a sink with a drainer, a tiled surround, an integrated hob and oven, and a freestanding fridge/freezer and washing machine.

A generous double bedroom is finished with neutral decor, carpeted flooring and a large fitted wardrobe. While completing the accommodation, a separate shower is set internally off the hall, and a WC has a window and a two-piece suite.

An ideal starter home or buy-to-let opportunity, within a superb location offering excellent local amenities and public transport.



13/5 Wardlaw Place, Edinburgh, EH11 1UD

Approximate Gross Internal Area: (403 sq ft - 37 sq m.)

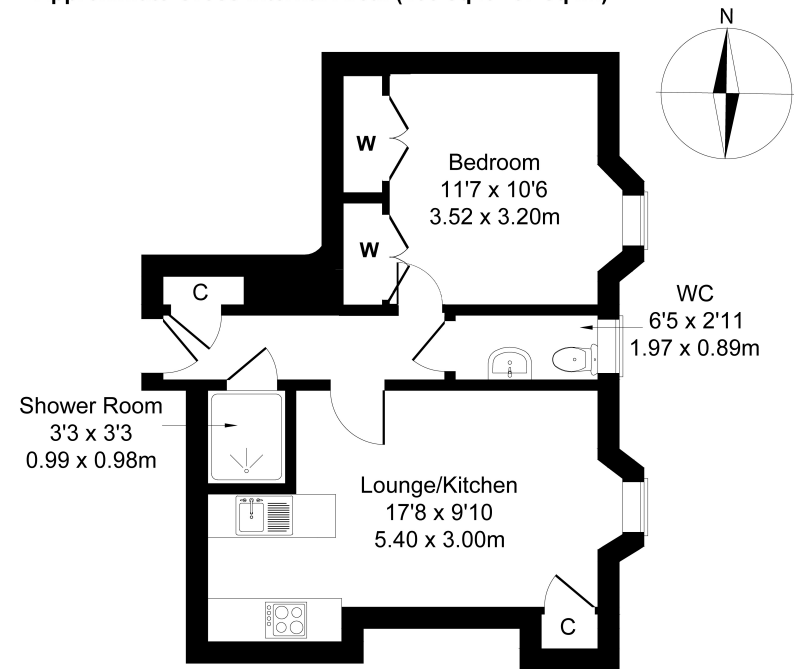

Legal Disclaimer : Floor-plan and measurements are for illustrative guidance only, and not intended to form part of any contract.

Area Description

Located just west of Edinburgh's city centre, Gorgie is a vibrant and historic district known for its traditional stone-built tenements and strong sense of community. Gorgie Road serves as a lively hub, offering a wide range of local amenities including a Sainsbury's, an ALDI, and a 24-hour ASDA superstore nearby at Chesser. The area is also home to Heart of Midlothian Football Club and offers a variety of leisure facilities such as Gorgie

Farm, Dalry swimming pool, Craiglockhart Sports Centre, and Fountain Park, which features a multi-screen cinema, gym, and numerous dining options. Excellent public transport links are available via frequent bus services on Gorgie Road, while Haymarket Station, Napier University, Heriot-Watt University, and Edinburgh College are all easily accessible.





Our Services

-  Free pre-sale property valuations
-  Great value fixed estate agency fees
-  Extensive buyer matching database
-  Purchase and sale conveyancing

Contact Us

0345 646 0208

sales@mov8realestate.com

www.mov8.com

Head Office

6 Redheughs Rigg, Edinburgh, EH12 9DQ

Glasgow Office

77 Renfrew Street, Glasgow, G2 3BZ



Estate Agents and Solicitors



These particulars do not form part of any contract and the statements or plans contained herein are not warranted nor are they to scale. All descriptions, dimensions, areas, reference to condition and necessary permissions for use and occupation and other details are given in good faith, and are believed to be correct, but any prospective purchaser should not rely on them as statements or representations of fact, and any prospective purchaser must satisfy themselves by inspection or otherwise as to the correctness of each of them. The Seller shall not be bound to accept the highest or any offer nor to accept a full offer of the Fixed Price where this is applicable. Approximate measurements have been taken by sonic device and measurements are most often taken to the widest point of any room or space. Services and appliances have not been tested for efficiency or safety and no warranty is given as to their compliance with any Regulations. Offers should be made using the Combined Standard Clauses.