





Located in the ever popular residential area of Berry Brow, which is conveniently positioned for access to Huddersfield and the Holme Valley; complete with it's own local railway station connecting Sheffield, Barnsley and Huddersfield.

Having some lovely local walks and scenery, varied local amenities and regular bus services, as well schooling for children of all ages.

The house itself has a gas central heating system and double glazing; and briefly comprises:-

Entrance, Spacious Lounge with focal point fireplace, Inner Hall, Lovely Modern Fitted Kitchen with appliances, opening out onto the rear garden which is perfect for barbecues etc.

There is a useful cellar providing additional storage.

To the first floor are Two Bedrooms; and Bathroom/wc with a shower over the bath.

Externally, there is low maintenance front garden, plus the rear garden that looks onto local fields. It has an artificial lawn, paved walkways and gravelling.

All in all a superbly presented house of which viewing is highly recommended.

The essentials: Mains services are available, the house is Freehold. The property is a slight wedge shape.



- Beautifully appointed and superbly presented through terraced house
- Two bedrooms
- With an open outlook at the rear onto local fields
- Gas central heating & double glazing
- Stylish kitchen cabinets and an integrated fridge, oven & hob
- Spacious lounge and main bedroom
- Bathroom with shower over the bath
- Attractive rear garden, perfect for alfresco dining
- Convenient and popular location
- View the 360° Virtual Reality tour on Belong's own website



From Woodhead Road at Berry Brow, proceed up Newsome Road South, where this property can be found on the left hand side at the junction with Caldercliffe Road.

Ground Floor

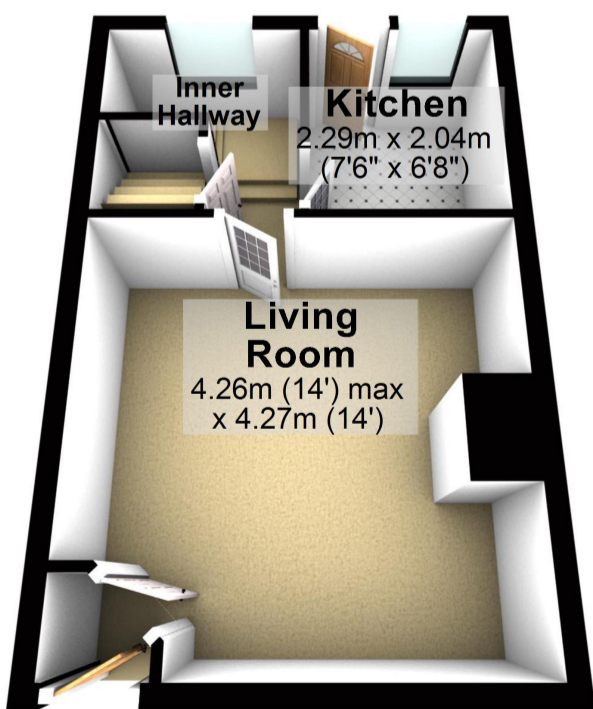

First Floor

