

Forest Park Lodges, High Bickington, Umberleigh
£155,000

John
Smale & Co.

Chartered Surveyors | Residential & Commercial Consultants



- Superb Off-Plan Holiday Lodge
- Spectacular Balcony
- Beautiful Presentation Throughout
- 12 Month Occupancy
- Peaceful and Tranquil Location

- Brick Build
- Unbelievable Views
- Fitted High Specification Kitchen
- Communal Swimming Pool
- Spacious Accommodation

50 Forest Park Lodges, High Bickington, Umberleigh, Devon, EX37 9BN

Plot 50 - Situated in the fantastic woodlands of High Bickington is this superb modern traditionally built holiday lodge with a 12 month occupancy, due to be completed by Summer 2022. The accommodation offers two bedrooms, two bathrooms and a large kitchen/diner on the ground floor, which will be fitted to your specification. The master bedroom has an ensuite shower room and the first floor lounge has a fantastic balcony, with stunning views over the surrounding farmland and countryside. The new phase of the Forest Park Lodges sit in a great position on the site, allowing for fantastic views over the countryside. Situated within a forest on the outskirts of High Bickington and Kingford, it is ideal for access to both Barnstaple and Exeter on the A377.

Kitchen/Diner

6.3m x 4m (20' 8" x 13' 1")

Bedroom One

3.7m x 3.1m (12' 2" x 10' 2")

Ensuite Shower Room

2m x 1.2m (6' 7" x 3' 11")

Bedroom Two

3.2m x 3.1m (10' 6" x 10' 2")

Bathroom

1.7m x 1.7m (5' 7" x 5' 7")

Living Room

6.3m x 4.5m (20' 8" x 14' 9")

Balcony

6.7m x 2.4m (22' 0" x 7' 10")

Outside

Allocated car parking & visitors parking nearby, large balcony offering fantastic views, a perfect spot to take in the stunning scenery, or maybe enjoy a glass of wine or two!

Services

Central Heating, Electric, Water. Council Tax Band A. 999 Year Lease.

Directions

From Barnstaple head towards Bideford on the A39. At roundabout turn left signposted Bishops Tawton and Exeter. Follow road for some distance. After passing Kingsford sign, take next right turn up hill. Follow signs to Forest Park Lodges, which will be found on your right. After entering the Park, pass the first row of lodges on your left and follow ahead where you will find phase 3.

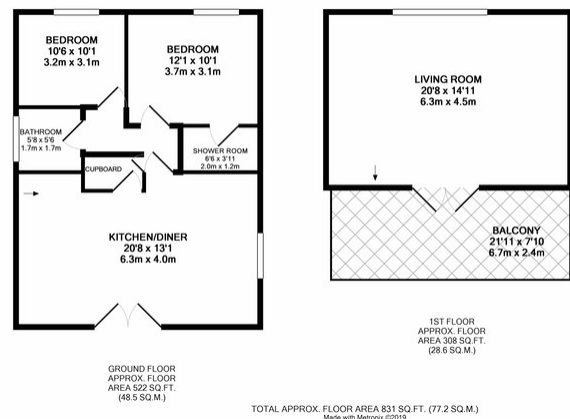

At John Smale & Co we don't just sell houses! ...

Contact us now for information on all of our other services including Residential and Commercial Lettings, Property Management, Commercial Property Sales, Probate Valuations, Independent Financial Advice, Energy Performance Certificates, Auctions and New Homes.

These particulars have been prepared for guidance only. We have not carried out a detailed survey, not tested the services, appliances or specific fittings. Floor plans are not drawn to scale unless stated, measurements and distances are approximate only. Do not rely on them for carpets and furnishings. Photographs are not necessarily current and you should not assume that contents shown are included in the sale.

Email: sales@johnsmale.com Website: www.johnsmale.com

5 Cross Street Barnstaple EX31 1BA

Offices also @ London (Mayfair Office)

Tel: 01271 342000