



9 Whittle Court,  
Knowlhill, Milton Keynes, MK5 8FT

Tel: 01908 231 551  
mail@elevationstateagents.com



## 7 Browne Willis Close, Bletchley, Milton Keynes, Buckinghamshire, MK2 2LJ

### £360,000 Freehold

- Linked detached three double bedroom family home
- Convenient access to Central Milton Keynes for shopping, leisure, and business
- High ceilings throughout, creating a bright and spacious feel
- Excellent condition throughout – move-in ready
- Two allocated parking spaces
- Principal bedroom with en-suite shower room
- Close to Bletchley town centre with shops, cafes, and restaurants
- Integrated appliances



See our full selection of properties online at [www.elevationstateagents.com](http://www.elevationstateagents.com)





Stunning Three-Bedroom Linked Detached Home – Browne Willis Close, Bletchley, Milton Keynes, MK2 2LJ Located in a sought-after area of Bletchley, this beautifully presented three-bedroom linked detached home offers modern living in a convenient and family-friendly setting. The property enjoys excellent access to Bletchley town centre, local shops, schools, green spaces, and transport links, including Bletchley train station, making it ideal for commuters and families alike. As you enter, you are greeted by an inviting hallway leading to a spacious lounge area, perfect for relaxing or entertaining. The modern kitchen/diner is a standout feature, fitted with an integrated oven, hob, dishwasher, and washing machine. Double French doors open onto a well-maintained private garden, creating a seamless flow between indoor and outdoor living. A convenient ground floor W/C completes this level. Upstairs, you'll find three generous double bedrooms, each benefiting from high ceilings that add to the sense of space and light throughout. The principal bedroom includes a stylish en-suite with a walk-in shower, while the family bathroom offers a contemporary three-piece suite. Externally, the property provides two allocated parking spaces and an attractive frontage. Presented in excellent condition throughout, this home perfectly combines comfort, practicality, and style — an ideal choice for families, professionals, or anyone looking to enjoy a well-connected location in Milton Keynes.

## Disclaimer

Whilst we have endeavoured to prepare our sales particulars accurately none of the services, appliances or equipment have been tested. A buyer should satisfy themselves on such matters prior to purchase. Any measurements or distances mentioned in these particulars are for guide reference only. If such particulars are fundamental to a purchase, buyers should rely on their own enquiries. All enquiries should be directed to Elevation Estate Agents in the first instance.

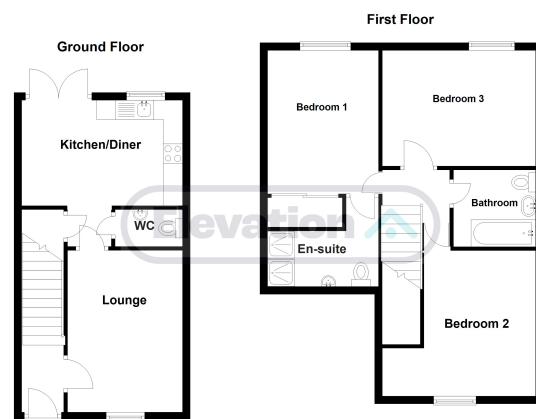

Floorplans are for layout purposes only. Measurements are approximate and subject to inaccuracies. Plan produced using PlanUp.