



Day & Co
ESTATE AGENTS

28 Cavendish Street

Keighley

BD21 3RG



42 Wheathead Lane, Keighley,
West Yorkshire, BD22 6NR

£145,000

T: 01535 664609

W: www.dayandcoestateagents.co.uk

E: keighley@dayandcoestateagents.co.uk

- STONE THROUGH COTTAGE
- INTERNAL VIEWING ADVISED
- REAR PATIO GARDEN

- TWO BEDROOMS
- CHARACTER FEATURES
- EPC Rating C

SUMMARY

** DELIGHTFUL STONE THROUGH COTTAGE, TWO BEDROOMS, CHARACTER FEATURES, GAS CENTRAL HEATING, DOUBLE GLAZING, REAR PATIO GARDEN, CONVENIENT LOCATION, INTERNAL VIEWING ADVISED, AWAITING EPC **

FULL DESCRIPTION

A delightful, two bedroom stone through cottage offering accommodation that could suit a variety of buyers situated in the popular residential location of Exley Head. This character property briefly comprises of a spacious lounge with mullion windows to the front, window seat, wood burning stove, open plan staircase, ceiling beams. Breakfast kitchen having a range of base and wall mounted units, oven, hob, extractor hood, plumb for washer, window to the rear and door. First floor : Landing : Bedroom one has mullion windows to the front and wardrobe space, Bedroom two can be found at the rear and completing the accommodation is the bathroom which has a suite comprising of a bath with shower over, WC, wash hand basin, towel radiator and window to the rear. Gas central heating and double glazing. Outside patio yard to the rear. EPC Rating C.

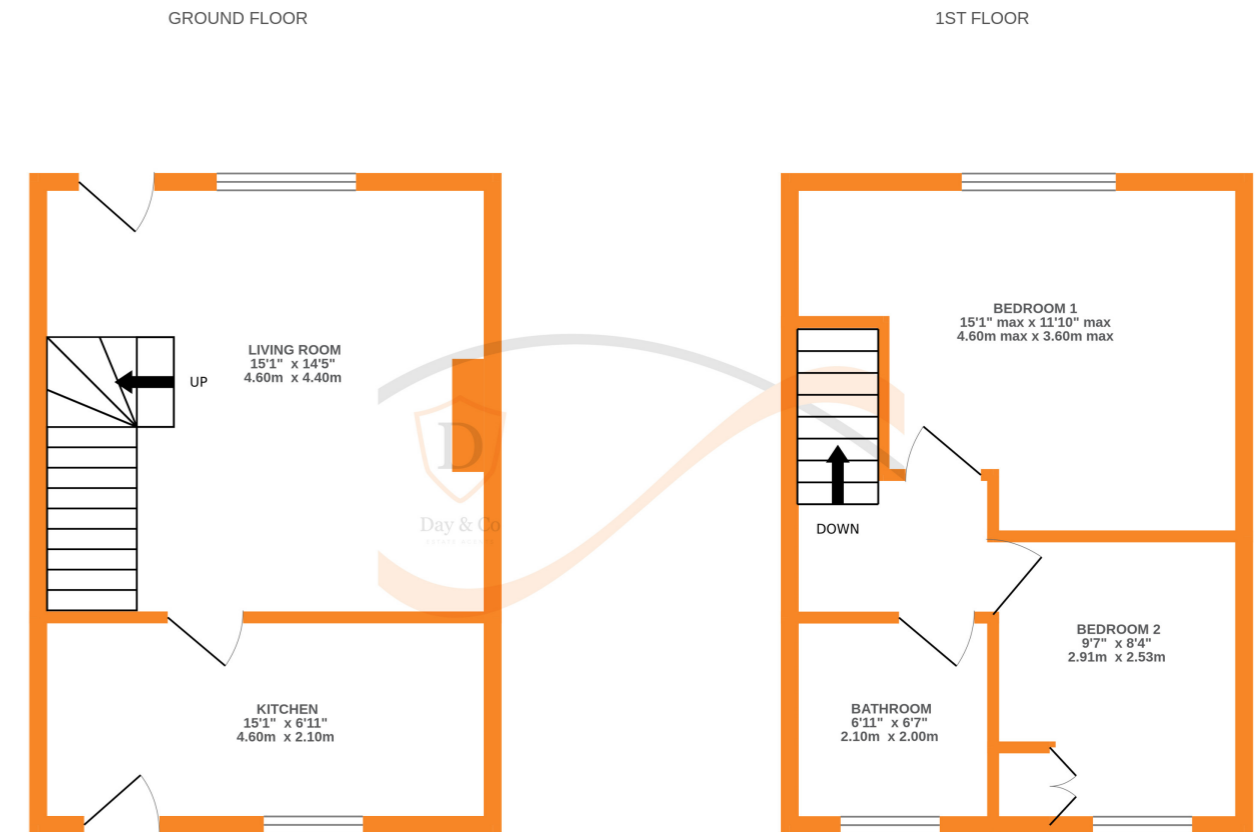

Whilst every attempt has been made to ensure the accuracy of the floorplan contained here, measurements of doors, windows, rooms and any other items are approximate and no responsibility is taken for any error, omission or mis-statement. This plan is for illustrative purposes only and should be used as such by any prospective purchaser. The services, systems and appliances shown have not been tested and no guarantee as to their operability or efficiency can be given.
Made with Metropix 62023