



203 Calder Road, Edinburgh, EH11 4RG

Spacious, Two-Bedroom, Lower Villa with Private Gardens

Up to date price and viewing info at mov8realestate.com/property

espc rightmove  **Zoopla**
find your happy

Property Description

Well-presented and spacious, two-bedroom, traditional lower villa, with private gardens. Located in the popular Parkhead residential area, south-west of Edinburgh city centre.

Comprises a vestibule, hallway, living/dining room, kitchen, conservatory, two double bedrooms, and a shower room.

Features include a fitted kitchen, a bright modern shower room, double glazing and gas central heating.

In addition, there is good storage, including a walk-in hall store, bedroom stores and a garden shed.

Externally, there are low-maintenance gardens to both aspects, with the rear garden being enclosed and the front having privacy hedging.

A welcoming entrance vestibule opens into the hall, affording access throughout the majority of the property, including a convenient storage cupboard. Set to the front, a generous living room offers space for dining as well, if desired, while enjoying a south-facing aspect allowing plenty of natural light. Set off the lounge, the kitchen has garden access, while fitted units and worktops include a tiled surround, and an integrated hob, oven and fridge/freezer.

Two well-proportioned bedrooms are set to opposite aspects, both including built-in storage, while bedroom two provides access to the conservatory, which offers a further lounge space and direct access to the rear garden. Completing the accommodation, the shower room is fitted with a modern suite including tiled splash walls and a ladder-style radiator.



203 Calder Road, Edinburgh EH11 4RG

Approximate Gross Internal Area: (742 sq ft - 69 sq m.)

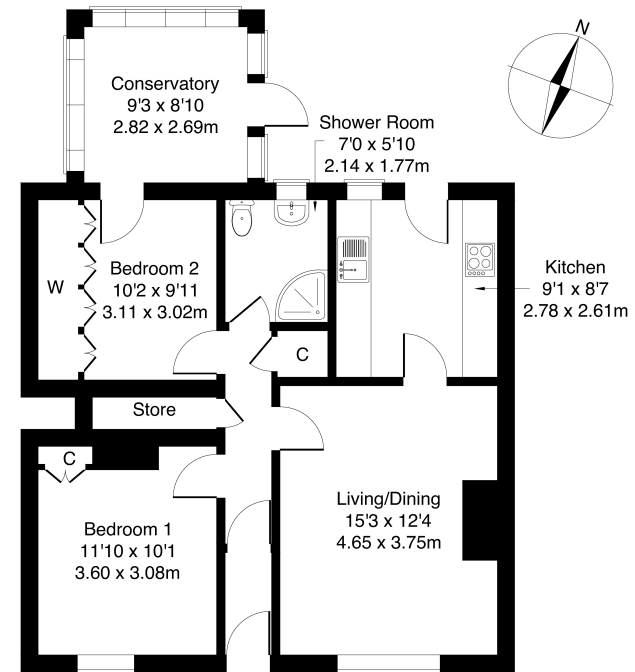

Legal Disclaimer : Floor-plan and measurements are for illustrative guidance only, and not intended to form part of any contract.

Area Description

Parkhead is an established residential area, a short distance from Edinburgh College and the Sighthill campus of Napier University, with schooling at all levels available locally. There is a good variety of shops and amenities at hand, with more extensive facilities provided by The Gyle and Hermiston Gait retail parks. Nearby Longstone is home to a large Sainsbury's store, with an Asda close by at

Chesser. Many recreational facilities are available within the area, including a cinema at the nearby Westside Plaza, and leisure facilities and a swimming pool at The Wester Hailes Education Centre, just a few hundred yards distant. There is also Kingsknowe Golf Course, Sighthill Bowling Club, Pure Gym, and The Corn Exchange.





Our Services

-  Free pre-sale property valuations
-  Great value fixed estate agency fees
-  Extensive buyer matching database
-  Purchase and sale conveyancing

Contact Us

0345 646 0208

sales@mov8realestate.com

www.mov8.com

Head Office

6 Redheughs Rigg, Edinburgh, EH12 9DQ

Glasgow Office

77 Renfrew Street, Glasgow, G2 3BZ



Estate Agents and Solicitors



These particulars do not form part of any contract and the statements or plans contained herein are not warranted nor are they to scale. All descriptions, dimensions, areas, reference to condition and necessary permissions for use and occupation and other details are given in good faith, and are believed to be correct, but any prospective purchaser should not rely on them as statements or representations of fact, and any prospective purchaser must satisfy themselves by inspection or otherwise as to the correctness of each of them. The Seller shall not be bound to accept the highest or any offer nor to accept a full offer of the Fixed Price where this is applicable. Approximate measurements have been taken by sonic device and measurements are most often taken to the widest point of any room or space. Services and appliances have not been tested for efficiency or safety and no warranty is given as to their compliance with any Regulations. Offers should be made using the Combined Standard Clauses.