



*470 Sutton Heath Road, St Helens, Merseyside.
WA9 5HU.
£70,000*



3 Bed Mid Terrace House | In Need Of Refurbishment | Downstairs Family Bathroom | Low Maintenance Rear Garden With Decking & Patio | Close Access to Transport Links And Amenities | Council Tax Band - A | Freehold | services/appliances have not been tested |



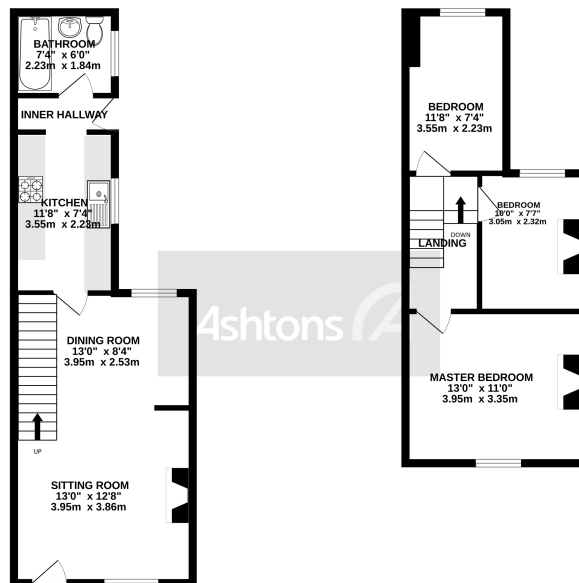

TOTAL FLOOR AREA: 755 sq.ft. (70.2 sq.m.) approx.
 Whilst every attempt has been made to ensure the accuracy of the floorplans contained here, measurements of plots, windows, rooms and any other items are approximate and no responsibility is taken for any error, omission or mis-statement. The plans are for illustrative purposes only and should be used as such by any prospective purchaser. The services, fixtures and appliances shown have not been tested and no guarantee is to be made. Availability of references on call please.
 Made with MyPlan 0322

Offered to the market with no onward chain is this three bed mid terraced property, close to transport links and local amenities. This property is in need of renovation it would be ideal for an investor or first time buyer looking for a property to put their own stamp on.

The accommodation comprises; sitting room thru diner, kitchen and inner hallway leading to the downstairs bathroom. To the first floor there are three well-sized bedrooms.

Externally, there's a yard to the rear and parking on street parking is available.

Get a Mortgage: We have an Independent Mortgage Advisor based in EVERY Ashtons Office. We can search over 90 lenders to ensure that we find the most suitable mortgage for your circumstances. Interested? Call your local office on 01925 479334 for a chat. AS A MORTGAGE IS SECURED AGAINST YOUR HOME, IT COULD BE REPOSSESSED IF YOU DO NOT KEEP UP THE MORTGAGE REPAYMENTS



Contact your local office
to arrange a viewing:

Padgate: 01925 479334
Great Sankey: 01925 454300
Winwick: 01925 232146
Stockton Heath: 01925 453400
St.Helens: 01744 754120
Wigan: 01942 498862
Culcheth: 01925 764744
Ashton-In-Makerfield: 01942 364446
Newton-Le-Willows: 01925 907770
Commercial Office: 01925 907709
Lettings Head Office: 01925 873533
Financial Services: 01925 221234

Viewing Arrangements

Viewing is strictly by appointment only through Ashtons Estate Agency.

Disclaimer Property Details

These particulars, whilst being believed to be accurate are set out as a general outline only for guidance and do not constitute any part of an offer or contract. Intending purchasers should not rely on them as statements of representation of fact, but must satisfy themselves by inspection or otherwise as to their accuracy. We have not carried out a detailed survey nor tested the services, appliances and specific furnishings. The measurements given are approximate. No person in this firm's employment has the authority to make or give any representation or warranty in respect of the property.

All details, photographs and floorplans are the copyright of Ashtons Estate Agency.



How much you can borrow?
Speak to a mortgage expert in your local office.

Ashtons Financial Services

Ashtons

Ashtons.net rightmove

PrimeLocation.com Zoopla.co.uk