



Asking Price

£115,000

Leasehold

RINGWOOD ROAD, FERNDOWN BH22 9FE



- ◆ RETIREMENT APARTMENT
- ◆ FIRST FLOOR POSITION
- ◆ NO FORWARD CHAIN
- ◆ ONE BEDROOM

A first floor, one bedroom, retirement apartment close to Ferndown Town Centre, offering comprehensive levels of care which includes a restaurant and a guest room for visitors.

Property Description

Cherret Court was developed by McCarthy & Stone and offers a selection of one and two bedroom over 70's retirement apartments, arranged over three storeys. This particular apartment is located on the first floor and benefits from an outlook over the rear of the development. Cherret Court offers a comprehensive level of assisted living, essentially aimed towards residents who require a little more assistance than simply a resident warden. The development boasts its own restaurant serving daily three course meals, as well as a residents lounge and guest accommodation for when you have visitors wishing to stay. The apartment has a practical layout comprising of living room, modern fitted kitchen and generous double bedroom with built in cupboards, along with a shower room designed for those with limited mobility.

Gardens and Grounds

There is a communal parking facility to the front of the development and parking permits are available (this may be subject to a waiting list).

Lease: 125 years from January 2010

Service Charge Details: £693.61 per month (£8,323.34 per annum)

Ground Rent Details: £217.50 paid every six months (£435 per annum)

No Pets

Location

Ferndown is located conveniently at the start of the A31 and enjoys a strategic position allowing easy vehicular access to the towns and beaches of Bournemouth, Poole and Christchurch. With a championship golf course, busy retail precinct and two national supermarkets, Ferndown is a sought after residential area.

Size: 489 sq ft (45.5 sq m)

Heating: Night Storage

Glazing: Double glazed

Parking: Casual off road

Garden: N/A

Mains Services: Electric, water, drains, telephone

Local Authority: Dorset Council

Council Tax Band: C



FIRST FLOOR
489 sq.ft. (45.5 sq.m.) approx.

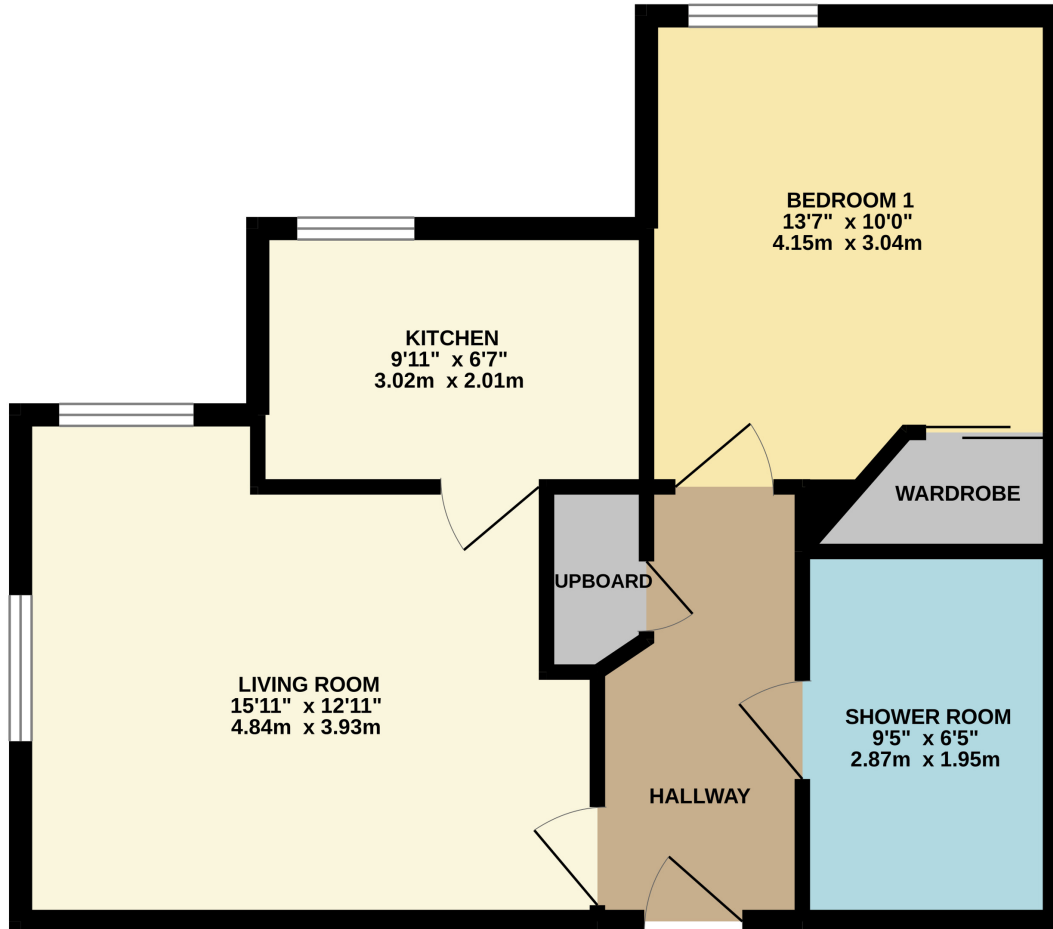

TOTAL FLOOR AREA : 489 sq.ft. (45.5 sq.m.) approx.
Measurements are approximate. Not to scale. Illustrative purposes only
Made with Metropix ©2022



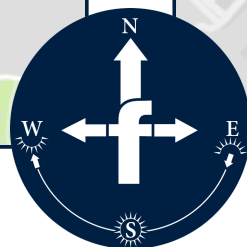
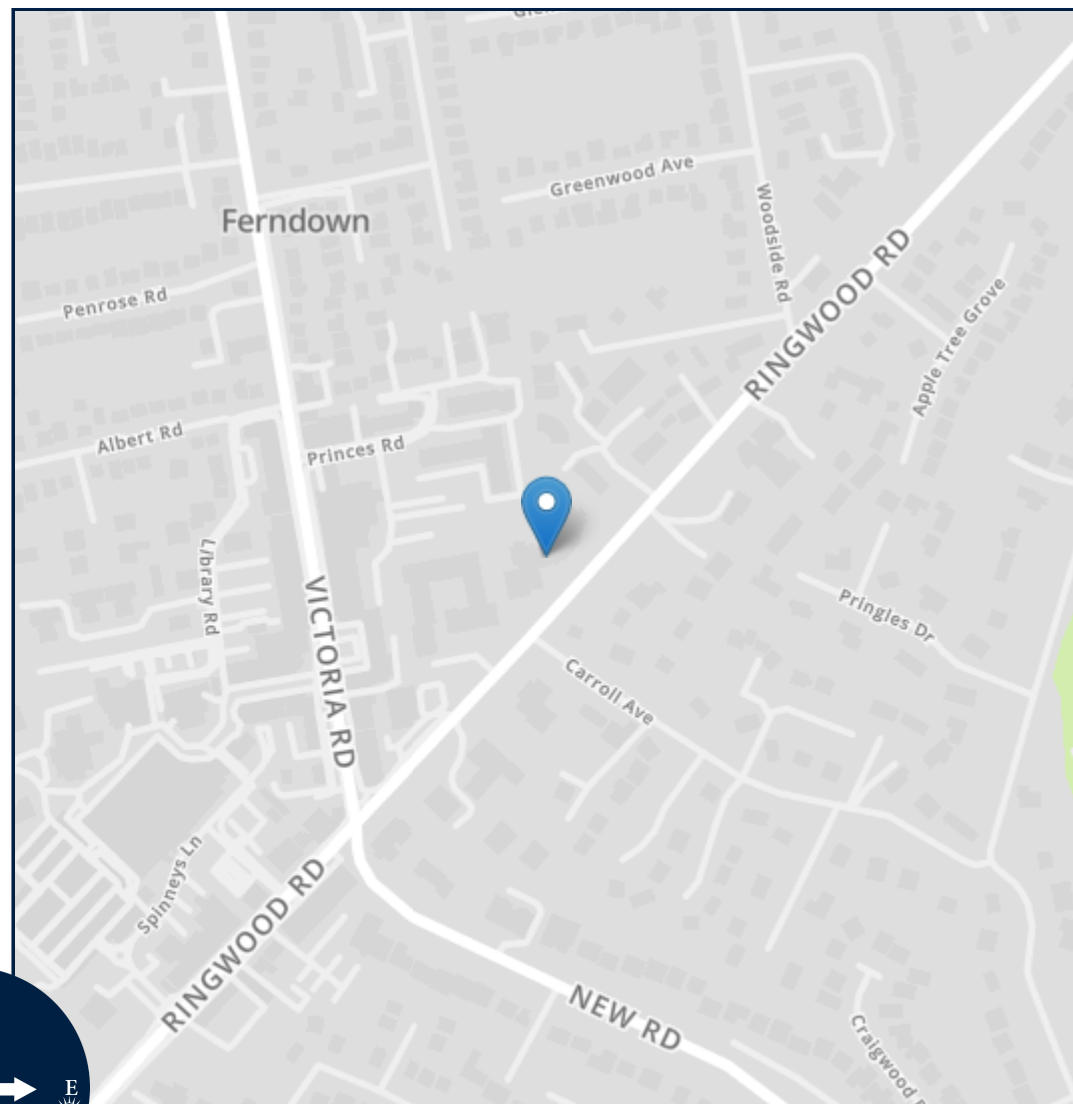
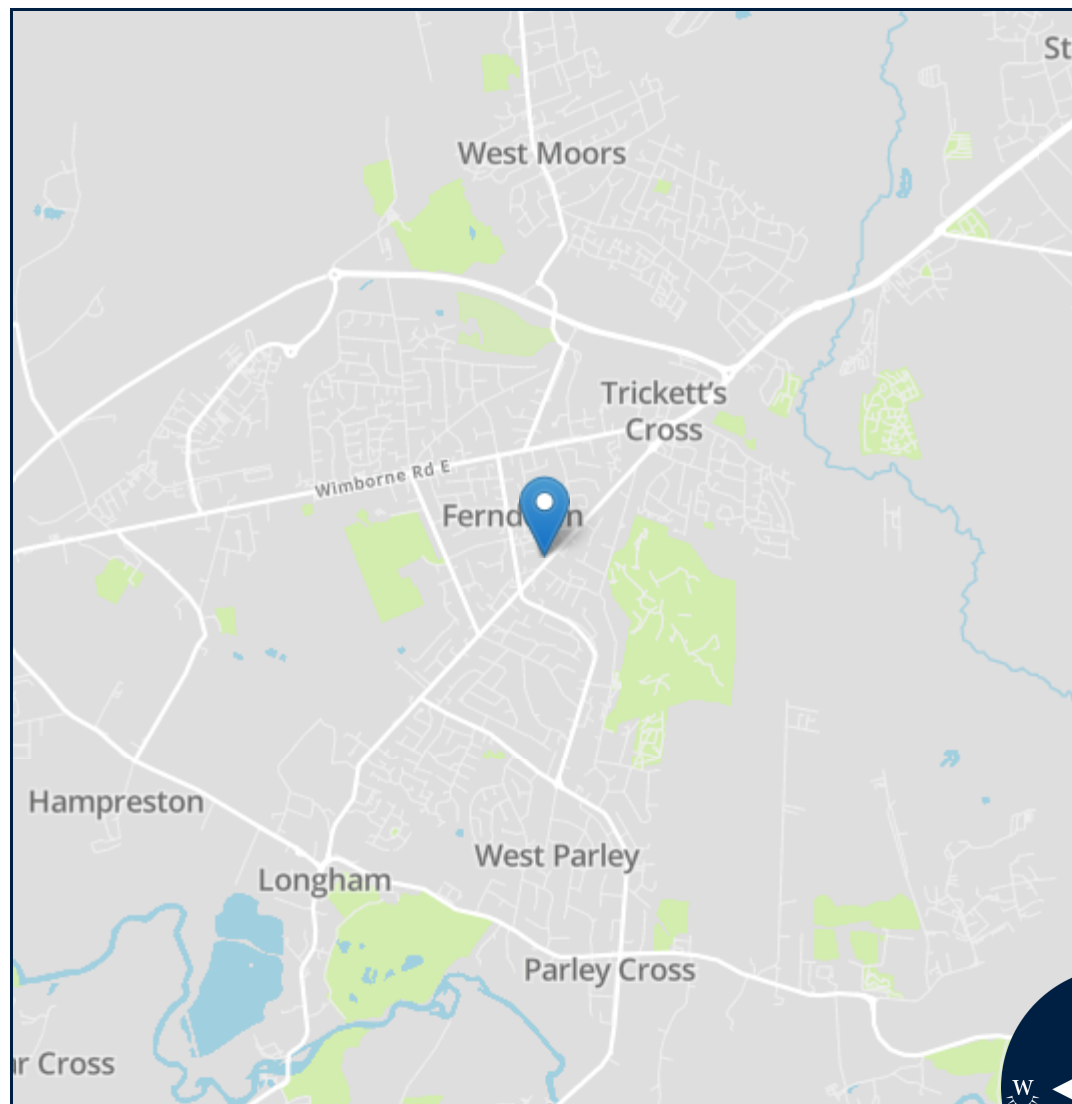

Important notice: Fisks Estate Agents, their clients and any joint agents give notice that 1: They are not authorised to make or give any representations or warranties in relation to the property either here or elsewhere, either on their own behalf or on behalf of their client or otherwise. They assume no responsibility for any statement that may be made in these particulars. These particulars do not form part of any offer or contract and must not be relied upon as statements or representations of fact. 2: Any areas, measurements or distances are approximate. The text, photographs and plans are for guidance only and are not necessarily comprehensive. It should not be assumed that the property has all necessary planning, building regulation or other consents and Fisks Estate Agents have not tested any services, equipment or facilities. Purchasers must satisfy themselves by inspection or otherwise.



12 East Street, Wimborne,
Dorset, BH21 1DS
www.fisksestateagents.co.uk
01202 880000