

Warwick Place , W5

Approximate Floor Area = 57.2 sq m / 616 sq ft

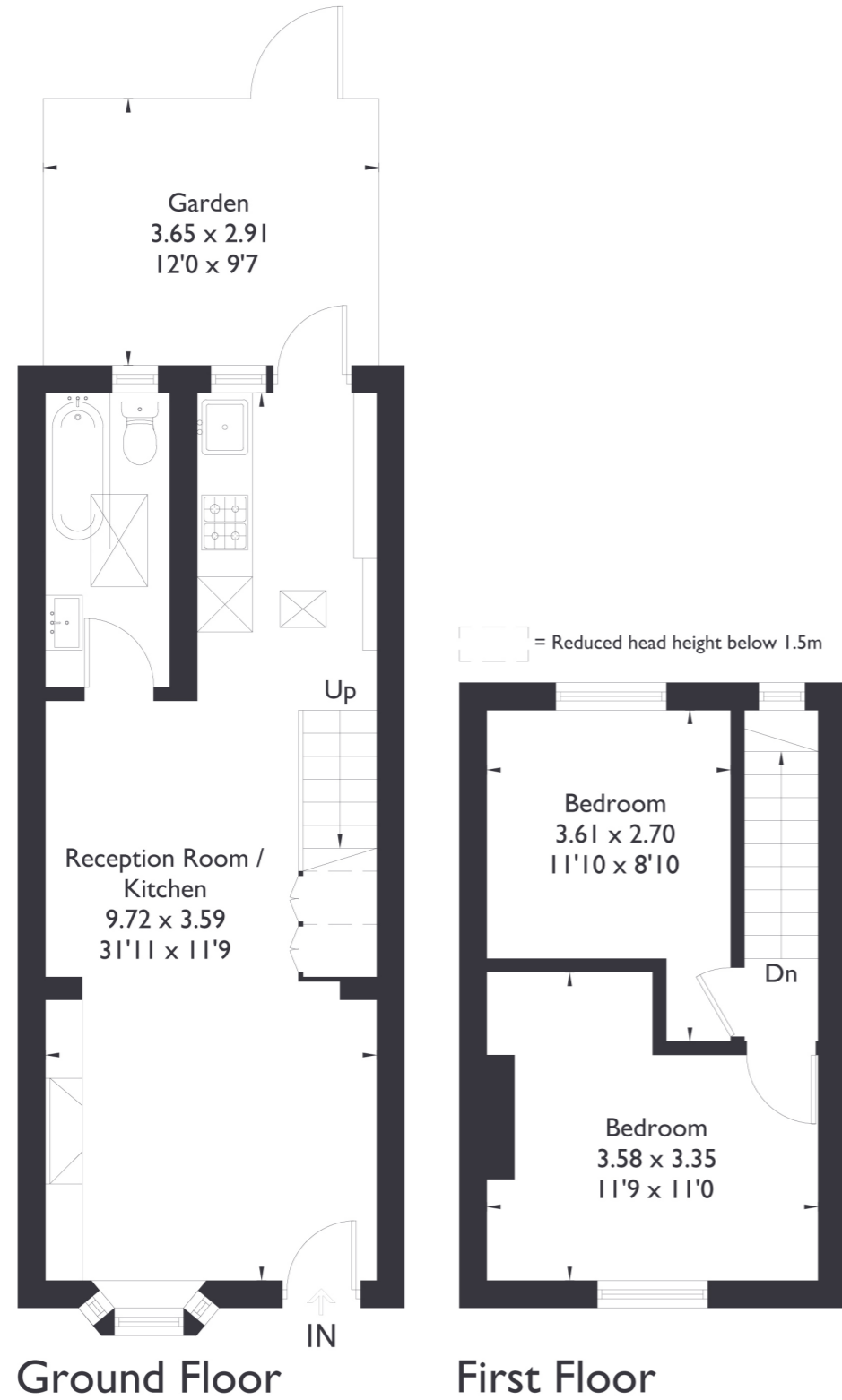

2 BEDROOM HOUSE

Warwick Place, W5  
£675,000

Welcome to this inviting two bedroom, one bathroom property nestled in the heart of Ealing, offering a comfortable and convenient lifestyle. Upon entry, you'll be greeted by a spacious living and dining area, perfect for relaxation or hosting gatherings. The separate kitchen and bathroom downstairs offer practicality and lead seamlessly to the garden, providing a tranquil outdoor space to enjoy.

FEATURES

- Two Bedrooms
- One Bathroom
- Kitchen & Living Space
- Grange Primary School
- Ealing Broadway Amenities
- Ealing Broadway/South Ealing Stations
- EPC Rating D



2 BEDROOM HOUSE

## Warwick Place, W5

Ascending the stairs, you'll find two double bedrooms flooded with natural light via the original stained glass window, creating bright and airy spaces for rest and relaxation.

Situated in a prime location, with Ealing Broadway just steps away, this property offers easy access to an array of amenities, including shops, restaurants, and entertainment options. Transportation links are abundant, with both Ealing Broadway station and South Ealing station just a short walk away, ensuring swift connections to the rest of London and beyond.

EPC Rating D.

