

UNDER OFFER

£170,000 Leasehold



16 Barnwood Close, Guildford, Surrey. GU2 8GG

- Must Be Seen
- Double Glazed
- Gas Central Heating
- First Floor
- Double Bedroom
- Bathroom
- Parking
- No Onward Chain



Hipps Estate Agents Ltd
12c, Worplesdon Road, Guildford, GU2 9RW

01483 576300
info@hippsestateagents.co.uk



PROPERTY DESCRIPTION

This conveniently located first floor flat comes to the market with no onward chain. Benefits include a fitted kitchen, lounge, double bedroom and bathroom.

Further benefits include gas central heating, double glazing and parking. Local amenities are nearby as are bus routes but to fully appreciate the accommodation viewings are highly recommended



ROOM DESCRIPTIONS

Ground Floor

Communal Entrance Hall

Stairs to first floor landing

First Floor

Entrance Hall

Doors to:

Kitchen

Range of eye and base level units, double glazed window, wall mounted boiler, fitted appliances

Lounge

Double glazed window, radiator

Bedroom

Double glazed window, radiator ,

Bathroom

Panel enclosed bath, low level w.c, wash hand basin, tiled walls

Outside

Communal Grounds

Parking

Lease

Years Remaining On Lease 112yrs

Ground Rent £200 P/A

Service Charge Approx £1500- £1731



FLOORPLAN



First Floor

Approx. 44.6 sq. metres (479.8 sq. feet)

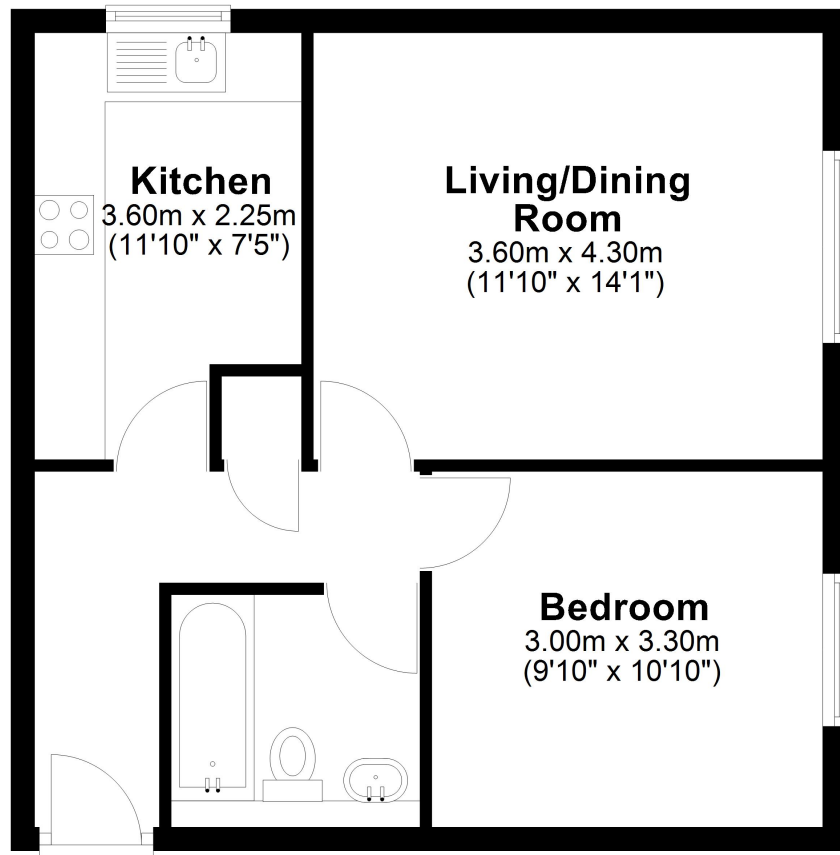

Total area: approx. 44.6 sq. metres (479.8 sq. feet)