



Day & Co  
ESTATE AGENTS

28 Cavendish Street

Keighley

BD21 3RG



1 Leach Road, Riddlesden,  
Keighley, West Yorkshire, BD20  
5DA

£199,995

T: 01535 664609

W: [www.dayandcoestateagents.co.uk](http://www.dayandcoestateagents.co.uk)

E: [keighley@dayandcoestateagents.co.uk](mailto:keighley@dayandcoestateagents.co.uk)



- SEMI-DETACHED BUNGALOW
- SPACIOUS LIVING ROOM
- BASEMENT UTILITY, GARAGE

- TWO DOUBLE BEDROOMS
- PLEASANT GARDENS
- EPC RATING C

SUMMARY

\*\* SEMI-DETACHED BUNGALOW, TWO DOUBLE BEDROOMS, DINING KITCHEN, SPACIOUS LIVING ROOM WITH MULTI FUEL STOVE, PLEASANT GARDENS, BASEMENT/UTILITY, DRIVE & GARAGE, EPC RATING C \*\*

FULL DESCRIPTION

A delightful two double bedroom semi detached bungalow situated in the popular residential location of Riddlesden. This bungalow could appeal to a variety of buyers and an internal viewing is advised to fully appreciate this property. In brief the accommodation comprises of an Entrance Porch which also gives access to the rear. Dining Kitchen which has a range of base and wall mounted units, integrated oven, hob and extractor fan, plumb for a dishwasher, undercounter space for a fridge and freezer. Inner hallway with built in cupboard. Living Room which has a multi fuel burning stove in feature fireplace, double glazed window and door to front. There are two double bedrooms, the main one benefits from fitted wardrobes. The house Bathroom completes the accommodation having bath with shower over, wc and wash hand basin, side window. Gas central heating and Double glazing. Externally the property is situated on a corner plot having a good sized established garden to front. Driveway and garage. Steps down from the porch to a smaller rear garden and under house basement utility room with further cellar area off.

Situated in lower Riddlesden this bungalow is handily placed for leisurely walks along the canal and walking routes along with being not far from the convenience of local amenities and public transport links.

EPC Rating C.

GROUND FLOOR

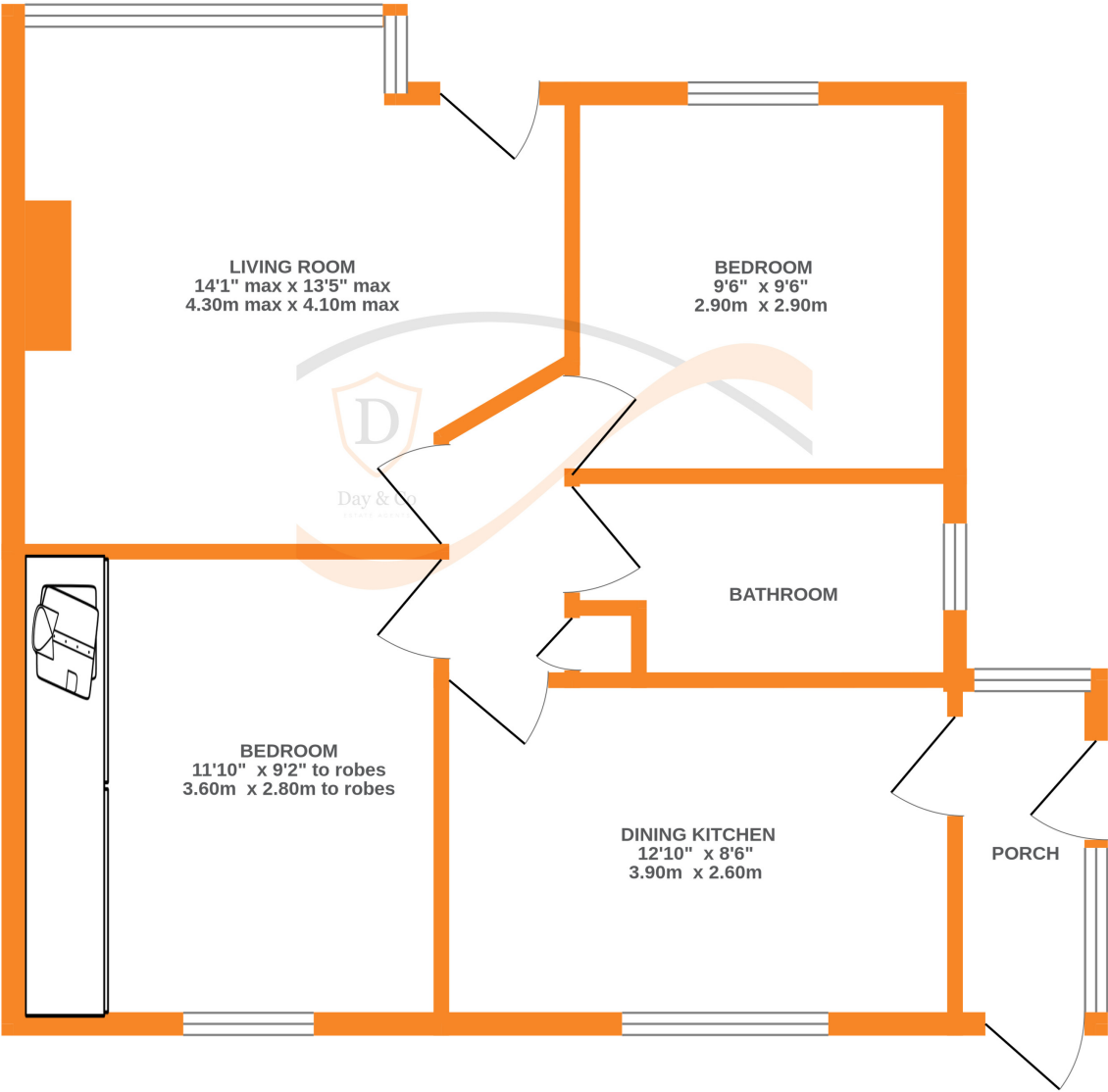

Whilst every attempt has been made to ensure the accuracy of the floorplan contained here, measurements of doors, windows, rooms and any other items are approximate and no responsibility is taken for any error, omission or mis-statement. This plan is for illustrative purposes only and should be used as such by any prospective purchaser. The services, systems and appliances shown have not been tested and no guarantee as to their operability or efficiency can be given.  
Made with Metropix ©2025