

Truuli



Queenswood Avenue, Wallington, Surrey, SM6

£600,000 Freehold

- Located on a popular residential road in Wallington
- Two bathrooms
- Shared driveway for off street parking
- Close to local transport links and amenities
- Garage ideal for parking or storage
- Low maintenance garden over 55ft long
- Spacious kitchen ideal for entertaining
- Over 1300sqft throughout the property

2, Lansdowne Road, Croydon, Surrey, CR9 2ER

Tel: 0330 043 0002

Email: save@truuli.co.uk Web: www.truuli.co.uk

Queenswood Avenue, Wallington, Surrey, SM6

£600,000 Freehold

A fantastic-sized chalet-style semi-detached property, offered to the market with no onward chain and plenty of space for a new owner to enjoy!

Ground Floor
794 sq.ft. (73.8 sq.m.) approx.

1st Floor
535 sq.ft. (49.7 sq.m.) approx.

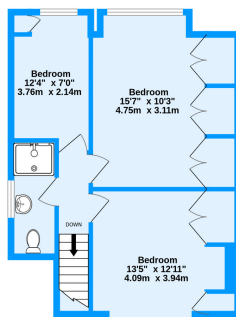
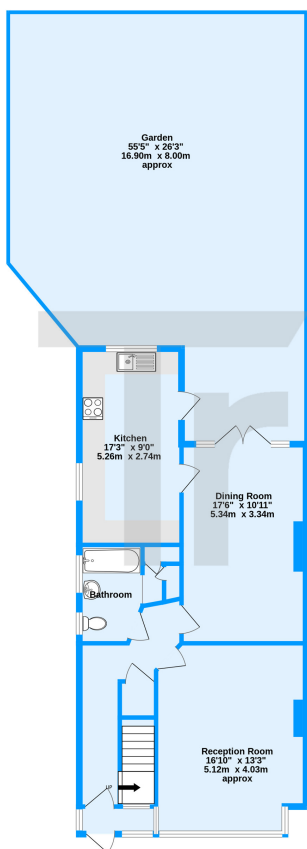

Queenswood Avenue, Wallington, SM6

TOTAL FLOOR AREA: 1329 sq.ft. (123.5 sq.m.) approx.

Measurements are approximate. Not to scale. Illustrative purposes only

Made with Metropix ©2023

Energy Efficiency Rating		Current	Potential
Very energy efficient - lower running costs			
(92-100)	A		
(81-91)	B		
(69-80)	C		
(55-68)	D		60
(39-54)	E	43	
(21-38)	F		
(1-20)	G		
Not energy efficient - higher running costs			
England, Scotland & Wales		EU Directive 2002/91/EC	

