



6 Mimram Close, Whitwell, Hitchin, Hertfordshire, SG4 8HR

£575,000

Lane & Bennetts present a rarely available four bedroom detached bungalow tucked away in a select cul de sac in the heart of the Village of Whitwell. Benefitting from an open plan aspect of a fitted kitchen and large living & dining space, with French doors to the private rear garden and feature fireplace. The integral double garage leads from the kitchen, and lends itself to further conversion subject to planning.

The main bedroom offers built in wardrobes, pleasant rear views and an en suite wet room. There are three further versatile small double rooms. The property enjoys ample storage. Some cosmetic updating would be beneficial.



## 6 Mimram Close

Approximate Gross Internal Area  
413 sq ft - 126 sq m

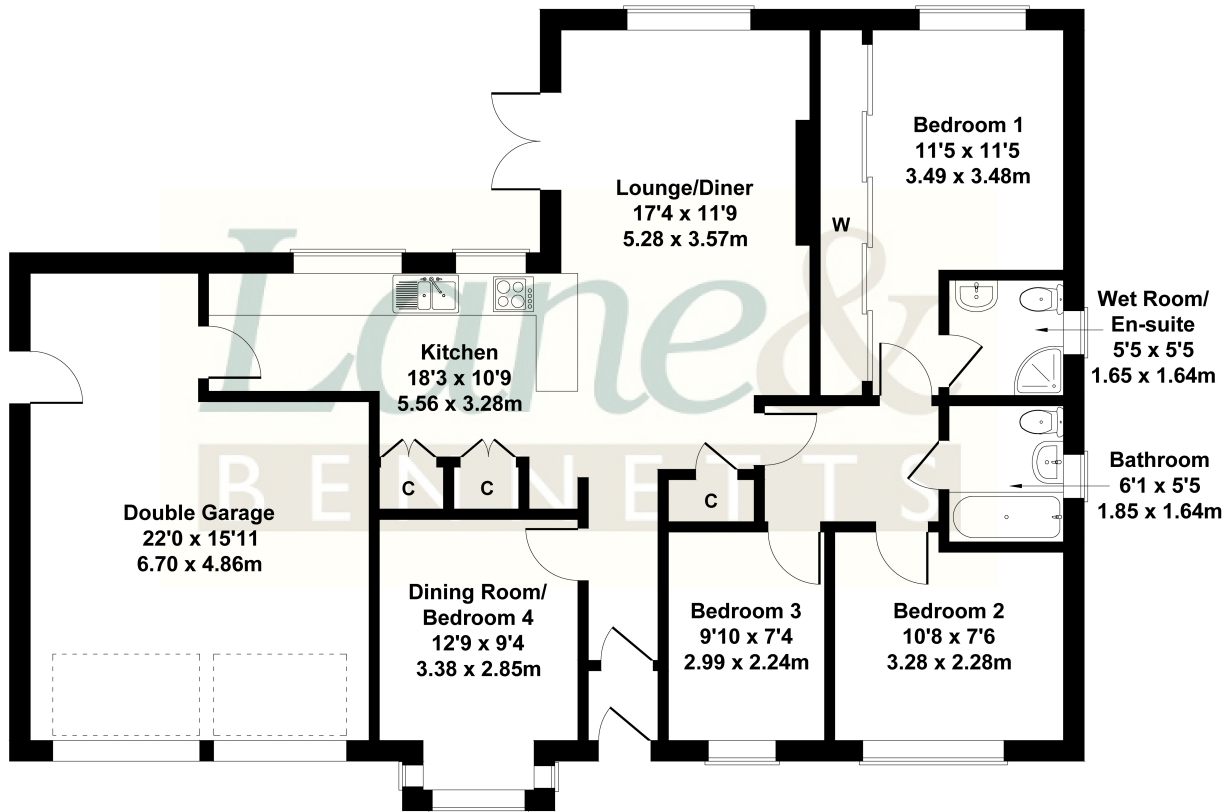

Not to Scale. Produced by The Plan Portal 2023  
For Illustrative Purposes Only.

- DETACHED FOUR BEDROOM BUNGALOW
- SELECT CUL DE SAC IN SOUGHT AFTER WHITWELL VILLAGE
- CHAIN FREE - AVAILABLE TO VIEW NOW
- FITTED MODERN KITCHEN
- OPEN PLAN ASPECT LIVING/DINING SPACE
- MAIN BEDROOM WITH EN SUITE WET ROOM
- FURTHER FAMILY BATHROOM
- INTEGRAL DOUBLE GARAGE SUITABLE FOR CONVERSION stp
- PRIVATE REAR GARDEN
- CARRAIGE DRIVEWAY
- CLOSE TO THE HEART OF THE VILLAGE

