

Tydemans, Great Baddow, Chelmsford, Essex, CM2 9FH



Energy Efficiency Rating C



£250,000

FLOORPLAN

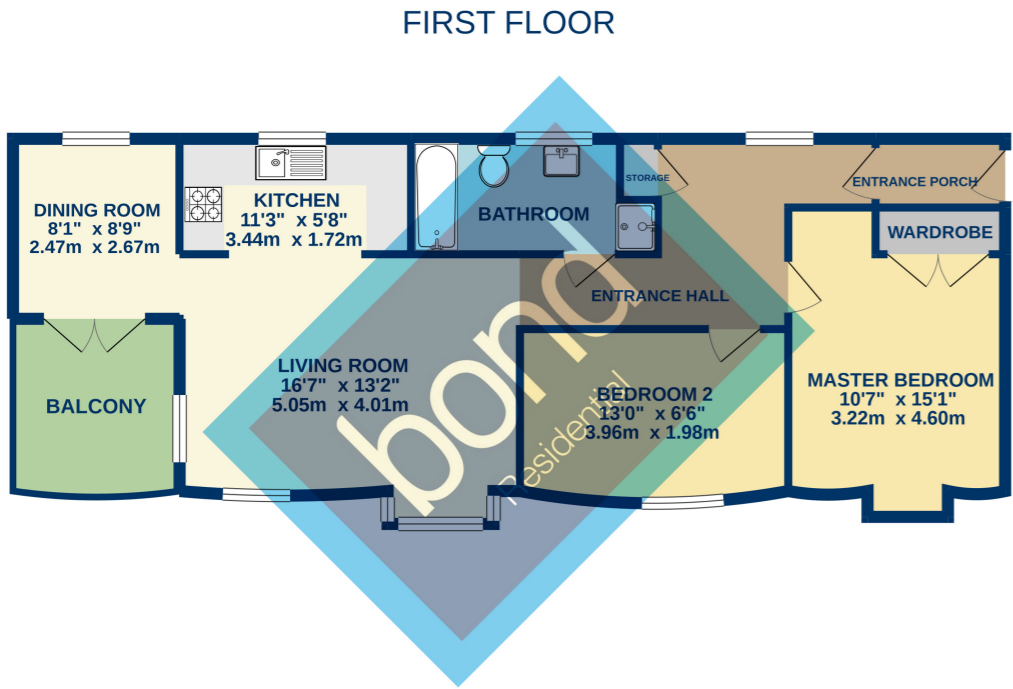

Whilst every attempt has been made to ensure the accuracy of the floorplan contained here, measurements of doors, windows, rooms and any other items are approximate and no responsibility is taken for any error, omission or mis-statement. This plan is for illustrative purposes only and should be used as such by any prospective purchaser. The services, systems and appliances shown have not been tested and no guarantee as to their operability or efficiency can be given.
Made with Metropix ©2020

Tydemans, Great Baddow, Chelmsford, Essex, CM2 9FH



THE PROPERTY:

Located on the popular Clarion Gate development in Great Baddow, this modern first floor apartment offers natural light by many windows and is deceptively spacious. The accommodation includes a dining area with double doors leading to a paved balcony, living room with walk in bay window and fitted kitchen with integrated appliances, master bedroom with fitted wardrobe, second bedroom and four piece bathroom suite. Parking is provided below the property via a carport where there are two allocated spaces.

AREA GUIDE:

Great Baddow itself offers primary and secondary schools which include Baddow Hall Infants and Sandon School as well as the Vineyards Shopping centre which is a little over 1 mile from the property. Located within a few minutes walk of the property is Beehive Lane where there are bus routes with services to the City centre and a local convenience store.

Chelmsford has become an extremely popular choice for homebuyers due to its proximity to London, some of the most highly regarded schools in the UK and its thriving City Centre which is located less than 2 miles from the property. Chelmsford boasts comprehensive shopping facilities which include the eagerly awaited Bond Street shopping precinct as well as a wide array of independent and chain restaurants, many bars and leisure facilities including Riverside Ice Rink. Chelmsford mainline station which has recently undergone a major refurbishment programme provides regular and fast services to London Liverpool Street.

- **First Floor Apartment**
- **Paved Balcony**
- **Allocated Carport Parking Space**
- **Living Room & Separate Dining Room**
- **Two Double Bedrooms**
- **Modern Four Piece Bathroom Suite**
- **Fitted Kitchen & Appliances**
- **Gas Central Heating & Double Glazed Windows**

£250,000

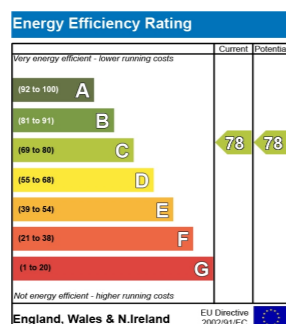

01245 500599

www.bondresidential.co.uk

f/bondresidential @bondresidential